

## LCD Color TV



### Operating Instructions \_\_\_\_\_

**GB**

- ⚠ Before operating the TV, please read the “Safety Information” section of this manual.  
Retain this manual for future reference.

**KLV-S40A10**  
**KLV-S32A10**  
**KLV-S26A10**  
**KLV-S23A10**

# BRAVIA



# Table of Contents

Safety Information .....	4
<b>Overview of the remote .....</b>	<b>9</b>
<b>Overview of the TV buttons and indicators .....</b>	<b>10</b>

## Introducing WEGA GATE

What's WEGA GATE ? .....	12
--------------------------	----

## Getting Started

1: Inserting batteries into the remote.....	14
2: Preventing the TV from toppling over....	14
3: Connecting an antenna/VCR .....	15
4: Switching on the TV .....	17
5: Selecting the language.....	17
6: Auto-programming the TV .....	18

## Watching TV

Watching TV .....	19
Viewing pictures from connected equipment .....	21

## Using WEGA GATE

Overview of WEGA GATE .....	22
Using TV List/External Inputs .....	22
Using Settings .....	22
Overview of the Settings.....	23
Picture menu .....	24
Picture Mode .....	24
Picture/Brightness/Color/Hue/Sharpness/Backlight.....	24
Color Temperature .....	25
Reset .....	25
NR (Noise Reduction).....	25
Sound menu .....	26
Sound Mode .....	26
Treble/Bass/Balance .....	26
Reset .....	26
Dual Sound.....	27
Intelligent Volume .....	27

Wide Screen menu .....	28
Auto Wide.....	28
Wide Mode .....	28
4:3 Default.....	28
Features menu .....	29
Power Saving .....	29
Light Sensor .....	29
TV Speakers .....	29
PC Adjustment .....	30
Timer menu .....	31
Sleep .....	31
Set Up menu.....	32
Auto Start Up.....	32
Language .....	32
Auto Program .....	32
Program Sorting .....	33
Program Label.....	33
AV Preset.....	33
Manual Program.....	34

## Using Optional Equipment

Connecting optional equipment .....	36
-------------------------------------	----

## Additional Information

Specifications .....	39
Troubleshooting.....	40
Index.....	43

# Safety Information

## For Safety

### AC power cord

Unplug the AC power cord when moving the LCD TV. Do not move the LCD TV with the AC power cord plugged in. It may damage the AC power cord and result in fire or electric shock. If the LCD TV has been dropped or damaged, have it checked immediately by qualified service personnel.



### Installation

Installation of the LCD TV on the wall should be carried out by qualified service personnel. Improper installation may render the LCD TV unsafe.



### Medical institution

Do not place this LCD TV in a place where medical equipment is in use. It may cause malfunction of medical instruments.

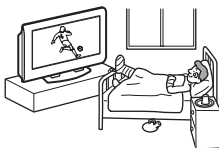

### Carrying

Carrying the LCD TV requires two or more people. If you carry the LCD TV in a manner other than that specified, it may drop and a serious injury may be caused. Be sure two or more people carry the LCD TV. When transporting, do not subject the LCD TV to shocks or excessive vibration. The LCD TV may fall and be damaged or cause serious injury.



When lifting the LCD TV or moving the LCD panel of the TV, hold it firmly by the bottom.

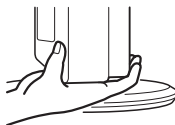

## Installation and moving

### Ventilation

Never cover the ventilation holes in the cabinet. It may cause overheating and result in fire. Unless proper ventilation is provided, the LCD TV may gather dust and get dirty. For proper ventilation, observe the following:

- Do not install the LCD TV turned backward or sideways.
- Do not install the LCD TV turned over or upside down.
- Do not install the LCD TV on a shelf or in a closet.
- Do not place the LCD TV on a rug or bed.
- Do not cover the LCD TV with cloth, such as curtains, or items such as newspapers, etc.



### Vehicle and ceiling

Do not install this LCD TV in a vehicle or hang it from the ceiling. Bumping of the vehicle may cause the LCD TV to fall down and cause injury.



### Water and moisture

Do not use this LCD TV near water - for example, near a bathtub or shower room. Also do not expose the LCD TV to rain. It may result in fire or electric shock.

### Optional accessories

When installing the LCD TV, use the supplied stand or wall-mount bracket (not supplied). If not, the LCD TV may fall and cause serious injury.



### Outdoor use

Do not install this LCD TV outdoors. If the LCD TV is exposed to rain, it may result in fire or electric shock. If the LCD TV is exposed to direct sunlight, the LCD TV may heat up and it may damage the LCD TV.

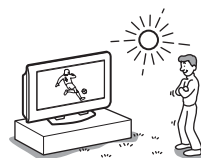

### Ship and vessel

Do not install this LCD TV in a ship or vessel. If the LCD TV is exposed to seawater, it may cause fire or damage the LCD TV.

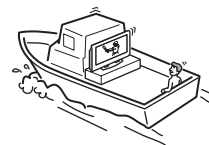

### Cord arrangement

Arrange the power cords or connecting cords in a safe place to avoid tripping on them.

### Fall

Place the LCD TV on a secure, stable stand. Do not hang anything on the LCD TV. The LCD TV may fall from the stand or wall-mount bracket (not supplied), causing damage or serious injury.



### Recommended place for the LCD TV

Place the LCD TV on a stable, level surface. Otherwise, it may fall and cause injury.



## Ventilation

Leave space around the LCD TV. Otherwise, adequate air-circulation may be blocked causing overheating and cause fire or damage the LCD TV.

### When installing the LCD TV on the wall

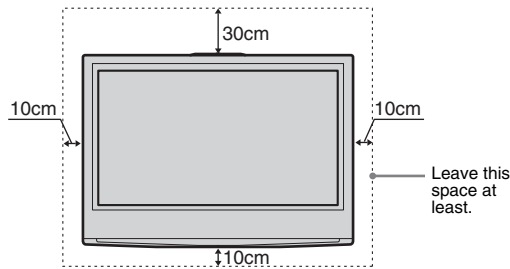

Never install the LCD TV as follows:

Air circulation is blocked.

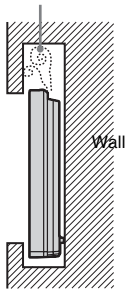

### When installing the LCD TV using a stand

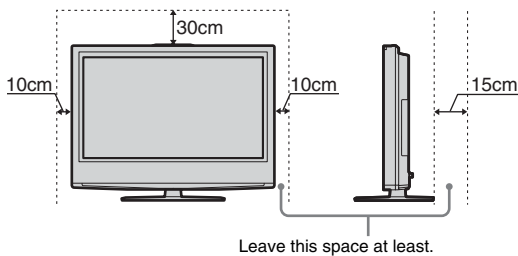

Never install the LCD TV as follows:

Air circulation is blocked.

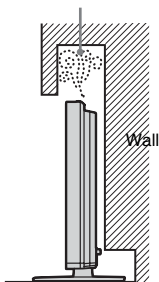

## Power Sources

### Overloading

This LCD TV is designed to operate on a 110-240V AC supply for the LCD TV. Take care not to connect too many appliances to the same AC power jack as this could result in fire or electric shock.

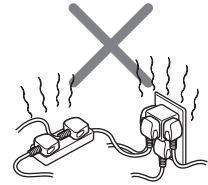

### AC power outlet

Do not use a poor fitting AC power jack. Insert the plug fully into the AC power outlet. If it is loose, it may cause arcing and result in fire. Contact your electrician to have the AC power jack changed. When you disconnect the AC power cord, disconnect it from the AC outlet first.

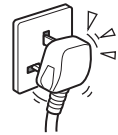

### Moisture

Do not touch the AC power cord with a wet hand. If you plug/unplug the AC power cord with a wet hand, it may cause electric shock.



### Lightning storms

For your own safety, do not touch any part of the LCD TV, AC power cord or antenna lead during lightning storms.



### AC power cord protection

Pull out the AC power cord by the plug. Do not pull on the AC power cord itself.

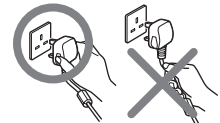

### Wiring

Unplug the AC power cord when wiring cables. Be sure to unplug the AC power cord for your safety, when hooking up.

### Cleaning

Clean the AC power plug regularly. If the plug is covered with dust and it picks up moisture, its insulation may deteriorate and result in fire. Unplug the AC power plug and clean it regularly.



### Grounding

To avoid electric shock, be sure to connect the supplied AC power cord to a grounded power outlet. If the plug fails to fit, contact your electrician to have the outlet changed.

*Continued*

## Use

### Damage requiring service

If the surface of the LCD TV cracks, do not touch it until you unplug the AC power cord. Otherwise electric shock may result.

### Servicing

Do not open the cabinet and the rear cover of the LCD TV. Refer to qualified service personnel only.



### Ventilation holes

Do not insert anything in the ventilation holes. If metal or something flammable enters, it may result in fire or electric shock.



### Moisture and flammable

- Do not let this LCD TV get wet. Never spill liquid of any kind on the set. If any liquid or solid object does fall through, do not operate the LCD TV. It may result in electric shock or damage to the LCD TV. Have it checked immediately by qualified personnel.
- Do not place any objects on the LCD TV. The LCD TV shall not be exposed to dripping or splashing and that no objects filled with liquids, such as vases, shall be placed on the LCD TV.
- To prevent fire, keep inflammable objects or naked lights (e.g. candles) away from the LCD TV.

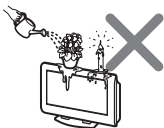

## Additional Safety Information

### Electric shock

Do not touch the LCD TV with a wet hand. Doing so may cause electric shock or damage the LCD TV.

### Protruding location

Do not install the LCD TV in protruding locations. If you install the unit in the following locations, injury may result.

- Do not install the LCD TV in a location where the LCD TV protrudes, such as pillars.
- Do not install the LCD TV in a location where your face may bump.

### Placement

Never place the LCD TV in hot, humid or excessively dusty places. Do not install the LCD TV where it may be exposed to mechanical vibrations. Do not use the LCD TV where insects may enter.

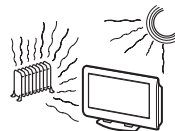

### Oils

Do not install this LCD TV in restaurants that use oil. Dust absorbing oil may enter into the LCD TV and damage the LCD TV.

### Accessories

Secure the LCD TV from falling down.

If the LCD TV is not secured properly, it may fall and cause injury. Take measures against it using the supplied stand or a wall-mount bracket (not supplied).

### Broken pieces

Do not throw anything at the LCD TV. The screen glass may explode by the impact and cause serious injury.



### Corrosion

If you use this LCD TV near the seashore, salt may corrode metal parts of the LCD TV and cause internal damage or fire. It may also shorten the life of the LCD TV. If the LCD TV will be subjected to any of these conditions, steps should be taken to reduce the humidity and temperature of the area where the LCD TV is located.

### Cleaning

Unplug the AC power cord when cleaning this LCD TV. If not, it may result in electric shock.

## AC power cord

If you damage the AC power cord, it may result in fire or electric shock.

- Do not pinch, bend, or twist the cable excessively. The core lines may be bared and cut, and cause short-circuit, resulting in fire or electric shock.
- Do not convert or damage the AC power cord.
- Do not put anything heavy on the AC power cord. Do not pull the AC power cord.
- Keep the AC power cord away from heat sources.
- Be sure to grasp the plug when disconnecting the AC power cord.

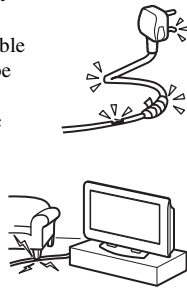

If the AC power cord is damaged, stop using it and ask your dealer or Sony service center to exchange it.

## Not in use

For environmental and safety reasons, it is recommended that the LCD TV is not left in standby mode when not in use. Disconnect it from the AC power outlet.

## Cable wiring

Take care not to catch your feet on the cables. It may damage the LCD TV.

## Installation

Do not install optional components too close to the LCD TV. Keep optional components at least 30 cm away from the LCD TV. If a VCR is installed in front or beside the LCD TV, the picture may distort.

## Heat

Do not touch the surface of the LCD TV. It remains hot, even for some time after the LCD TV is turned off.

## Precautions

### On viewing the LCD TV comfortably

- To view the LCD TV comfortably, the recommended viewing position is from four to seven times of the screen's vertical length away from the LCD TV.
- View the LCD TV in a moderate light room, as viewing the LCD TV in poor light taxes your eyes. And watching the screen continuously long times taxes your eyes, too.

### On installing the LCD TV

- Use the specified wall-mount bracket or stands.
- Do not install the display unit in places subject to extreme temperature, for example in direct sunlight, or near a radiator, or heating vent. If the display unit is exposed to extreme temperature, the display unit may heat up and it may cause deformations of the casing or malfunctions.
- Do not install the display unit in a place exposed to direct air conditioning. If the display unit is installed in such a location, moisture may condense on the panel inside the display unit. It may cause a malfunction.
- After transporting the display unit directly from a cold to a warm location, or if the room temperature has changed suddenly, pictures may be blurred or show poor color over portions of the picture. This is because moisture has condensed on the panel inside the display unit. Let the moisture evaporate before using the display unit.
- To obtain a clear picture, prevent the lighting or sun light from illuminating the screen directly. If possible, install a lighting on the ceiling right above the LCD TV so that reflection of the lighting is minimized.
- The LCD TV is not disconnected from AC power outlet when the switch is in off position. To disconnect the LCD TV completely, pull the plug from AC power outlet.

### On adjustment volume

- Adjust the volume so as not to trouble neighbors. Sound carries very easily at night time. Therefore, closing the windows or using headphones is suggested.
- When using headphones, adjust the volume so as to avoid excessive levels, as hearing damage may result.

### On handling the remote control

- Handle the remote control with care. Do not drop or step on it, or spill liquid of any kind.
- Do not place the remote control in a location near heat source, or in a place subject to direct sunlight, or in a damp room.

*Continued*

### On cleaning the cabinet

- Be sure to unplug the AC power cord connected to the LCD TV from the AC power outlet before cleaning.
- Clean the cabinet with a soft cloth lightly moistened with a mild detergent solution.
- Note that material deterioration or screen coating degradation may occur if the display unit is exposed to a volatile solvent, such as alcohol, thinner, benzine or insecticide, or if prolonged contact is maintained with rubber or vinyl materials.

### On the screen

- Although the LCD screen is made with high-precision technology and has effective pixels of 99.99% or more, black dots may appear or bright points of light (red, blue or green) may appear constantly on the LCD screen. This is a structural property of the LCD panel and is not a malfunction.
- Do not expose the LCD screen surface to the sun. Doing so may damage the screen surface.
- Do not push or scratch the front filter, or place objects on top of this unit. The image may be uneven or the LCD panel may be damaged.
- If the unit is used in a cold place, a smear may occur in the picture or the picture may become dark. This does not indicate a failure. These phenomena improve as the temperature rises.
- Ghosting may occur when still pictures are displayed continuously. It may disappear after a few moments.
- The screen and cabinet get warm when this unit is in use. This is not a malfunction.

### Fluorescent lamp

- This unit uses a special fluorescent lamp as its light source. If the screen image becomes dark, flickers, or does not appear, the fluorescent lamp has run down and should be replaced. For replacement, consult qualified service personnel.

### Disposal of Old Electrical & Electronic Equipment (Applicable in the European Union and other European countries with separate collection systems)



This symbol is on the remote control.



**The illustrations used in this manual are of the KLV-S32A10 unless otherwise stated.**



# Overview of the remote

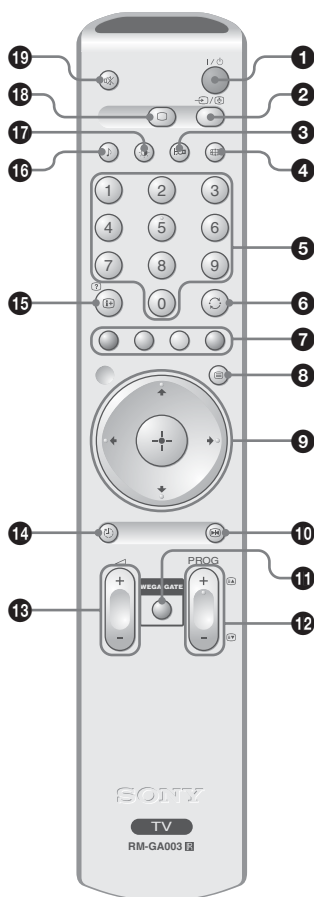

- 1** **I/⏻ – TV standby**  
Switches off the TV temporarily. The ⏻ (standby) indicator on the front of the TV lights up. Press again to switch on the TV from the standby mode.
- 2** **↔/⏻ – Input select / Text hold**
  - In TV mode (page 21): Selects the input source from equipment connected to the TV jacks.
  - In Text mode (page 20): Holds the current page.
- 3** **⏻ – Power Saving (page 29)**  
Reduces the power consumption of the TV.
- 4** **⏻ – Wide mode (page 20)**  
Selects the type of the wide mode.
- 5** **Number buttons**
  - In TV mode: Selects channels. For channel numbers 10 and above, enter the second digit within two seconds.
  - In Text mode: Enters the three digit page number to select the page.
- 6** **↶ – Previous channel**  
Returns to the previous channel watched (for more than five seconds).
- 7** **Colored buttons**  
In Text mode (page 20): Used for Fastext.
- 8** **☰ – Text (page 20)**  
Displays Text.
- 9** **↑/↓/←/→/⊕ (page 19, 22)**  
Selects the item and setting.
- 10** **⏻ – Picture Freeze (page 20)**  
Displays the frozen picture on the left screen.
- 11** **WEGA GATE (page 12)**  
Displays WEGA GATE.
- 12** **PROG +/- (page 19)**
  - In TV mode: Selects the next (+) or previous (-) channel.
  - In Text mode: Selects the next (+) or previous (-) page.

**13** **⏻ +/- – Volume**

Adjusts the TV volume.

**14** **⏻ – Sleep Timer (page 31)**

Turns on the Sleep Timer function.

**15** **⏻/? – Info / Text reveal**

- In TV mode: Displays information such as current channel number and wide mode.
- In Text mode (page 20): Reveals hidden information (e.g., answers to a quiz).

**16** **🔊 – Sound mode (page 26)**

Selects the sound mode.

**17** **☀️ – Picture mode (page 24)**

- In TV mode: Selects the picture mode.
- In Text mode: Adjusts the brightness.

**18** **⏻ – TV mode (page 21)**

Switches to a TV display when displaying external input.

**19** **🔇 – Mute (page 19)**

Mutes the sound.

**Tip**

The ↑/↓/←/→, PROG+, and number 5 buttons have tactile dots. Use the tactile dots as references when operating the TV.

# Overview of the TV buttons and indicators

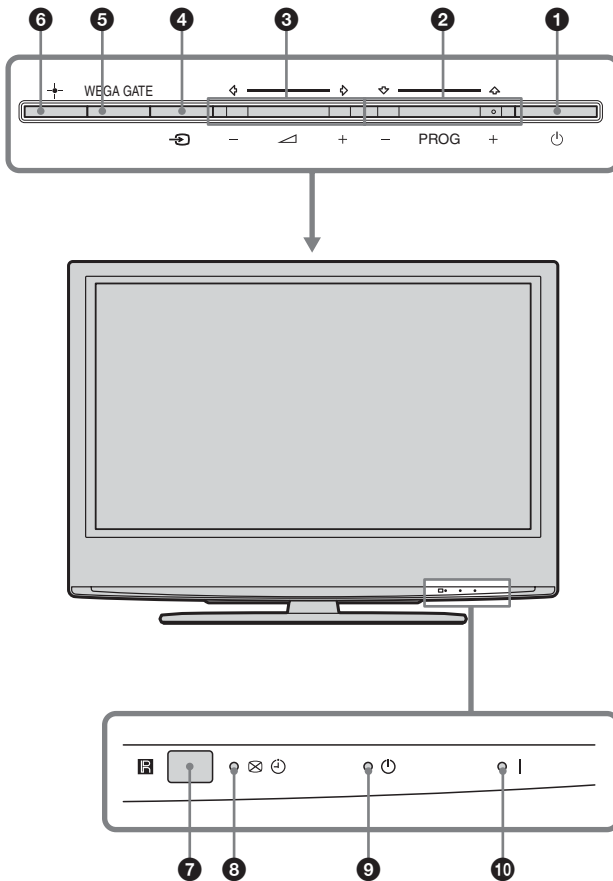

- 1** – **Power**  
 Switches the TV on or off.
- 2** **PROG +/-**   
  - In TV mode: Selects the next (+) or previous (-) channel.
  - In TV menu: Moves through the options up () or down ()
- 3**   
  - Increases (+) or decreases (-) the volume.
  - In TV menu: Moves through the options left () or right ()
- 4** – **Input select (page 21)**  
 Selects the input source from equipment connected to the TV jacks.
- 5** **WEGA GATE (page 12)**
- 6** – **(page 22)**
- 7** **Remote control sensor**
- 8** – **Picture Off/Sleep Timer indicator**  
 Lights up in green when the Picture Off is set.  
 Lights up in amber when the Sleep Timer is set.
- 9** – **Standby indicator**  
 Lights up in red when the TV is in standby mode.
- 10** **I** – **Power indicator**  
 Lights up in green when the TV is switched on.



## Introducing WEGA GATE

# What's WEGA GATE ?

WEGA GATE allows you to enjoy various convenient features of this TV. You can easily select channels or external inputs with the remote control. Also, settings for your TV can be changed easily using WEGA GATE. For more details about WEGA GATE, see “Using WEGA GATE” on page 22.



- 1** Press **WEGA GATE** on the remote.  
The **WEGA GATE** control panel appears.

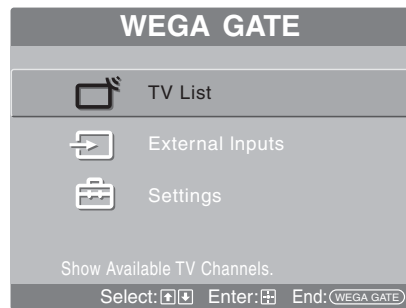

- 2** Press **↑/↓** to highlight the item you want.

- 3** Press **+** to select.

Press **WEGA GATE** to exit.

### Using TV List in WEGA GATE



The TV List feature lets you select TV programs from a list of channel labels. You can assign a label to each channel. (page 33)

- 1 Select TV List from the WEGA GATE control panel and press **+**.  
The TV List panel appears.
- 2 Press **↑/↓** to highlight the desired TV channel and press **+**.

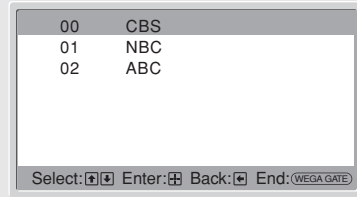

### Using External Inputs in WEGA GATE

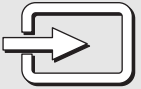

The External Inputs feature lets you select equipment that is connected to your TV, such as a DVD player/PC. You can assign a label to your equipment or skip unused inputs conveniently. (page 33)

- 1 Select External Inputs from the WEGA GATE control panel and press **+**.  
The External Inputs panel appears.
- 2 Press **↑/↓** to highlight the desired external input and press **+**.

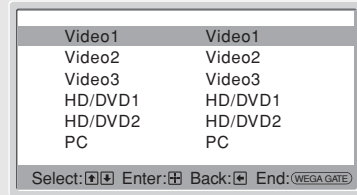

### Using Settings in WEGA GATE



The Settings feature lets you adjust/set the Picture, Sound, Wide Screen, Features, Timer or Set Up settings. For details, see page 23.

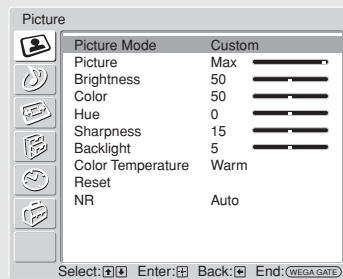

## Getting Started

### 1: Inserting batteries into the remote

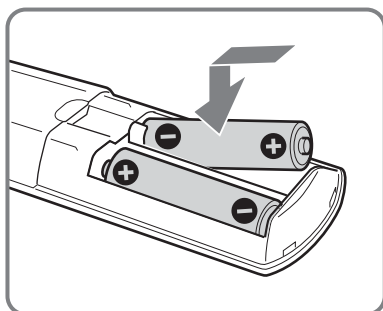
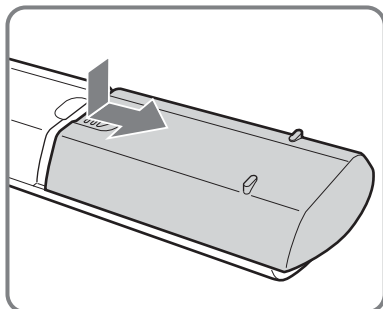

#### Notes

- Observe the correct polarity when inserting batteries.
- Dispose of batteries in an environmentally friendly way. Certain regions may regulate disposal of the battery. Please consult your local authority.
- Do not use different types of batteries together or mix old and new batteries.
- Handle the remote with care. Do not drop or step on it, or spill liquid of any kind onto it.
- Do not place the remote in a location near a heat source, or in a place subject to direct sunlight, or in a damp room.

### 2: Preventing the TV from toppling over

#### Attaching the Support Belt

- 1 Screw the support belt (supplied) to the TV stand with a wood screw (supplied).
- 2 Attach the support belt to the stand, and screw the belt with a securing screw (supplied) using a coin, etc.
- 3 Adjust the length by pulling the support belt towards you while holding the TV stand.

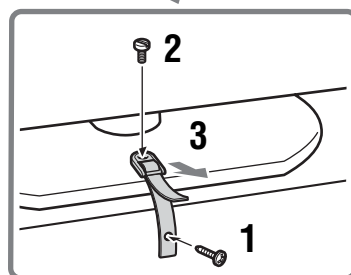
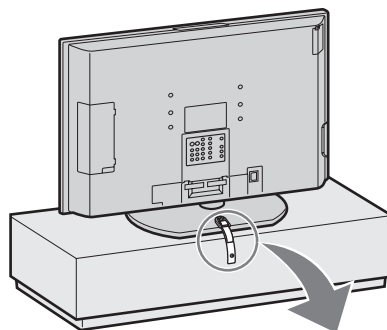

#### Notes

- Be sure to take measures to prevent the TV from toppling over and causing injury.
- The supplied wood screw may not be used depending on the type of TV stand. In this case, or when the securing strength is not enough, prepare commercial screws to fit to the TV stand. Use commercial screws of 3 to 4 mm diameter. Consult your dealer about the types of screw.

#### When Mounting on a Wall

Be sure to use the following optional wall-mount brackets to hang the TV on the wall.

KLV-S32A10/KLV-S26A10/KLV-S23A10: SU-WL31

KLV-S40A10: SU-PW2

See the Instruction Guide supplied with the wall-mount bracket on how to mount the TV on the wall.

# 3: Connecting an antenna/VCR

**A**

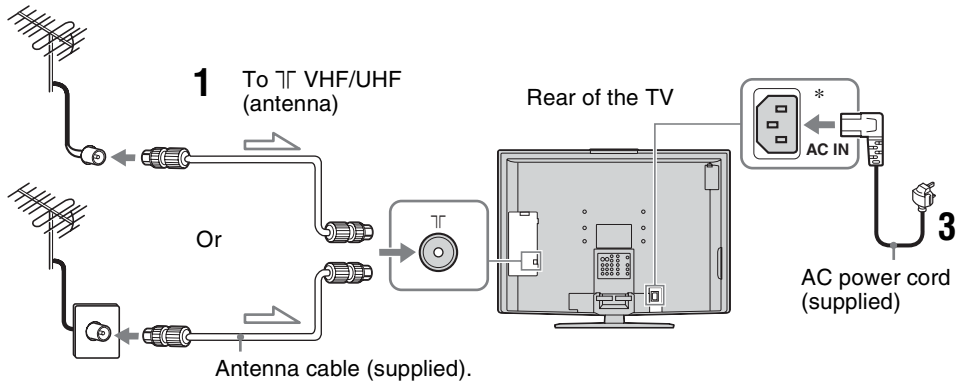

**B**

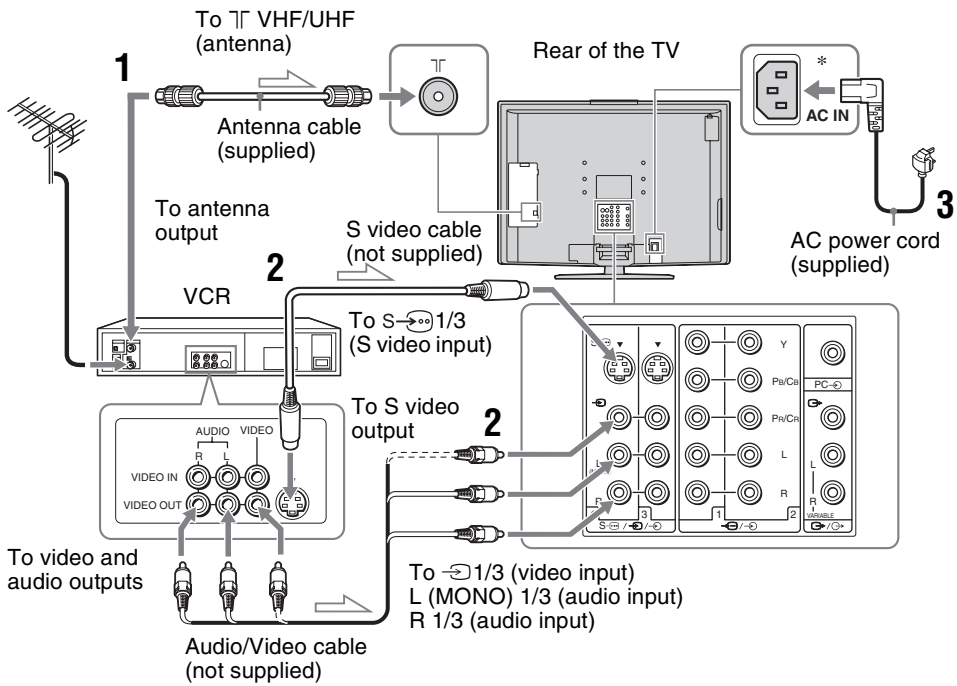

⇒ : Signal flow

\* The position of AC IN jack varies, depending on the TV size.

*Continued*

- 1 Connect your antenna with the antenna cable (supplied).

**If connecting to an antenna only (A)**

Connect the male plug to the  $\Upsilon$  VHF/UHF (antenna) jack on the rear of the TV, then go to step 3.

**Notes**

- Note that one end of the cable has a male plug fitted while the other end is fitted with a female jack.
- Do not connect the AC power cord until all other connections are complete; otherwise, a minimal current leakage through the antenna and/or other terminals to the ground could occur.

**If connecting to a VCR with an antenna (B)**

Connect your antenna to the input jack on your VCR.

**Notes**

- If you connect a monaural VCR, connect the yellow plug to  $\rightarrow$  VIDEO (the yellow jack) and the black plug to AUDIO-L (MONO) (the white jack).
- If you connect a VCR to the  $\Upsilon$  VHF/UHF (antenna) jack, preset the signal output from the VCR to the program number 0 on the TV.
- If the S video cable is connected to this TV and the VCR, the S video signal is automatically selected.

- 2 Connect your VCR.

Connect the output jack on your VCR to the input jack on the rear of the TV.

- 3 Connect the AC power cord (supplied) to the AC IN jack on the rear of the TV.

**Note**

Do not connect the AC power cord to the AC power jack until all connections are complete.

- 4 Bundle the cable.

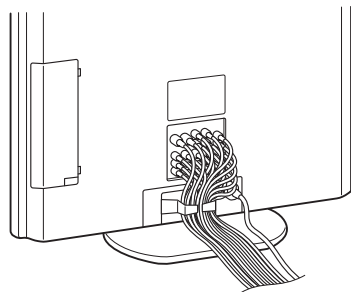

- ① Bundle the connecting cables.
- ② Route the connecting cables through the hook.

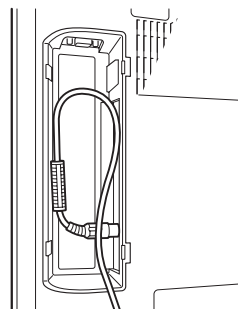

**Note**

In order to reduce the load on the antenna cable, wind it as shown.

## Adjusting the viewing angle of the TV

This TV can be adjusted within the angles shown below.

**Adjust the angle back and forth (tilt) (KLV-S26A10/KLV-S32A10 only)**

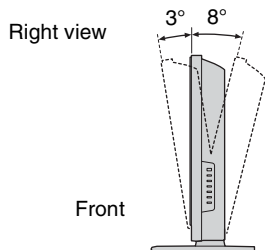

**Adjust the angle left and right (swivel)**

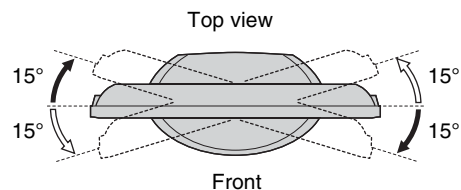

**Note**

When adjusting the angle, hold the stand with one hand to avoid slipping or tipping the stand.

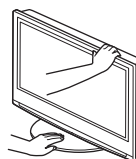



## 4: Switching on the TV

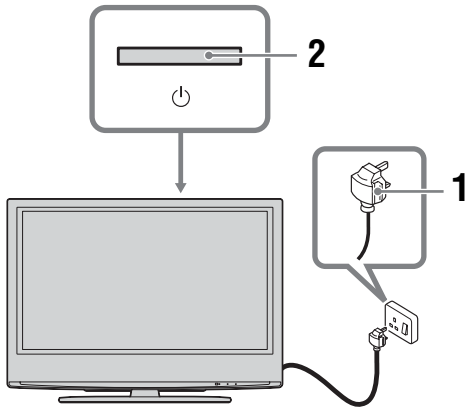

**1** Connect the TV to the AC power jack (110-240V AC, 50/60Hz).

**2** Press  on the TV (top side).

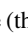
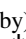

When you switch on the TV for the first time, the language menu appears on the screen, then go to “5: Selecting the language.”

When the TV is in standby mode (the  (standby) indicator on the front of the TV is red), press  on the remote to switch on the TV.

## 5: Selecting the language

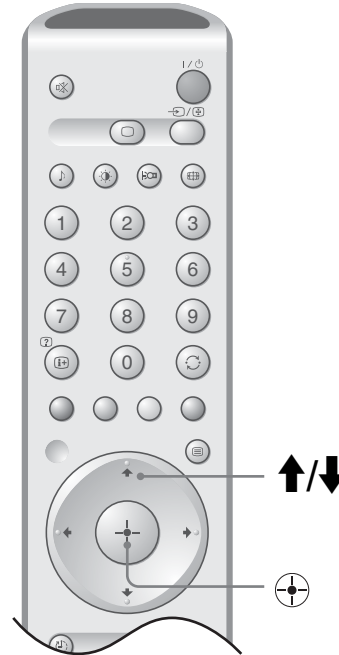
When you switch on the TV for the first time, the Language menu appears on the screen.

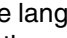

Press  to select the language displayed on the menu screens, then press .

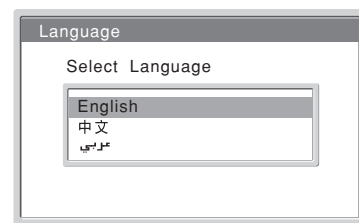

The message confirming the TV start auto program appears on the screen, then go to “6: Auto-programming the TV.”

## 6: Auto-programming the TV

After selecting the language, a message confirming the TV start auto program appears on the screen. You must tune the TV to receive channels (TV broadcasts). Do the following to search and store all available channels.

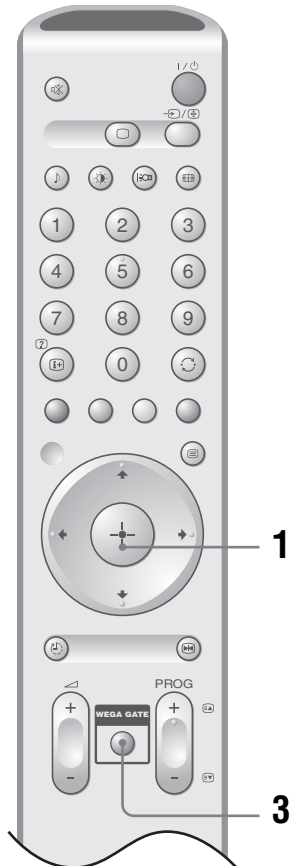

- 1 Press  $\oplus$  to select "Yes".

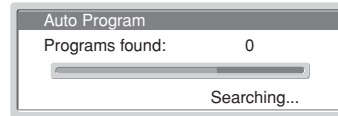
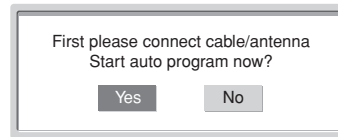

The TV starts searching for all available channels. This may take some time, please be patient and do not press any buttons on the TV or remote.

Once all available channels have been stored, the TV returns to normal operation, displaying the channel stored on channel number 1.

### When a message appears for you to confirm the antenna connections

No channels are found. Check all the antenna connections and press  $\oplus$  to start auto-program again.

- 2 The Program Sorting menu appears on the screen.
- 3 Press WEGA GATE to exit.  
The TV has now tuned in all the available channels.

### To change the order in which the channels are stored on the TV

See page 33.

# Watching TV

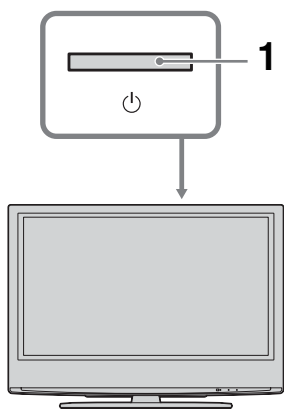

- 1 Press on the TV (top side) to switch on the TV.

When the TV is in standby mode (the (standby) indicator on the front of the TV is red), press on the remote to switch on the TV.

- 2 Press the number buttons or PROG +/- to select a TV channel.

To select channel numbers 10 and above using the number buttons, enter the second digit within two seconds.

## Additional operations

To	Do this
Turn off the TV temporarily (Standby mode)	Press .
Turn off the TV completely	Press  on the top side of the TV.
Adjust the volume	Press  + (increase) /- (decrease).
Mute the sound	Press . Press again to restore.
Return to the previous channel watched (for more than five seconds)	Press .
Access the Program index table	Press WEGA GATE, then select TV List by pressing , then press . Next, select the desired channel by pressing , then press .
Switch the TV automatically to the standby mode after a specified time period – Sleep	Press . For details, see page 31.

### Note

Even if you press the on the TV (top side) to turn it off, a small amount of current continues to flow. Pull the AC plug out of the wall jack to turn the TV off completely.

## To access Text

Press . Each time you press , the display changes cyclically as follows:

Text → Text over the TV picture (mix mode) → No Text (exit the Text service)

To select a page, press the number buttons or PROG +/-.

To hold a page, press / .

To reveal hidden information, press / .

### Tips

- You can adjust the brightness with .
- Ensure that the TV is receiving a good signal, or some text errors may occur.
- When four colored items appear at the bottom of the Text page, Fastext is available. Fastext allows you to access pages quickly and easily. Press the corresponding colored button to access the page.

## Picture Freeze

Freezes the TV picture (e.g. to make a note of a telephone number or recipe).

- 1 Press on the remote control.
- 2 Press , , , to adjust the position of the window.
- 3 Press to remove the window.
- 4 Press again to return to normal TV mode.

### Note

You cannot use WEGA GATE (page 22) when the Picture Freeze function is working.

## To change the wide mode manually

Press repeatedly to select wide mode.

### For TV, Video or DVD (other than PC Input)

#### Wide Zoom\*

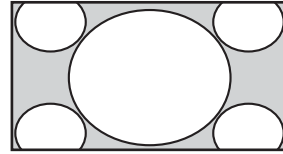

Enlarges the center portion of the picture. The left and right edges of the picture are stretched to fill the 16:9 screen.

#### Normal

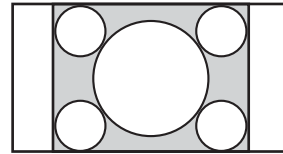

Displays the 4:3 picture in its original size. Side bars are shown to fill the 16:9 screen.

#### Note

You cannot select "Normal" when input signals are 720p/1080i.

#### Full

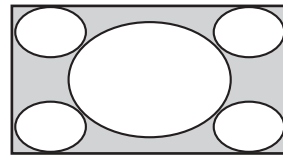

Stretches the 4:3 picture horizontally, to fill the 16:9 screen.

#### Zoom\*

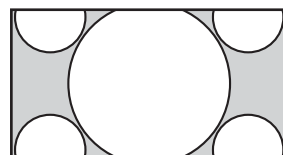

Displays cinemascopic (letter box format) broadcasts in the correct proportions.

\* Parts of the top and bottom of the picture may be cut off.

### Tips

- Alternatively, you can set "Auto Wide" to "On". The TV will automatically select the best mode to suit the broadcast (page 28).
- You can move the screen up or down with / key when you select Wide Zoom or Zoom.

## For PC Input

### Pixel x Pixel

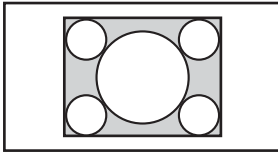

Displays the picture in its original pixel size. Bars are shown at the top, bottom, and both sides for small picture.

### Full 1

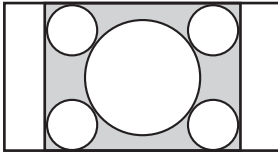

Stretches the original picture to fill the screen vertically.

### Full 2

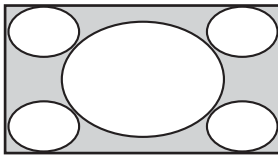

Stretches the Full 1 picture horizontally to fill the 16:9 screen.

### Note

“Out of range” appears on the screen if the pixel size of the image from the input signal is too large. For more details, see the PC input signal compatibility chart. (page 38)

# Viewing pictures from connected equipment

Switch on the connected equipment, then press  $\rightarrow$  /  $\leftarrow$  repeatedly until the correct input symbol (see below) appears on the screen.

On Screen Display	Input jacks
Video 1 $\rightarrow$ 1 or S $\rightarrow$ 1	Video : <b>1</b> (Rear) $\rightarrow$ or S $\rightarrow$ Audio : <b>1</b> (Rear) $\rightarrow$ L(MONO)/R
Video 1 S $\rightarrow$ 1	
Video 2 $\rightarrow$ 2 or Video 2 S $\rightarrow$ 2	Video : <b>2</b> (Side) $\rightarrow$ or S $\rightarrow$ Audio : <b>2</b> (Side) $\rightarrow$ L(MONO)/R
Video 2 S $\rightarrow$ 2	
Video 3 $\rightarrow$ 3 or Video 3 S $\rightarrow$ 3	Video : <b>3</b> (Rear) $\rightarrow$ or S $\rightarrow$ Audio : <b>3</b> (Rear) $\rightarrow$ L(MONO)/R
Video 3 S $\rightarrow$ 3	
HD/DVD 1 $\rightarrow$ 1	Video : <b>1</b> (Rear) $\rightarrow$ Y, Pb/Cb, Pr/Cr Audio : <b>1</b> (Rear) $\rightarrow$ L/R
HD/DVD 2 $\rightarrow$ 2	Video : <b>2</b> (Rear) $\rightarrow$ Y, Pb/Cb, Pr/Cr Audio : <b>2</b> (Rear) $\rightarrow$ L/R
PC $\rightarrow$	Video : (Rear Left Side) PC $\rightarrow$ (RGB) Audio : (Rear) PC $\rightarrow$

To return to normal TV operation, press  $\square$ .

## Using WEGA GATE

# Overview of WEGA GATE

Using WEGA GATE, you can easily perform a variety of tasks with only the **↑/↓/←/→** and **+** buttons on the remote: For example, selecting a channel/an external input, performing settings and adjustments.

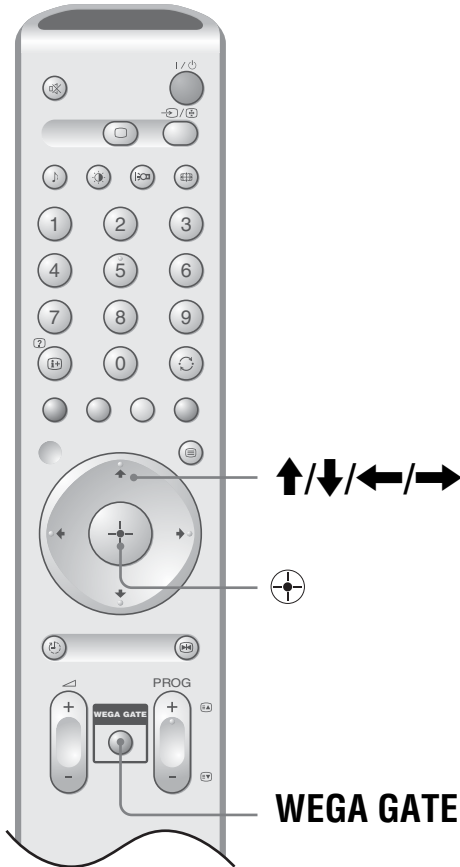

## Using TV List/External Inputs

Using TV List/External Inputs, you can select a TV program or an input connected to your TV, from a list.

- 1 Press WEGA GATE to display the WEGA GATE screen.
- 2 Press **↑/↓** to select TV List/External Inputs, then press **+**.
- 3 Press **↑/↓** to select a channel/an external input, then press **+**.  
Press WEGA GATE to exit.

## Using Settings

Using Settings, you can enter the settings screen where most of the advanced settings and adjustments are performed. See “Overview of the Settings” on page 23.

- 1 Press WEGA GATE to display the WEGA GATE screen.
- 2 Press **↑/↓** to select Settings, then press **+**.
- 3 Press **↑/↓** to select a menu icon, then press **+**.
- 4 Press **↑/↓/←/→** to select an option, then press **+**.
- 5 Press **↑/↓/←/→** to change/make the settings, then press **+**.  
Press WEGA GATE to exit.  
Press **←** to return to the last display.

## Overview of the Settings

The following options are available in each menu. Also, see page in parentheses for details of each menu.

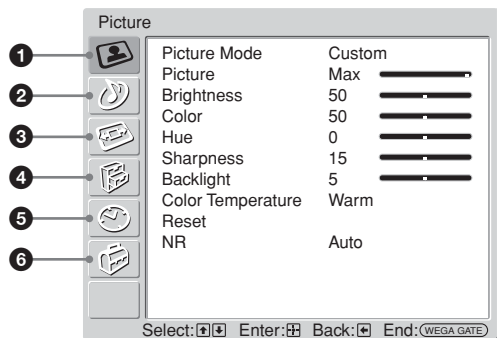

- 5 **Timer**
  - └ Sleep (31)

- 6 **Set Up**
  - └ Auto Start Up (32)
  - └ Language (32)
  - └ Auto Program (32)
  - └ Program Sorting (33)
  - └ Program Label (33)
  - └ AV Preset (33)
    - Label/Sound Offset
  - └ Manual Program (34)
    - Program/TV System/Channel/Program Label/Fine/Audio Filter/Skip/Confirm

- 1 **Picture**
  - └ Picture Mode (24)
  - └ Picture/Brightness/Color/Hue/Sharpness/Backlight (24)
  - └ Color Temperature (25)
  - └ Reset (25)
  - └ NR (25)

- 2 **Sound**
  - └ Sound Mode (26)
  - └ Treble/Bass/Balance (26)
  - └ Reset (26)
  - └ Dual Sound (27)
  - └ Intelligent Volume (27)

- 3 **Wide Screen**
  - └ Auto Wide (28)
  - └ Wide Mode (28)
  - └ 4:3 Default (28)

- 4 **Features**
  - └ Power Saving (29)
  - └ Light Sensor (29)
  - └ TV Speakers (29)
  - └ PC Adjustment (30)

# Picture menu

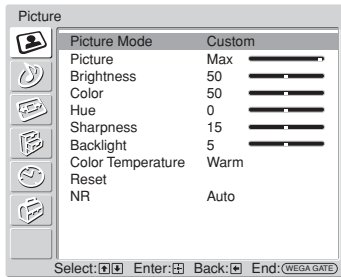

You can select the options listed below on the Picture menu. To select options, see “Using WEGA GATE” (page 22).

## Tip

When you set the “Picture Mode” option to “Vivid” or “Standard”, you can adjust only “Picture”, “Backlight”, “Color Temperature (Cool/Neutral)”, “Reset” and “NR”.

## Picture Mode

Selects the picture mode.

- 1 Press  $\oplus$  to select “Picture Mode”.
- 2 Press  $\uparrow/\downarrow$  to select one of the following picture modes, then press  $\oplus$ .

Vivid: For bright wide spaces.

Standard: Optimal picture for home use.

Custom: Allows you to store your own preferred settings.

## Note

You cannot adjust “Brightness”, “Color”, “Hue”, and “Sharpness” when you select “Vivid” or “Standard” in “Picture Mode”.

## Tip

You can also change the picture mode by pressing  $\odot$  repeatedly.

## Picture/Brightness/Color/Hue/Sharpness/Backlight

“Picture” increases picture contrast (the color becomes deeper), or decreases it (the color becomes softer).

“Brightness” brightens or darkens the picture.

“Color” increases or decreases color intensity.

“Hue” increases or decreases the green tone.

“Sharpness” sharpens or softens the picture.

“Backlight” brightens or darkens the backlight.

- 1 Press  $\oplus$  to select the option.
- 2 Press  $\leftarrow/\rightarrow$  to set the level, then press  $\oplus$ .

## Tip

“Hue” can only be adjusted for an NTSC color signal (e.g., U.S.A. video tapes).



## Color Temperature

- 1 Press  $\oplus$  to select “Color Temperature”.
- 2 Press  $\uparrow/\downarrow$  to select one of the following, then press  $\oplus$ .  
Cool: Gives the white colors a blue tint.  
Neutral: Gives the white colors a neutral tint.  
Warm: Gives the white colors a red tint.

**Tip**

“Warm” only appears and can be adjusted if “Picture Mode” is set to “Custom”.

## Reset

Resets all the picture settings to the factory settings.

- 1 Press  $\oplus$  to select “Reset”.
- 2 Press  $\uparrow/\downarrow$  to select “OK”, then press  $\oplus$ .

## NR (Noise Reduction)

Reduces the picture noise (snowy picture) in a weak broadcast signal.

Press  $\oplus$  to select one of the following NR settings.

Auto: Automatically reduces the picture noise.

Off: Turns off the noise reduction feature.

**Tip**

This option cannot be used for an input signal from the Y, PB/Cb, PR/Cr jacks of  $\rightarrow \dots$ .

# Sound menu

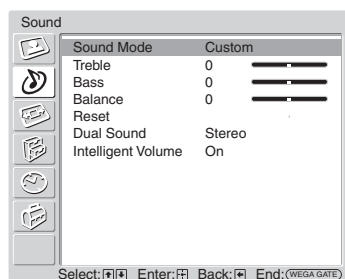

You can select the options listed below on the Sound menu. To select options, see “Using WEGA GATE” (page 22).

## Sound Mode

- 1 Press **+** to select “Sound Mode”.
- 2 Press **↑/↓** to select one of the following sound modes, then press **+**.  
Dynamic: Intensifies clarity and sound presence for better intelligibility and musical realism by using the “BBE High definition Sound System”.  
Standard: Enhances clarity, detail, and sound presence by using “BBE High definition Sound System”<sup>\*1</sup>.  
TruSurround<sup>\*2</sup>: Uses the TV speakers to simulate the surround effect produced by a multi channel system.  
Custom: You can adjust settings as you want.

### Tips

- You can also change sound mode by pressing **↓** repeatedly.
- If you set “Intelligent Volume” to “On”, “TruSurround” automatically changes to “Standard”.

<sup>\*1</sup> Licensed by BBE Sound, Inc. under USP4638258, 4482866. “BBE” and BBE symbol are trademarks of BBE Sound, Inc.

<sup>\*2</sup> TruSurround, SRS and the **(●)** symbol are trademarks of SRS Labs, Inc. TruSurround technology is incorporated under license from SRS Labs, Inc.

## Treble/Bass/Balance

Adjusts higher-pitched sounds (Treble), adjusts lower-pitched sounds (Bass), and emphasizes left or right speaker balance (Balance).

- 1 Press **+** to select the option.
- 2 Press **←/→** to set the level, then press **+**.

### Note

You can adjust “Treble” and “Bass” when “Sound Mode” is set to “Custom”.

## Reset

Resets the “Treble”, “Bass” and “Balance” settings to the factory settings.

- 1 Press **+** to select “Reset”.
- 2 Press **↑/↓** to select “OK”, then press **+**.

## Dual Sound

Selects the sound of NICAM or A2 (German) stereo system.

- 1 Press  $\oplus$  to select “Dual Sound”.
- 2 Press  $\uparrow/\downarrow$  to select one of the following, then press  $\oplus$ .  
The selection varies, depending on the Broadcasting.

Broadcasting	Selection
NICAM stereo	NICAM (stereo sound) Mono (regular sound)
NICAM bilingual	NICAM Main (main sound) NICAM Sub (sub sound) Mono (regular sound)
NICAM monaural	NICAM Main (main sound) Mono (regular sound)
A2 (German) stereo	Mono (regular sound) Stereo (stereo sound)
A2 (German) bilingual	Main (main sound) Sub (sub sound)

### Notes

- If the signal is very weak, the sound becomes monaural automatically.
- If the stereo sound is noisy when receiving a NICAM program, select “Mono”. The sound becomes monaural, but the noise is reduced.
- The “Mono” setting is memorized for each program position.
- You cannot receive a stereo broadcast signal when “Mono” is selected for the program position.
- You cannot receive stereo or dual sound when “Low” or “High” is selected in “Audio Filter”.

### Tips

- NICAM is receivable in following countries/regions. Hong Kong, Singapore, New Zealand, Malaysia, Thailand, etc.
- A2 (German) is receivable in following countries/regions. Australia, Malaysia, Thailand, etc.
- If you select other equipment connected to the TV, set “Dual Sound” to “Stereo”, “A” or “B”.

## Intelligent Volume

Keeps a constant volume level even when volume level gaps occur (e.g., adverts tend to be louder than programs).

- 1 Press  $\oplus$  to select “Intelligent Volume”.
- 2 Press  $\uparrow/\downarrow$  to select “On”, then press  $\oplus$ .

# Wide Screen menu

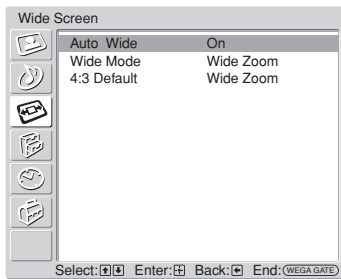

You can select the options listed below on the Wide Screen menu. To select options, see “Using WEGA GATE” (page 22).

## Auto Wide

Automatically changes the screen format according to the broadcast signal.

- 1 Press  $\oplus$  to select “Auto Wide”.
- 2 Press  $\uparrow/\downarrow$  to select “On”, then press  $\oplus$ .  
To keep your setting, select “Off”.

### Tip

Even if you have selected “On” or “Off” in “Auto Wide”, you can always modify the format of the screen by pressing  $\oplus$  repeatedly.

## Wide Mode

For details about the wide mode, see page 20.

- 1 Press  $\oplus$  to select “Wide Mode”.
- 2 Press  $\uparrow/\downarrow$  to select the desired setting (see page 20, 21 for details), then press  $\oplus$ .

## 4:3 Default

Displays a 4:3 picture in “Wide Zoom” (factory setting) or in “Normal” mode.

- 1 Press  $\oplus$  to select “4:3 Default”.
- 2 Press  $\uparrow/\downarrow$  to select “Wide Zoom” or “Normal” then press  $\oplus$ .

# Features menu

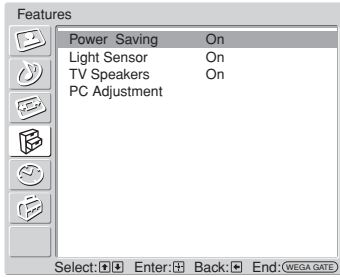

You can select the options listed below on the Features menu. To select options, see “Using WEGA GATE” (page 22).

## Power Saving

Reduces the power consumption of the TV.

- 1 Press  $\oplus$  to select “Power Saving”.
- 2 Press  $\uparrow/\downarrow$  to select “On” or “Picture Off”, then press  $\oplus$ .

### Note

The picture will disappear when you move the focus to “Picture Off”. Press  $\oplus$  to cancel “Picture Off”.

## Light Sensor

Automatically optimizes the picture settings according to the ambient light in the room.

- 1 Press  $\oplus$  to select “Light Sensor”.
- 2 Press  $\uparrow/\downarrow$  to select “On” then press  $\oplus$ .

## TV Speakers

Turns off the TV speakers e.g. to listen to the sound through external audio equipment connected to the TV.

- 1 Press  $\oplus$  to select “TV Speakers”.
- 2 Press  $\uparrow/\downarrow$  to select one of the following, then press  $\oplus$ .

On: the sound is output from the TV speakers.

One Time Off: the TV speakers are temporarily turned off allowing you to listen to the sound from external audio equipment. The “TV speakers” option automatically returns to “On” when the TV set is switched off.

Permanent Off: the TV speakers are permanently turned off allowing you to listen to the sound from external audio equipment.



### Tip

To turn on the TV speakers again, change to on.

## PC Adjustment

Customizes the TV screen as a PC monitor. This item is displayed only when you select PC  as an input source.

**1** Press  to select “PC Adjustment”.

**2** Press  to select one of the following, then press .

Phase: Adjusts the screen when a part of a displayed text or image is not clear.

Pitch: Enlarges or shrinks the screen size horizontally when a part of a displayed text or image is not clear.

H Center: Moves the screen to the left or to the right.

V Center: Moves the screen up or down.

Power saving: Turns to the TV standby mode if no PC signal is received.

Reset: Resets to the factory settings.

# Timer menu

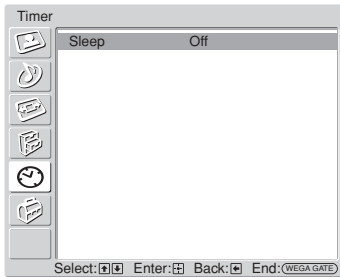

You can select the options listed below on the Timer menu. To select options, see “Using WEGA GATE” (page 22).

## Sleep

Sets a period of time after which the TV automatically switches itself into standby mode.

- 1 Press **+** to select “Sleep”.
- 2 Press **↑/↓** to select the desired time period (“30min”/“60min”/“90min”/“120min”), then press **+**.

The **⊗** (Picture Off/Sleep Timer) indicator on the TV (front) lights up in amber.

### Tips

- You can set the sleep timer by pressing **+** repeatedly.
- If you switch off the TV and switch it on again, “Sleep” is reset to “Off”.
- “TV will turn off soon” appears on the screen one minute before the TV switches to standby mode.
- If you press **+**/**?**, the remaining time in minutes before the TV switches to standby mode is displayed on the screen.

# Set Up menu

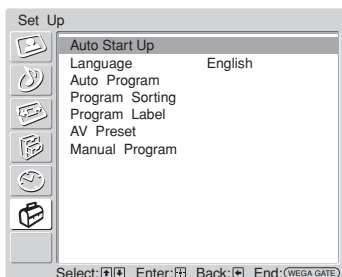

You can select the options listed below on the Set Up menu. To select options, see “Using WEGA GATE” (page 22).

## Auto Start Up

Starts the “first time operation menu” to tune in all the available channels. Usually you do not need to do this operation because the channels are already tuned when the TV was first installed (page 18). However, this option allows you to repeat the process (e.g., to retune the TV after moving house, or to search for new channels that have been launched by broadcasters).

- 1 Press  $\oplus$  to select “Auto Start Up”.
- 2 Press  $\uparrow/\downarrow$  to select the language, then press  $\oplus$ .
- 3 Press  $\oplus$  to select “Yes”.  
The auto-program display appears on the screen.
- 4 Follow steps 1 to 3 of “6: Auto-programming the TV” (page 18).

## Language

Selects the language in which the menus are displayed.

- 1 Press  $\oplus$  to select “Language”.
- 2 Press  $\uparrow/\downarrow$  to select the language, then press  $\oplus$ .  
All menus will appear in the selected language.

## Auto Program

Tunes in all the available channels.

Usually you do not need to do this operation because the channels are already tuned when the TV was first installed (page 18). However, this option allows you to repeat the process (e.g., to retune the TV after moving house, or to search for new channels that have been launched by broadcasters).

- 1 Press  $\oplus$  to select “Auto Program”.
- 2 Follow step 1 of “6: Auto-programming the TV” (page 18).  
When all available channels have been tuned, the TV returns to normal operation.



## Program Sorting

Changes the order in which the channels are stored on the TV.

- 1 Press  $\oplus$  to select “Program Sorting”.
- 2 Press  $\uparrow/\downarrow$  to select the channel you want to move to a new position, then press  $\oplus$ .
- 3 Press  $\uparrow/\downarrow$  to select the new position for the channel, then press  $\oplus$ .  
Repeat the procedure in steps 2 and 3 to move other channels if required.

## Program Label

Assigns a channel name of your choice up to five letters or numbers. The name will be displayed briefly on the screen when the channel is selected.

- 1 Press  $\oplus$  to select “Program Label”.
- 2 Press  $\uparrow/\downarrow$  to select the channel you want to name, then press  $\oplus$ .
- 3 Press  $\uparrow/\downarrow/\leftarrow/\rightarrow$  to select the desired letter or number (“□” for a blank space), then press  $\oplus$ .  
**If you input a wrong character**  
Press  $\uparrow/\downarrow/\leftarrow/\rightarrow$  to select  $\square/\square$  and press  $\oplus$  repeatedly until the wrong character is selected. Then, press  $\uparrow/\downarrow/\leftarrow/\rightarrow$  to select the correct character and press  $\oplus$ .
- 4 Repeat the procedure in step 3 until the name is complete.
- 5 Press  $\uparrow/\downarrow/\leftarrow/\rightarrow$  to select “End”, then press  $\oplus$ .

## AV Preset

Do the following options.

- 1 Press  $\oplus$  to select “AV Preset”.
- 2 Press  $\uparrow/\downarrow$  to select the desired input source, then press  $\oplus$ .
- 3 Press  $\leftarrow/\rightarrow$  to select the desired option below, then press  $\oplus$ .

Option	Description
Label	<p>Assigns a name to any equipment connected to the side or rear jacks. The name will be displayed briefly on the screen when the equipment is selected.</p> <p>Press <math>\uparrow/\downarrow</math> to select one of the following, then press <math>\oplus</math>. Video1/Video2/Video3/HD/DVD1/HD/DVD2/PC: Uses one of these preset labels.</p> <p>Edit: Creates your own label. Follow steps 3 to 5 of “Program Label” (page 33).</p> <p>Skip: Skips an input source that is not connected to any equipment when you press <math>\rightarrow/\leftarrow</math> to select the input source. After selecting this option, press <math>\oplus</math>.</p> <p><b>Note</b> You cannot change the PC label.</p>

*Continued*

Option	Description
<b>Sound Offset</b>	Sets an independent volume level to each equipment connected to the TV. Press <b>→</b> , to select “Sound Offset”, then press <b>⊕</b> . Press <b>↑/↓</b> to select the desired volume level.

## Manual Program

Before selecting “Program Label”/“Fine”/“Audio Filter”/“Skip”, press **PROG +/-** to select the program number with the channel. You cannot select a program number that is set to skip (page 35).

- 1** Press **⊕** to select “Manual Program”.
- 2** Press **↑/↓** to select one of the following options, then press **⊕**.

Option	Description
<b>Program</b>	Presets program channels manually.
<b>TV System</b>	<b>1</b> Press <b>↑/↓</b> to select “Program”, then press <b>⊕</b> .
<b>Channel</b>	<p><b>2</b> Press <b>↑/↓</b> to select the program number you want to manually tune in (if tuning in a VCR, select channel 0), then press <b>←</b>.</p> <p><b>Tip</b> You can also select the program number with the <b>PROG +/-</b> or number buttons.</p> <p><b>3</b> Press <b>↑/↓</b> to select “Channel”, then press <b>⊕</b>.</p> <p><b>4</b> Press <b>↑/↓</b> until the desired channel’s broadcast image appears on the TV screen, then press <b>⊕</b>. When the sound of the desired channel is abnormal, proceed to step 5. When the sound is normal, proceed to step 7.</p> <p><b>Tip</b> The TV will look for receivable channels automatically after you press <b>↑</b> or <b>↓</b>.</p> <p><b>5</b> Press <b>↑/↓</b> to select “TV System”, then press <b>⊕</b>.</p> <p><b>6</b> Press <b>↑/↓</b> to select the best received TV broadcast systems, then press <b>⊕</b>. The focus moves to “Confirm” automatically.</p> <p><b>7</b> Press <b>⊕</b>. The focus moves to “OK” automatically.</p> <p><b>8</b> Press <b>⊕</b>. Repeat the procedure above to preset other channels manually.</p>
<b>Program Label</b>	<p>Assigns a name of your choice, up to five letters or numbers, to the selected channel. This name will be displayed briefly on the screen when the channel is selected.</p> <p><b>1</b> Follow steps 3 to 5 of “Program Label” (page 33).</p> <p><b>2</b> Press <b>⊕</b>. The focus moves to “Confirm” automatically.</p> <p><b>3</b> Press <b>⊕</b>. The focus moves to “OK” automatically.</p> <p><b>4</b> Press <b>⊕</b>.</p>

Option	Description
<b>Fine</b>	<p>Fine-tunes the selected program number manually if you feel that a slight tuning adjustment will improve the picture quality. (Normally, fine tuning is performed automatically.)</p> <ol style="list-style-type: none"> <li><b>1</b> Press <b>↑/↓</b> to adjust the fine tuning over a range of -15 to +15, then press <b>⊕</b>. The focus moves to “Confirm” automatically.</li> <li><b>2</b> Press <b>⊕</b>. The focus moves to “OK” automatically.</li> <li><b>3</b> Press <b>⊕</b>. To restore automatic fine tuning, select “Auto” in step 1.</li> </ol>
<b>Audio Filter</b>	<p>Improves the sound for individual channels in the case of distortion in mono broadcasts. Sometimes a non-standard broadcast signal can cause sound distortion or intermittent sound muting when watching mono programs.</p> <ol style="list-style-type: none"> <li><b>1</b> Press <b>↑/↓</b> to select “Low” or “High”, then press <b>⊕</b>. The focus moves to “Confirm” automatically. If you do not experience any sound distortion, we recommend that you leave this option set to the factory setting “Off”.</li> <li><b>2</b> Press <b>⊕</b>. The focus moves to “OK” automatically.</li> <li><b>3</b> Press <b>⊕</b>.</li> </ol> <p><b>Note</b> You cannot receive stereo or dual sound when “Low” or “High” is selected.</p>
<b>Skip</b>	<p>Skips unused channels when you press PROG +/- to select channels. (You can still select a skipped channel using the number buttons.)</p> <ol style="list-style-type: none"> <li><b>1</b> Press <b>↑/↓</b> to select “On”, then press <b>⊕</b>. The focus moves to “Confirm” automatically.</li> <li><b>2</b> Press <b>⊕</b>. The focus moves to “OK” automatically.</li> <li><b>3</b> Press <b>⊕</b>. To restore a skipped channel, select “No” in step 1.</li> </ol>

# Connecting optional equipment

You can connect a wide range of optional equipment to your TV. Connecting cables are not supplied. Connect the cables, matching the colors of the plugs with those of the jack.

## Connecting to the side/rear of the TV

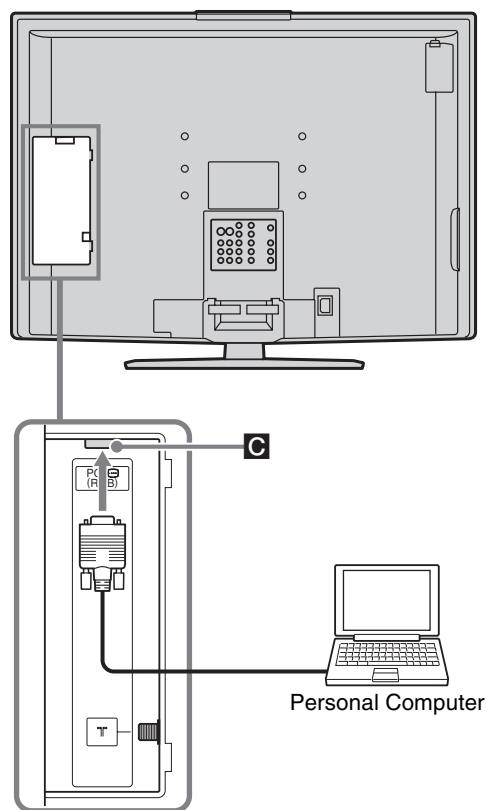
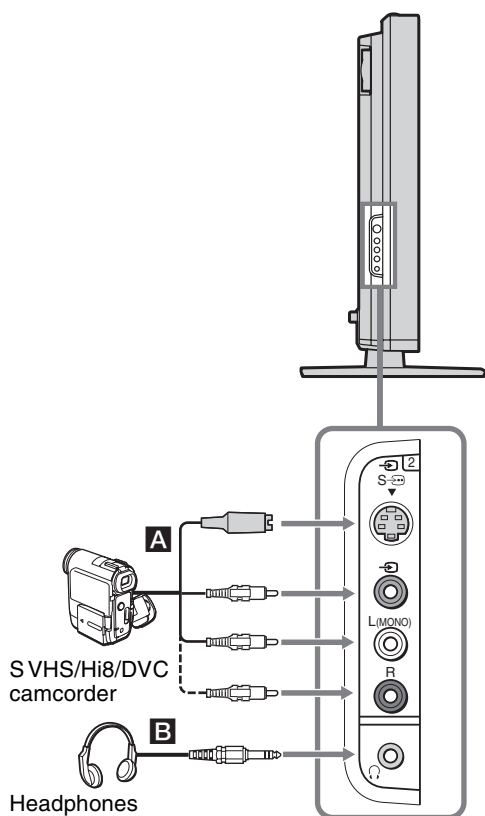



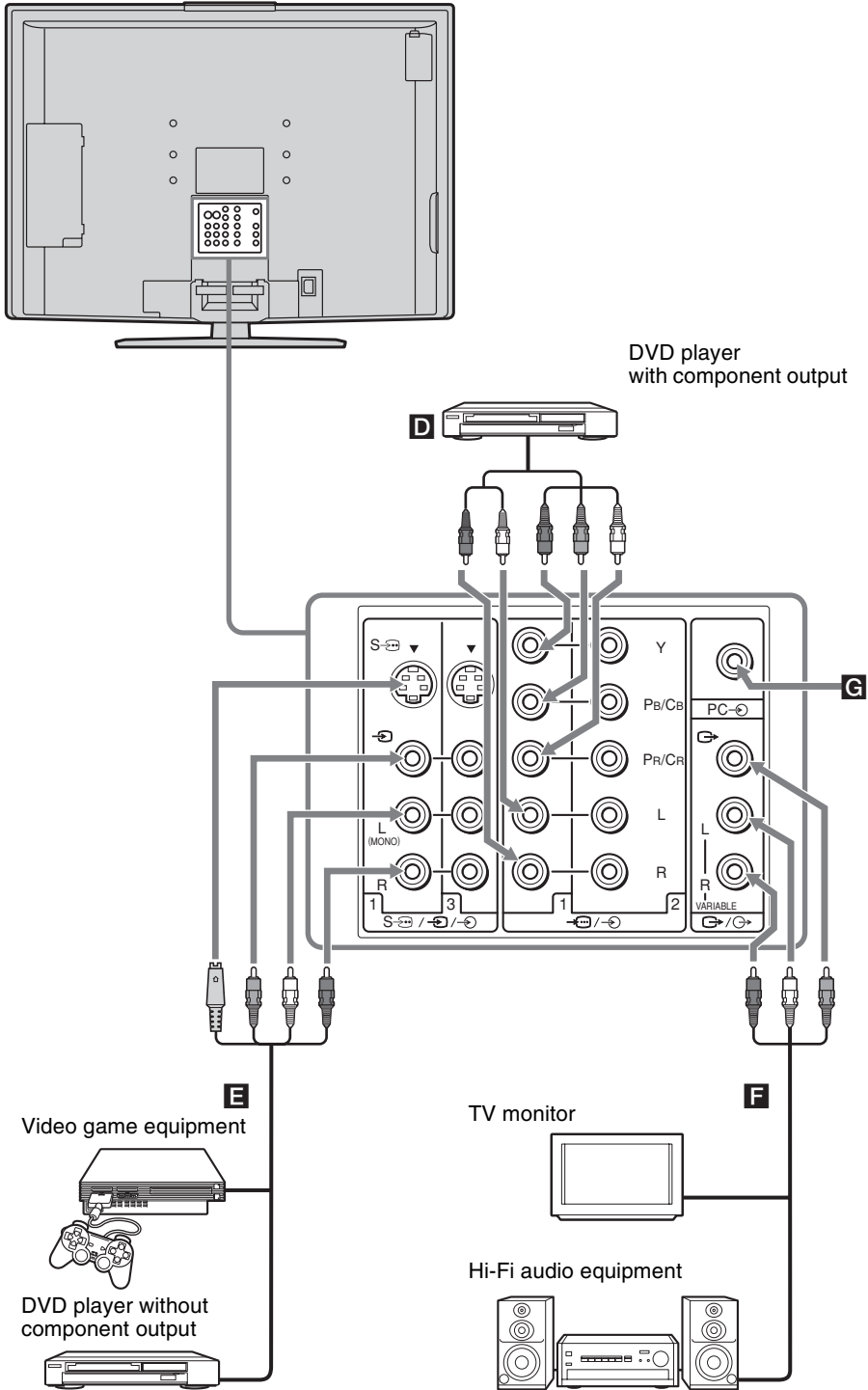

To connect	Do this
S VHS/Hi8/DVC camcorder or video game equipment <b>A</b>	Connect to the S video jack S $\rightarrow$ 2 or the video jack $\rightarrow$ 2, and the audio jacks $\rightarrow$ 2. To avoid picture noise, do not connect the camcorder to the video jack $\rightarrow$ 2 and the S video jack S $\rightarrow$ 2 at the same time. If you connect mono equipment, connect to the L(MONO) jack $\rightarrow$ 2.
Headphones <b>B</b>	Connect to the $\rightarrow$ jack to listen to sound from the TV on headphones.

To connect	Do this
Personal Computer <b>C</b>	Connect to the PC Input jack PC $\rightarrow$ (R, G, B) and the audio jack <b>C</b> PC $\rightarrow$ on the rear of the TV (page 37).

## Connecting to the rear of the TV

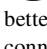
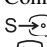
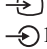
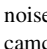
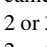
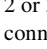
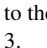

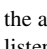
*Continued*

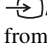
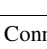
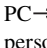
To connect	Do this
DVD player with component output <b>D</b>	Connect to the component jack  and the audio jacks  . For better picture quality, component connection is recommended if your DVD player has a component output.
Video game equipment or DVD player without component output <b>E</b>	Connect to the S video jack  1, 2 or 3 or the video jack  1, 2 or 3, and the audio jacks  1, 2 or 3. To avoid picture noise, do not connect the camcorder to the video jack  1, 2 or 3 and the S video jack  1, 2 or 3 at the same time. If you connect mono equipment, connect to the L (MONO) jack  1, 2 or 3.
TV monitor and Hi-Fi audio equipment <b>F</b>	Connect to the video output jacks  to watch the image from the TV on another monitor. Connect to the audio output jacks  to listen to the sound on the Hi-Fi audio equipment. When you select HD/DVD1, HD/DVD2, or PC input by operating  /  , the TV signal is output from the  jack.
PC AUDIO IN <b>G</b>	Connect to the PC input jack  to listen to sound from the personal computer.

### Note

If the sound volume of the TV is changed during the recording, the change in volume will be reflected in the recording when you connect the recording component to **F**.

### PC input signal compatibility chart

Signal	Resolution Horizontal (Pixel) x Vertical (Line)	Horizontal frequency (kHz)	Vertical frequency (Hz)	Standard
VGA	640 × 480	31.5	<b>60</b>	VGA
	640 × 480	37.9	72	VESA
	640 × 480	37.5	75	VESA
	720 × 400	31.47	70	VGA-T
SVGA	800 × 600	35.1	56	VESA Guidelines
	800 × 600	37.9	<b>60</b>	VESA Guidelines
	800 × 600	48.1	72	VESA
	800 × 600	46.9	75	VESA
XGA	1024 × 768	48.4	<b>60</b>	VESA Guidelines
	1024 × 768	56.5	70	VESA
	1024 × 768	60.0	75	VESA
WXGA	1280 × 768	47.40	<b>60</b>	VESA
	1280 × 768	47.78	<b>60</b>	VESA

### Tips

- This TV does not support Sync on Green or Composite Sync.
- If a signal other than in the above chart is input, it may not be displayed properly or may not be displayed as you set.
- Using the Vertical frequency (Hz) of the personal computer at 60 is recommended.

# Specifications

## Display Unit

Power Requirements:

110–240 V AC, 50/60 Hz

Screen Size:

KLV-S40A10: 40 inches

KLV-S32A10: 32 inches

KLV-S26A10: 26 inches

KLV-S23A10: 23 inches

Display Resolution (horizontal × vertical):

1366 pixels × 768 lines

Power Consumption:

KLV-S40A10: 260 W

KLV-S32A10: 170 W

KLV-S26A10: 110 W

KLV-S23A10: 95 W

Standby Power Consumption:

KLV-S40A10: 0.6 W

KLV-S32A10: 0.5 W

KLV-S26A10: 0.5 W

KLV-S23A10: 0.5 W

Dimensions (w × h × d):

KLV-S40A10:

Approx. 999 × 740 × 370 mm (with stand)

Approx. 999 × 693 × 103 mm (without stand)

KLV-S32A10:

Approx. 792 × 608 × 309 mm (with stand)

Approx. 792 × 564 × 99 mm (without stand)

KLV-S26A10:

Approx. 658 × 517 × 309 mm (with stand)

Approx. 658 × 474 × 90 mm (without stand)

KLV-S23A10:

Approx. 566 × 448 × 218 mm (with stand)

Approx. 566 × 411 × 89 mm (without stand)

Weight:

KLV-S40A10:

Approx. 33 kg (with stand)

Approx. 26.5 kg (without stand)

KLV-S32A10:

Approx. 20.5 kg (with stand)

Approx. 16.7 kg (without stand)

KLV-S26A10:

Approx. 16.9 kg (with stand)

Approx. 12.8 kg (without stand)

KLV-S23A10:

Approx. 12.7 kg (with stand)

Approx. 9.1 kg (without stand)

## Panel System

LCD (Liquid Crystal Display) Panel

## TV System

I, D/K, B/G, M

## Color System

PAL, PAL60, SECAM, NTSC 4.43, NTSC 3.58

## Antenna

75 ohm external terminal

## Channel Coverage

B/G

VHF:E2 to E12 / UHF: E21 to E69 /

CATV:S01 to S03, S1 to S41

VHF:0 to 12,5A, 19A / UHF: 28 to 69 /

CATV:S01 to S03, S1 to S41(Australia only)

VHF:1 to 11 / UHF: 21 to 69 /

CATV:S01 to S03, S1 to S41(New Zealand only)

I

UHF: B21 to B68 / CATV:S01 to S03, S1 to S41

D/K

VHF: C1 to C12 / UHF: C13 to C57, R21 to R60 /



CATV:S01 to S03, S1 to S41, Z1 to Z39

M

VHF:A2 to A13 / UHF: A14 to A79 /

CATV:A-8 to A-2, A to W+4, W+6 to W+84

## Terminals

VIDEO IN1/2/3: S-/

S VIDEO (4-pin mini DIN):S-

Y:1.0 Vp-p, 75 ohms unbalanced, sync negative

C:0.286 Vp-p (Burst signal), 75 ohms

VIDEO: 

1 Vp-p, 75 ohms unbalanced, sync negative

AUDIO: 

500 mVrms

Impedance: 47 kilohms

HD/DVD IN 1/2: 

YPbPr (Component Video) :

Y : 1.0 Vp-p, 75 ohms unbalanced, sync negative

Pb : 0.7 Vp-p, 75 ohms

Pr : 0.7 Vp-p, 75 ohms

Signal format : 480i, 576i, 480p, 576p, 720p, 1080i

AUDIO: 

500 mVrms

Impedance: 47 kilohms

VIDEO OUT: 

VIDEO: 

1 Vp-p, 75 ohms unbalanced, sync negative

AUDIO: 

More than 1 Vrms at the maximum volume setting

(Variable)

PC : 

D-sub 15-pin, analogue RGB, 0.7 Vp-p,

75 ohms, positive

See the PC Input Signal Compatibility Chart on page 38

AUDIO : 

Stereo minijack, 0.5 Vrms, 1 kilohm

Headphones 

Stereo minijack

## Sound Output

KLV-S40A10: 10 W + 10 W

KLV-S32A10: 10 W + 10 W

KLV-S26A10: 10 W + 10 W

KLV-S23A10: 5 W + 5 W

Design and specifications are subject to change without notice.

# Troubleshooting

Check whether the  (standby) indicator is flashing in red.

## When it is flashing



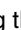
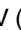



The self-diagnosis function is activated.

- 1 Measure how long the  (standby) indicator flashes and stops flashing.  
For example, the indicator flashes for two seconds, stops flashing for one second, and flashes for two seconds.
- 2 Press  on the TV (top side) to switch it off, disconnect the AC power cord, and inform your dealer or Sony service center of how the indicator flashes (duration and interval).



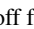
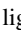

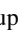
## When it is not flashing

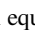
- 1 Check the items in the tables, below.
- 2 If the problem still persists, have your TV serviced by qualified service personnel.

## Picture

Problem	Cause/Remedy
No picture (screen is dark) and no sound	<ul style="list-style-type: none"> <li>• Check the power cord, antenna, and VCR connection.</li> <li>• The TV is not turned on. Press  on the TV (top side).</li> <li>• If the  (standby) indicator lights up in red, press .</li> </ul>
No picture	<ul style="list-style-type: none"> <li>• The picture off feature is activated. (The  (Picture Off/Sleep Timer) indicator lights up in green.) Press any button except for , , , ,  to cancel the picture off feature.</li> </ul>
No picture or no menu information from equipment connected to the video input jack	<ul style="list-style-type: none"> <li>• Check that the optional equipment is on and press  repeatedly until the correct input symbol is displayed on the screen.</li> <li>• Check the connection between the optional equipment and the TV.</li> </ul>
Distorted picture	<ul style="list-style-type: none"> <li>• Check if any connected optional equipment is installed in front of the TV or beside the TV. When installing optional equipment, leave some space between the optional equipment and the TV.</li> <li>• When changing programs or selecting Text, turn off any equipment connected to the video input jack on the rear of the TV.</li> <li>• Broadcast signals are too strong. Turn off or disconnect the booster if it is in use.</li> </ul>
Double images or ghosting	<ul style="list-style-type: none"> <li>• Check antenna/cable connections.</li> <li>• Check the antenna location and direction. Contact a Sony dealer for advice.</li> <li>• Broadcast signals are reflected by nearby mountains or building. Use the fine tuning ("Fine" function (page 35). Otherwise, use a highly direction antenna.</li> <li>• Use of a booster is inappropriate. Turn off or disconnect the booster if it is in use.</li> </ul>
Snowy picture and noisy sound	<ul style="list-style-type: none"> <li>• The antenna connection is loose or the antenna cable is damaged. Check the cable and connection on the TV, VCR, and on the wall (page 15).</li> <li>• Channel presetting is inappropriate or incomplete. Perform "Manual Program" in the "Set Up" menu to preset the channel again (page 34).</li> <li>• The antenna type is inappropriate. Check the antenna type (VHF/UHF). Contact a Sony dealer for advice.</li> <li>• The antenna direction needs adjustment. Adjust the antenna direction. Contact a Sony dealer for advice.</li> <li>• Signal transmission is low. Try using a booster.</li> </ul>

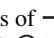
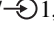

<b>Problem</b>	<b>Cause/Remedy</b>
Only snow and noise appear on the screen	<ul style="list-style-type: none"> <li>• Check if the antenna is broken or bent.</li> <li>• Check if the antenna has reached the end of its serviceable life (three to five years in normal use, one to two years at the seaside).</li> </ul>
Picture (dotted lines or stripes) noise	<ul style="list-style-type: none"> <li>• Keep the TV away from electrical noise sources such as cars, motorcycles, or hair-dryers, etc.</li> <li>• Make sure that the antenna is connected using the antenna cable (supplied).</li> <li>• Keep the antenna cable away from other connecting cables.</li> <li>• Do not use a 300-ohm twin lead cable as interference may occur.</li> <li>• Adjust the antenna direction for the minimum interference. Contact a Sony dealer for advice.</li> </ul>
Picture noise when viewing a TV channel	<ul style="list-style-type: none"> <li>• Select “Manual Program” in the “Set Up” menu and adjust “Fine” to obtain better picture reception (page 35).</li> <li>• Select “NR” (Noise Reduction) in the “Picture” menu to reduce the noise in the picture (page 25).</li> </ul>
Stripe noise during playback/recording of a VCR	<ul style="list-style-type: none"> <li>• Video head interference. Keep your VCR away from the TV.</li> <li>• Leave a space of 30 cm between your VCR and the TV to avoid noise.</li> <li>• Avoid installing your VCR in front of the TV or beside the TV.</li> </ul>
Good picture, but noisy sound	<ul style="list-style-type: none"> <li>• The TV system setting is inappropriate. If the sound of all the channels are noisy, perform “Auto Program” in the “Set Up” menu to preset the channel again (page 32). If the sound of some channels is noisy, select the channel, then perform “Manual Program” in the “Set Up” menu, and select the appropriate TV system (“TV System”) (page 34).</li> </ul>
Good picture, but no sound	<ul style="list-style-type: none"> <li>• The volume level is too low. Press <math>\triangleleft +</math> to increase the volume level.</li> <li>• The sound is muted. Press <math>\text{MUTE}</math>, or <math>\triangleleft +</math> to cancel the muting.</li> </ul>
Some tiny black points and/or bright points on the screen	<ul style="list-style-type: none"> <li>• The picture of a display unit is composed of pixels. Tiny black points and/or bright points (pixels) on the screen do not indicate a malfunction.</li> </ul>
No color on programs	<ul style="list-style-type: none"> <li>• Select “Reset” in the “Picture” menu to return to the factory settings (page 25).</li> </ul>
No color	<ul style="list-style-type: none"> <li>• The color intensity setting is too low. Select “Color” in the “Picture” menu to adjust the color intensity (page 24).</li> <li>• The antenna direction needs adjustment. Adjust the antenna direction. Contact a Sony dealer for advice.</li> </ul>
Lines moving across the TV screen	<ul style="list-style-type: none"> <li>• There is interference from external sources, e.g., heavy machineries, broadcast station nearby. Use the fine tuning (“Fine”) function (page 35).</li> </ul>
No color or irregular color when viewing a signal from the Y, Pb/Cb, Pr/CR jacks of  / 	<ul style="list-style-type: none"> <li>• Check the connection of the Y, Pb/Cb, Pr/CR jacks of / .</li> <li>• Make sure that the Y, Pb/Cb, Pr/CR jacks of /  are firmly seated in their respective jacks.</li> </ul>

## Sound

Problem	Cause/Remedy
No sound, but good picture	<ul style="list-style-type: none"><li>• Press <math>\triangle</math> +/- or <math>\text{Mute}</math> (Mute).</li><li>• Check that “TV Speakers” is set to “On” in the “Features” menu (page 29).</li></ul>
Noisy sound	<ul style="list-style-type: none"><li>• See the “Picture (dotted lines or stripes) noise” cause/remedy on page 41.</li></ul>
“High” is selected in “Audio Filter” when you use “Mono”.	<ul style="list-style-type: none"><li>• Set to “Low”.</li></ul>
Stereo broadcast sound switches on and off, or is distorted; The sound switches between stereo and monaural frequently	<ul style="list-style-type: none"><li>• The antenna connection is loose or the antenna cable is damaged. Check the cable and connection on the TV, VCR, and on the wall (page 15).</li><li>• Adjust the antenna direction for the minimum interference. Contact a Sony dealer for advice.</li><li>• Signal transmission is low. Try using a booster. Otherwise, use the fine tuning (“Fine”) function (page 35).</li></ul>
No sound from the computer	<ul style="list-style-type: none"><li>• Check the connection of the audio cable (page 36).</li></ul>

## General

Problem	Cause/Remedy
The TV turns off automatically (the TV enters standby mode)	<ul style="list-style-type: none"><li>• Check if the Sleep function is activated (page 31).</li><li>• “Power Saving” is set to “On” when a PC is connected.</li></ul>
Some input sources cannot be selected	<ul style="list-style-type: none"><li>• Select “AV Preset” in the “Set Up” menu and cancel “Skip” of the input source (page 34).</li></ul>
The remote does not function	<ul style="list-style-type: none"><li>• Replace the batteries.</li></ul>
The wide screen mode changes spontaneously when “Auto Wide” is “On”	<ul style="list-style-type: none"><li>• During a transition between two programs, the TV detects the optimum wide screen mode. During this period, an irregular wide screen mode may appear.</li><li>• The wide mode is switched automatically according to the revised signal with a Wide ID signal.</li><li>• The Auto Wide feature stops working temporarily when you press <math>\text{Auto Wide}</math>, and resumes after a while. To fix in the manually selected wide screen mode, set “Auto Wide” to “Off” in the “Screen” menu (page 28).</li></ul>
Teletext display is incomplete or garbled	<ul style="list-style-type: none"><li>• Your area may not be able to receive Teletext. Teletext is displayed only in the area that is covered by Teletext services.</li><li>• The antenna connection is loose or the antenna cable is damaged. Check the cable and connection on the TV, VCR, and on the wall (page 15).</li><li>• The antenna direction needs adjustment. Adjust the antenna direction. Contact a Sony dealer for advice.</li><li>• Signal transmission is too low. Try using a booster.</li><li>• Using the fine tuning (“Fine”) function may improve the picture (page 35).</li></ul>
Cannot play shooting games	<ul style="list-style-type: none"><li>• Some shooting games which involve pointing a light beam at the TV screen with an electronic gun or rifle cannot be used with your TV. For details, see the instruction manual supplied with the video game software.</li></ul>
The TV cabinet creaks	<ul style="list-style-type: none"><li>• Changes in room temperature sometimes make the TV cabinet expand or contract, causing a noise. This does not indicate a malfunction.</li></ul>
Static discharge is felt when touching the TV cabinet	<ul style="list-style-type: none"><li>• This is the same static discharge that is felt when touching metal door handles or car doors especially when the air is dry, for example in winter. This does not indicate a malfunction.</li></ul>

# Index

## Numerics

0-9 buttons 9  
4:3 Default 28

## A

Antenna, connecting 15  
Audio Filter 35  
Auto Program 18, 32  
Auto Start Up 32  
Auto Wide 28  
AV Preset 33

## B

Backlight 24  
Balance 26  
Bass 26  
Batteries, inserting into the remote 14  
Brightness 24

## C

Channels  
    auto-programming 18  
    selecting 19  
    skip 35  
Color 24  
Color Temperature 25  
Colored buttons 9  
Connecting  
    an antenna/VCR 15  
    optional equipment 36

## D

Dual Sound 27

## E

External inputs 22

## F

Fastext 20  
Features menu 29  
Fine 35

## H

Headphones  
    connecting 36  
Hue 24

## I

Info (ⓘ) button 9  
Input select (↔) button 9, 10  
Intelligent Volume 27

## L

Label 33  
Language 32  
Light Sensor 29

## M

Manual Program 34  
Mute (Ⓜ) button 9

## N

NR (Noise Reduction) 25  
Number buttons 9

## P

PC Adjustment 30  
PC input signal compatibility 38  
Personal Computer  
    Connecting 36  
Picture 24  
Picture Freeze 20  
Picture Freeze (⏸) button 9  
Picture menu 24  
Picture mode (👁) button 9  
Picture Off (ⓧ) indicator 10  
Power (⏻) indicator 10  
Power Saving 29  
Power (🔌) switch 10  
Previous channel (⏪) button 9  
PROG +/- buttons 9, 10  
Program index table 19  
Program Label 33, 34  
Program Sorting 33

## R

Remote  
    control sensor 10  
    inserting batteries 14  
    overview 9  
Reset  
    picture adjustment 25  
    sound adjustment 26

## S

Set Up menu 32  
Settings 22  
    Overview 23  
Sharpness 24  
Skip 35  
Sleep 31  
Sleep Timer (🕒) button 9  
Sleep Timer (🕒) indicator 10  
Sound menu 26  
Sound Mode 26  
Sound mode (🔊) button 9  
Sound Offset 34  
Specifications 39  
Standby (🔌) indicator 10  
Swivel 16

## T

Text 20  
Text (📄) button 9  
Text hold (🔒) button 9  
Text reveal (❓) button 9  
Tilt 16  
Timer menu 31  
Treble 26  
TV list 22

TV mode (📺) button 9  
TV Speakers 29  
TV standby (🔌) button 9

## V

VCR  
    connecting 15  
Volume (🔊) +/- buttons 9, 10

## W

WEGA GATE  
    Button 9, 10, 12, 22  
    Overview 22  
Wide Mode 20, 28  
Wide mode (📺) button 9  
Wide screen menu 28

## Z

Zoom 20

**BBE**  
**DIGITAL**



<http://www.sony.net/>



Printed on 100% recycled paper using  
VOC (Volatile Organic Compound)-  
free vegetable oil based ink.



2630948160

Printed in Japan