



# IC Recorder

## Operating Instructions

### Owner's Record

The model number is located at the rear and the serial number is located inside the battery compartment. Record the serial number in the space provided below. Refer to these numbers whenever you call upon your Sony dealer regarding this product.

Model No. ICD-B300 Serial No. \_\_\_\_\_

# IC RECORDER ICD-B300

©2005 Sony Corporation Printed in China

http://www.sony.net/

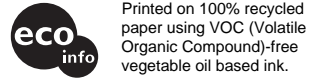

Printed on 100% recycled paper using VOC (Volatile Organic Compound)-free vegetable oil based ink.

### Information

IN NO EVENT SHALL SELLER BE LIABLE FOR ANY DIRECT, INCIDENTAL OR CONSEQUENTIAL DAMAGES OF ANY NATURE, OR LOSSES OR EXPENSES RESULTING FROM ANY DEFECTIVE PRODUCT OR THE USE OF ANY PRODUCT.

### For the customers in the U.S.A.

#### INFORMATION

This equipment has been tested and found to comply with the limits for a Class B digital device, pursuant to Part 15 of the FCC Rules. These limits are designed to provide reasonable protection against harmful interference in a residential installation. This equipment generates, uses, and can radiate radio frequency energy and, if not installed and used in accordance with the instructions, may cause harmful interference to radio communications.

However, there is no guarantee that interference will not occur in a particular installation. If this equipment does cause harmful interference to radio or television reception, which can be determined by turning the equipment off and on, the user is encouraged to try to correct the interference by one or more of the following measures:

- Reorient or relocate the receiving antenna.
- Increase the separation between the equipment and receiver.
- Connect the equipment into an outlet on a circuit different from that to which the receiver is connected.
- Consult the dealer or an experienced radio/TV technician for help.

You are cautioned that any changes or modifications not expressly approved in this manual could void your authority to operate this equipment.

This device complies with Part 15 of the FCC Rules. Operation is subject to the following two conditions: (1) This device may not cause harmful interference, and (2) this device must accept any interference received, including interference that may cause undesired operation.

If you have any questions about this product, you may call: Sony Customer Information Services Center 1-800-222-7669 or http://www.sony.com/

### Disposal of Old Electrical & Electronic Equipment (Applicable in the European Union and other European countries with separate collection systems)

This symbol on the product or on its packaging indicates that this product shall not be treated as household waste. Instead it shall be handed over to the applicable collection point for the recycling of electrical and electronic equipment. By ensuring this product is disposed of correctly, you will help prevent potential negative consequences for the environment and human health, which could otherwise be caused by inappropriate waste handling of this product. The recycling of materials will help to conserve natural resources. For more detailed information about recycling of this product, please contact your local Civic Office, your household waste disposal service or the shop where you purchased the product.

This symbol on the product or on its packaging indicates that this product shall not be treated as household waste. Instead it shall be handed over to the applicable collection point for the recycling of electrical and electronic equipment. By ensuring this product is disposed of correctly, you will help prevent potential negative consequences for the environment and human health, which could otherwise be caused by inappropriate waste handling of this product. The recycling of materials will help to conserve natural resources. For more detailed information about recycling of this product, please contact your local Civic Office, your household waste disposal service or the shop where you purchased the product.

### Troubleshooting

Before taking the unit for repair, check the following sections. Should any problem persist after you have made these checks, consult your nearest Sony dealer.

#### The unit does not operate.

- The batteries have been inserted with incorrect polarity.
- The batteries are weak.
- The buttons are locked with the HOLD switch. (If you press any button, "HOLD" will flash for 3 seconds.)

#### No sound comes from the speaker.

- The ear receiver or headphones are plugged in.
- The volume is turned down completely.

#### "FULL" is displayed and you cannot start recording.

- The memory is full. Erase some of the messages.
- 99 messages have been recorded in the selected folder. Select another folder or erase some of the messages.

#### Noise is heard.

- An object, such as your finger, etc., accidentally rubbed or scratched the unit during recording so that noise was recorded.
- The unit was placed near an AC power source, a fluorescent lamp or a mobile phone during recording or playback.
- Plug of the connected microphone was dirty when recording. Clean the plug.
- Ear receiver/headphones plug is dirty. Clean the plug.

#### Recording level is low.

- Set the microphone sensitivity to "H (high)" using the menu.

#### Recording is interrupted.

- The advanced VOR function is activated. Set VOR to "OFF".

#### Recording level is unstable (when recording music, etc.).

- This unit is designed to automatically adjust the recording level when recording meetings, etc., and is not suitable for music recording.

#### --Y--M--D" or "--:--" is displayed.

- You have not set the clock.

#### --Y--M--D" or "--:--" is displayed on the REC DATE display.

- The date and time of recording will not be displayed if you recorded the message when the clock was not set.

#### You cannot divide a message.

- You cannot divide a message in a folder which has 99 messages.
- If you divide messages frequently, the unit may become unable to divide a message.
- You cannot divide a message in the first or the last 1 second of a message.

#### It takes longer for the unit to start operation.

- If you divide messages too frequently while the unit is recording them, the following phenomenon may occur: The OPR indicator keeps flashing, and you cannot operate the unit for a certain period. This is not a malfunction. Wait until the OPR indicator goes off.

#### You cannot record messages up to the maximum recording time.

- If you record messages in a mixture of HQ, SP and LP modes, the recordable time varies from the maximum HQ mode recording time to the maximum LP mode recording time.
- No more recording can be made when 99 messages each have been recorded in a folder.
- Due to the limitation of the IC recording system, this unit records in the minimum recording unit. If the length of each message cannot be divided by the minimum recording unit, the remaining recording time may decrease by more than the total length of the messages.

#### The unit does not operate correctly.

- Take out the batteries and insert them again.

Please note that recorded messages may be erased during service or repair work.

### ▶Getting started

## Step 1: Installing the Batteries

### 1 Slide and lift the battery compartment lid.

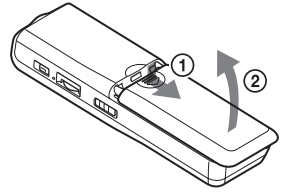

#### Replacing the batteries

The battery indicator in the display window shows the battery condition. When flashes, replace the batteries with new ones. When flashes, the batteries are exhausted and the unit will stop operation.

#### Battery life\*

With continuous use, approx. 11 hours recording/7.5 hours playback in the HQ mode, and approx. 22 hours recording/11 hours playback in the SP and LP modes is possible.  
 \* Using Sony alkaline batteries LR03 (size AAA)  
 \* When playing back through the internal speaker with the medium volume level  
 The battery life may shorten depending on the operation of the unit.

#### Notes

- Do not use manganese batteries for this unit.
- When you replace the batteries with new ones, the clock setting display appears. In this case, set the date and time again. The recorded messages and alarm setting, however, will remain.
- When replacing the batteries, be sure to replace both batteries with new ones.
- Do not charge dry batteries.
- When you are not going to use the unit for a long time, remove the batteries to prevent damage from battery leakage and corrosion.
- The unit is accessing data while "ACCESS" appears in the display window. While accessing, do not remove the batteries. Doing so may damage the data.

### 2 Insert two LR03 (size AAA) alkaline batteries with correct polarity, and close the lid.

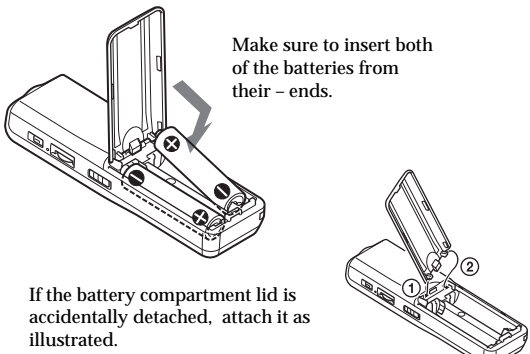

If the battery compartment lid is accidentally detached, attach it as illustrated.

Clock setting display appears when you insert batteries for the first time, or when you replace the batteries with new ones. Please refer to Steps 2 to 3 in "Step 2: Setting the Clock" to set the date and time.

## Step 2: Setting the Clock

Clock setting display appears when you insert batteries for the first time, or when you replace the batteries with new ones. In this case, proceed from step 2.

### 1 Display the clock setting display.

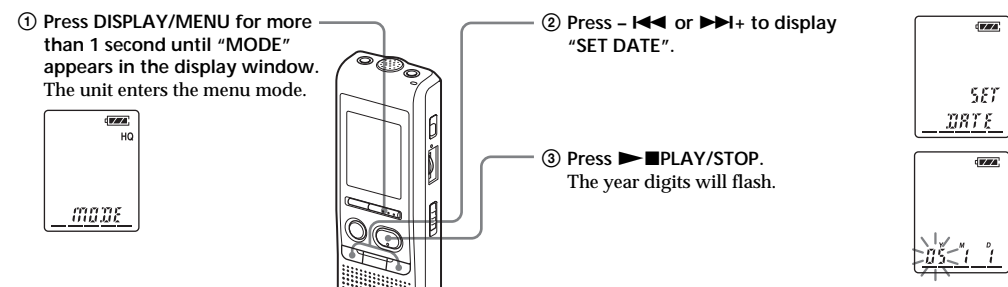

### 2 Set the date.

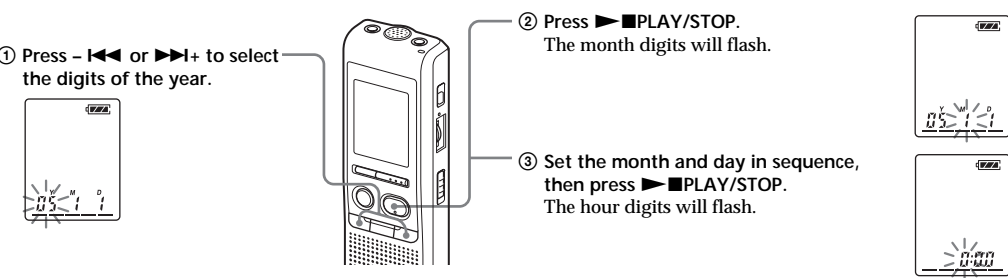

**Tip**  
To set the date to Year 2005, display "05Y".

### 3 Set the time.

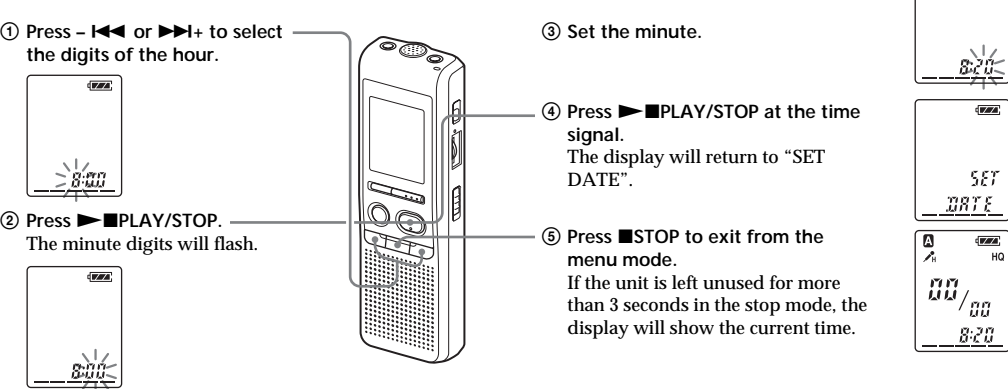

**Tip**  
This unit does not have a power on/off switch. The display is shown at all times.

### ▶Basic Operations

## Recording Messages

You can record up to 99 messages in each of the four folders (A, B, C, and D). Since a newly recorded message is automatically added behind the last recorded message, you can start recording quickly without searching for the end of the last recording.

e.g. Message 1 Message 2 Newly recorded message Blank space

#### Note

Before making a long recording, be sure to insert new batteries and check the battery indicator.

### 1 Select the recording mode.

See "Changing the Recording Mode" on the reverse side.

### 2 Select the folder.

See "Selecting the Folder".

### 3 Start recording.

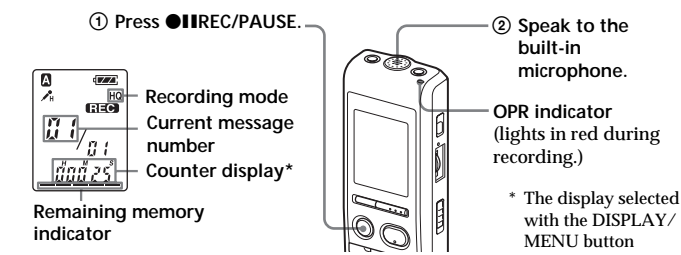

You do not need to keep pressing while recording.

### 4 Stop recording.

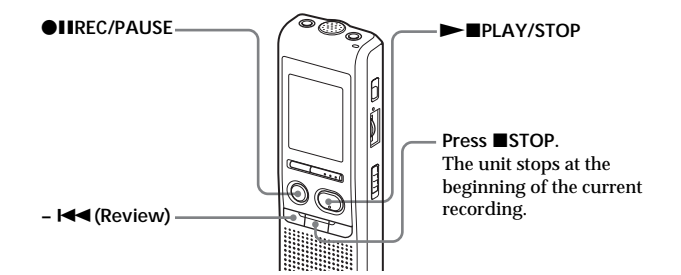

If you do not change the folder after you stop recording, the next time you record you will record in the same folder.

| To  | Do this   |
|---|---|
| pause recording*                          | Press . During recording pause, the OPR indicator flashes in red and "PAUSE" flashes in the display window.   |
| release pause and resume recording        | Press . (To stop recording after pausing recording, press .)  |
| listen to the current recording           | Press  to stop recording, then press .  |
| review the current recording instantly    | Press  during recording.  |
| search backward during recording (Review) | Hold down  during recording or recording pause. Recording mode will be released, and reviewing of the current recording starts. If you release the button, playback starts from that point.                                     |
| select the microphone sensitivity         | You can select the microphone sensitivity using the menu. See "Selecting the Microphone Sensitivity". H (high): To record at meeting or in a quiet and/or spacious place. L (low): To record for dictation or in a noisy place. |

\* About one hour after you pause recording, recording pause is automatically released and the unit goes into the stop mode.

### Selecting the Folder

- Press DISPLAY/MENU for more than 1 second until "MODE" appears in the display window.
- Press or to select "FOLDER" and press .
- Press or to select the folder you want and press .
- Press to exit the menu mode.

#### Note on recording

Noise may be recorded if an object, such as your finger, etc., accidentally rubs or scratches the unit during recording.

#### Maximum recording time

The maximum recording time of all the folders is as follows. You can record messages for the maximum recording time in a single folder.

HQ\* 7 h. 30 min.  
 SP\*\* 20 h. 5 min.  
 LP\*\*\* 37 h. 5 min.

(h.: hours/min.: minutes)

\* HQ: High quality recording mode (monaural sound)

\*\* SP: Standard play recording mode (monaural sound)

\*\*\* LP: Long play recording mode (monaural sound)

#### Notes

- To record in better sound quality, select the HQ mode. For switching the recording mode, see "Changing the Recording Mode" on the reverse side.
- Before making a long recording, be sure to check the battery indicator.
- The maximum recording time and the number of messages you can make vary depending on the conditions of use.
- When you record messages in the mixture of HQ, SP and LP mode, the maximum recording time will be between those for the HQ and LP modes.
- Due to the limitation of the IC recording system, this unit records in the minimum recording unit of approx. 2 seconds at most, therefore the following symptoms may occur:
  - When a message is shorter than the minimum recording unit, it is still counted as approx. 2 seconds at most so the remaining recording time will decrease by more than the actual length of the message.
  - When the message is longer than the minimum recording unit, the remaining recording time will decrease by more than the actual length of the message if it cannot be divided by the minimum recording unit without a remainder.
  - The sum of the number on the counter (elapsed recording time) and the remaining recording time may be less than the unit's maximum recording time.

#### Remaining memory indication

During recording, the remaining memory indicator decreases one by one.

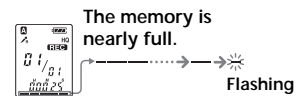

When the remaining time of recording reaches 5 minutes, the last one of the indication flashes. If the remaining recording time display mode is selected, "REMAIN" and the counter display flash when the remaining time reaches 1 minute. To continue recording, first erase some of the messages.

#### Notes

- If you press when the memory is full, "FULL" will flash with an alarm sound. Erase some of the messages before you start recording again.
- If you press after you have recorded 99 messages, "FULL" will flash with an alarm sound. Select another folder or erase some of the messages.

#### Starting recording automatically in response to the sound — Advanced VOR function

When VOR (voice operated recording) is set to ON in the menu, recording starts when the recorder detects sound. ("VOR" is displayed in the display window.)



Recording stops when no sound is heard. ("VOR PAUSE" flashes in the display window.)

#### Note

VOR function is affected by the sound around you. Set the microphone sensitivity to "H (high)" or "L (low)" using the menu. If recording is not satisfactory after you have changed the microphone sensitivity, or for important recording, set VOR to OFF.

### Selecting the Microphone Sensitivity

- Press DISPLAY/MENU for more than 1 second until "MODE" appears in the display window.
- Press or to select "SENS" and press .
- Press or to select "H (high sensitivity)" or "L (low sensitivity)" and press .
- Press to exit the menu mode.

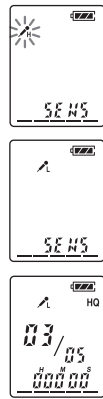

## Playing Back Messages

When playing back a previously recorded message, start from Step 1. When playing back a message you have just finished recording, start from Step 3.

### 1 Select the folder.

See "Selecting the Folder".

### 2 Select the message number.



\* The display selected with the DISPLAY/MENU button appears (see the reverse side).

### 3 Start playback.

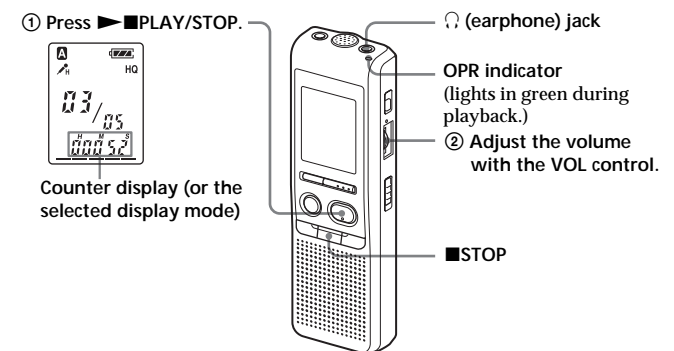

#### Playing back a message repeatedly

During playback, press for more than one second.

"C" will be displayed and the selected message will be played back repeatedly. To resume normal playback, press again. To stop playback, press .

#### Playing back all messages in a folder continuously

You can select the continuous play mode with the CONT in the menu. When you set CONT to ON, you can play back all messages in a folder continuously.

#### Searching forward/backward during playback (Cue/Review)

To search forward, keep pressed during playback and release the button at the point you wish to resume playback. To search backward, keep pressed during playback and release the button at the point you wish to resume playback.

If you keep or pressed, the unit starts to search at higher speed. For the first 10 seconds of cue/review, fast playback sound can be heard. When searching at a higher speed, playback sound will not be heard. During cue/review, the counter will be displayed, regardless of the display mode setting.

#### Tip

When fast playback is done to the end of the last message, "END" flashes for 5 seconds. (You cannot hear the playback sound.) If you keep pressed while "END" is flashing, the messages are played back rapidly, and normal playback will start at the point you release the button.

When "END" stops flashing and the OPR indicator goes off, the unit will stop at the beginning of the last message.

If the last message is long and you wish to start playback at a later part of the message, keep pressed to play back the message to the end and then press while "END" is flashing to go back to the desired point. (For messages other than the last one, go to the beginning of the next message and play backward to the desired point.)

#### For private listening

Connect an ear receiver or headphones (not supplied) to the (earphone) jack. The built-in speaker will be automatically disconnected. If noise is heard, wipe the headphones plug.

#### Other operations

| To   | Do this   |
|--|---|
| stop at the current position                             | Press  or . To resume playback from that point, press  again.   |
| go back to the beginning of the current message          | Press  once.  |
| skip to the next message                                 | Press  once.  |
| go back to previous messages/skip to succeeding messages | Press  or  repeatedly. (During stop mode, keep the button pressed to skip the messages continuously.) |



# Erasing Messages

You can erase the recorded messages one by one or all messages in a folder at a time. Note that once a recording has been erased, you cannot retrieve it.

## Erasing messages one by one

When a message is erased, the remaining messages will advance and renumbered so that there will be no space between messages.

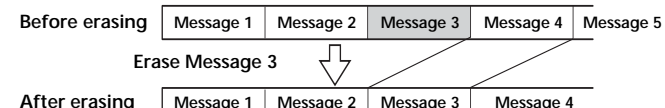

Remaining messages are renumbered.

1 Press ERASE while playing back the message you want to erase or press ERASE for more than 1 second during stop mode. A beep will sound and the message number and "ERASE" will flash while the whole message is played back 10 times.

2 Press ERASE while the message is being played back. The message is erased and the remaining messages will be renumbered. (For example, if you erase Message 3, Message 4 will be renumbered as Message 3. When erasing is completed, the unit will start at the beginning of the following message.)

**To cancel erasing**  
Press ■STOP before step ②.

**To erase other messages**  
Repeat steps ① and ②.

**To erase a message partially**  
First divide the message and then follow the steps to erase the message.

## Erasing all messages in a folder

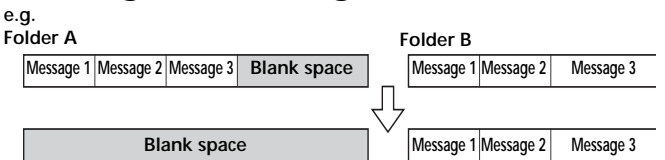

1 Select the folder you want to erase using DISPLAY/MENU. (See "Selecting the Folder" on the front side.)

2 While pressing ■STOP, press ERASE for more than 1 second. "ALL ERASE" will flash for 10 seconds.

3 While the display is flashing, press ERASE.

**To cancel erasing**  
Press ■STOP before step ③.

# Index to Parts and Controls

## Main unit

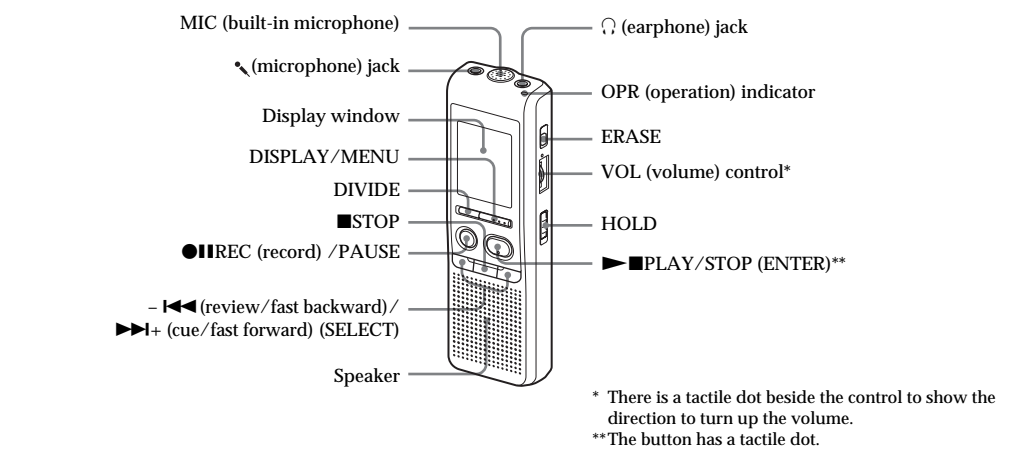

\* There is a tactile dot beside the control to show the direction to turn up the volume.  
\*\* The button has a tactile dot.

## Rear

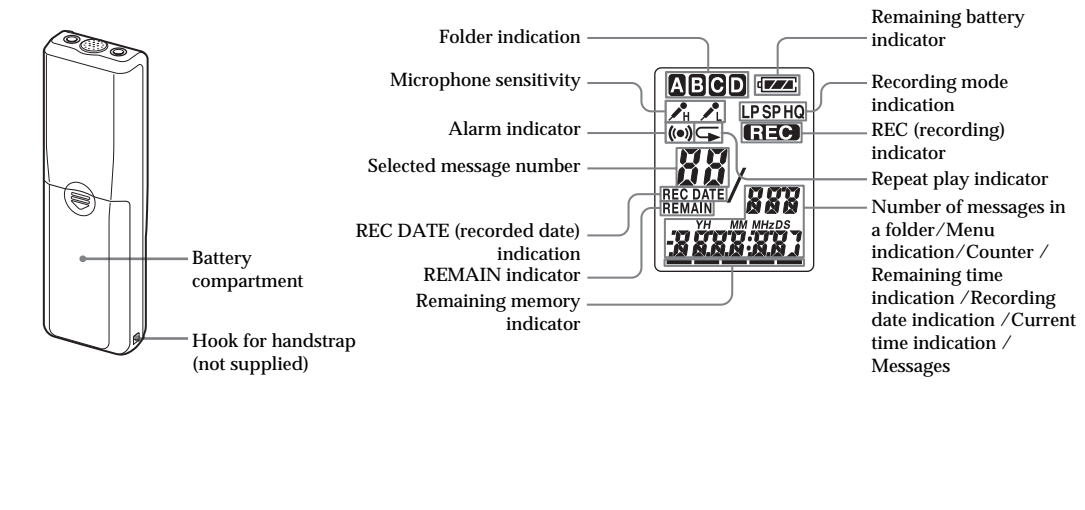

## Various Ways of Recording

### Adding a Recording to a Previously Recorded Message

You can add a recording to the message being played back. The added recording will be placed after the current message and counted as a part of the message.

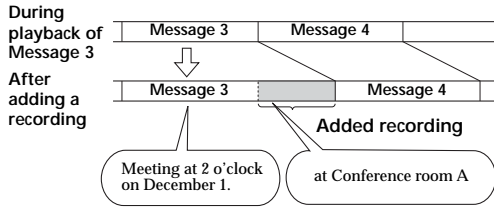

1 During playback, press ■HREC/PAUSE for more than 1 second. The "REC" indication appears and "ADD" will flash for 3 seconds in the display window. The OPR indicator will turn red. The new recording will be added at the end of the current message.

2 Press ■STOP to stop the recording.

**Notes**

- You cannot add a recording if the remaining memory is not long enough.
- The added portion of a message will be recorded in the same recording mode (HQ, SP, or LP).

### Recording with an External Microphone or from Other Equipment

1 Connect a plug-in-power type microphone or other equipment to the (microphone) jack.

#### When recording with an external microphone

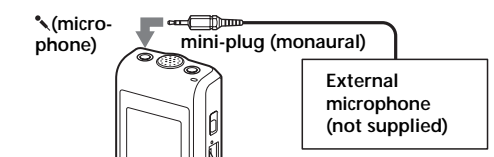

When you connect an external microphone, the built-in microphone is automatically cut off. When a plug-in power type microphone is connected, power is automatically supplied to the microphone from the IC recorder.

#### When recording from other equipment

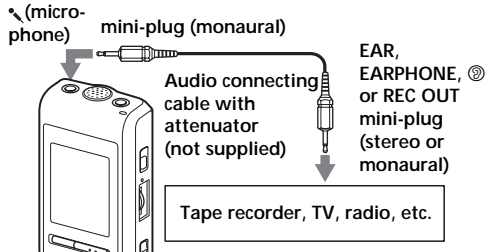

2 Follow the steps in "Recording Messages" on the front side to record messages.

**Notes**

- Make sure that the plugs are connected securely.
- We recommend you make a trial recording to check the connections and volume control.
- When connecting equipment other than Sony's, refer to the instruction manual of the equipment.

### Starting Recording Automatically in Response to the Sound — Advanced VOR function

**VOR ON:** The VOR (Voice Operated Recording) function is activated. Recording starts when the unit detects sound and stops when no sound is heard, eliminating recording from soundless period.

**VOR OFF:** The VOR function is disabled. Normal recording operation is selected.

1 Press DISPLAY/MENU for more than 1 second until "MODE" appears in the display window.

2 Press -◀ or ▶+ to display "VOR" and press ■PLAY/STOP. "OFF (or ON)" will flash.

3 Press -◀ or ▶+ to select "ON" or "OFF" and press ■PLAY/STOP. Now the setting is completed.

4 Press ■STOP to exit the menu mode.

## Other Functions

### Dividing a Message

You can divide a message during recording or playback, so that the message is divided into two and the new message number is added to the divided message. By dividing a message, you can easily find the point you want to play back when you make a long recording such as a meeting. You can divide messages until the total number of messages in the folder becomes 99.

While recording or playing back a message, press DIVIDE at the point you want to divide.

• When you press DIVIDE during recording: The new message number is added at the point you pressed the button, and the new message number and "DIVIDE" flash for 3 seconds. The message will be divided into two; however, the messages will be recorded without a break.

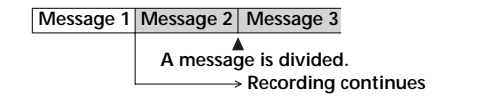

• **Tip**  
You can divide a message during recording pause.

• When you press DIVIDE during playback: The message is divided into two at the point you pressed the button, and the new message number and "DIVIDE" flash for 3 seconds. The message numbers of the following messages will increase by one.

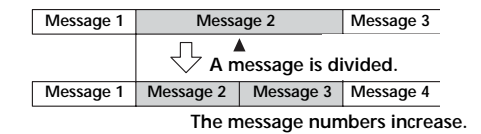

**To play the divided message**  
Press -◀ or ▶+ to display the message number as the divided messages each have message numbers.

• **To play the divided messages continuously**  
Select ON for CONT in the menu as described in "Playing Back All Messages in a Folder Continuously".

**Notes**

- If 99 messages have been recorded in a folder, you cannot divide a message. In that case, reduce the number of messages to 98 or less by erasing unnecessary messages or by moving some of the messages to another folder before dividing a message.
- If you divide a message with an alarm setting, the alarm setting remains only with the former message divided.
- You cannot divide a message frequently, the unit may become unable to divide a message.
- Once a message is divided, you cannot combine the divided messages with the IC recorder.
- If you divide messages too frequently while the unit is recording them, the following phenomenon may occur: The OPR indicator keeps flashing, and you cannot operate the unit for a certain period. This is not a malfunction. Wait until the OPR indicator goes off.

### Moving Messages to a Different Folder — Move Function

You can move the recorded messages to another folder. Example: Moving Message 3 in Folder A to Folder C

1 While the unit is stopped, select the message you want to move.

2 Press DISPLAY/MENU for more than 1 second until "MODE" appears in the display window.

3 Press -◀ or ▶+ to select "MOVE" and press ■PLAY/STOP. The destination folder indication flashes.

4 Press -◀ or ▶+ to select the folder to which you want to move the message (C in this case).

5 Press ■PLAY/STOP. The message is moved in the destination folder.

6 Press ■STOP to exit the menu mode.

**To cancel moving the message(s)**  
Press ■STOP before step 5.

**Note**  
The move function does not duplicate a message in another folder. When you move a message to another folder, the one in the previous folder will be deleted.

### Playing Back a Message at a Desired Time with an Alarm

You can sound an alarm and start playback of a selected message at a desired time. If you select "B-ONLY" in Step 6, an alarm sounds only and playback will not start.

1 Select the folder (See "Selecting the Folder" on the front side) and display the message you want to play back with an alarm.

2 Enter the alarm setting mode. ① Press DISPLAY/MENU for more than 1 second until "MODE" appears in the display window.

② Press -◀ or ▶+ to select "ALARM OFF" (If the alarm has already set to the selected message, "ALARM ON" is displayed. If you do not wish to change the setting, press ■STOP and exit the menu mode.)

**Note**  
"ALARM OFF (or ON)" will not appear and the alarm cannot be set if the clock has not been set or no message has been recorded in the selected folder.

③ Press ■PLAY/STOP. "OFF" starts to flash.

④ Press -◀ or ▶+ to select "ON". "ON" starts to flash.

⑤ Press ■PLAY/STOP. "DATE" will flash in the display window.

3 Set the alarm date. **To play back on a desired date** (the message will be played back at the same time on the same date every year until you erase the message)

① Press ■PLAY/STOP while "DATE" is flashing. The year digits will flash.

② Press -◀ or ▶+ to select the year digits and press ■PLAY/STOP. The month digits will flash.

③ Press -◀ or ▶+ to select the month digits and press ■PLAY/STOP. The day digits will flash.

④ Press -◀ or ▶+ to select the day digits.

**To play back once a week**  
Press -◀ or ▶+ to select the day of the week.

**To play back at the same time every day**  
Press -◀ or ▶+ to select "DAILY".

4 Press ■PLAY/STOP. The hour digits will flash.

5 Set the alarm time. ① Press -◀ or ▶+ to select the hour digits and press ■PLAY/STOP. The minute digits will flash.

② Press -◀ or ▶+ to select the minute digits and press ■PLAY/STOP. "B-PLAY" will be displayed.

6 Set the alarm sound. ① Press -◀ or ▶+ to select the alarm sound either from "B-PLAY" (playing back the message after the alarm) or "B-ONLY" (alarm only)

② Press ■PLAY/STOP. "ALARM ON" will be displayed.

7 Press ■STOP to exit the menu mode.

• "00" is displayed when the number of the message with alarm setting is selected. At the set time, the alarm will sound for about 10 seconds and the selected message will be played back. During playback, "ALARM" will flash in the display window. When the playback ends, the unit will stop automatically at the beginning of that message.

**To listen to the same message again**  
Press ■PLAY/STOP. The same message will be played back from the beginning.

### Turning off the Beep Sound

**BEEP ON:** A beep will sound to indicate that operation has been accepted.  
**BEEP OFF:** No beep sound will be heard except for the alarm and timer.

1 Press DISPLAY/MENU for more than 1 second until "MODE" appears in the display window.

2 Press -◀ or ▶+ to display "BEEP ON (or OFF)" and press ■PLAY/STOP. "ON (or OFF)" will flash.

3 Press -◀ or ▶+ to select "ON" or "OFF" and press ■PLAY/STOP. The setting is completed.

4 Press ■STOP to exit the menu mode.

### To cancel or change the alarm setting

1 Select the message you set the alarm to play back, and press DISPLAY/MENU for more than 1 second to enter the menu mode.

2 Press -◀ or ▶+ to select "ALARM ON".

3 Press ■PLAY/STOP to flash "ON".

4 To cancel the alarm setting: Press -◀ or ▶+ to flash "OFF" and press ■PLAY/STOP. When the alarm date is displayed, follow the Steps 3 to 6 of "Playing Back a Message at a Desired Time with an Alarm" to change the alarm setting.

5 Press ■STOP to exit the menu mode.

### Preventing Accidental Operation — HOLD function

Slide the HOLD switch to "ON". "HOLD" will appear for 3 seconds, indicating that all the functions of the buttons are locked. When the HOLD function is activated during stop, all the display will be turned off after "HOLD" is displayed.



**To cancel the HOLD function**  
Slide the HOLD switch to "OFF".

**Note**  
When the HOLD function is activated during recording, cancel the HOLD function first to stop recording.

• **Tip**  
Even if the HOLD function is activated, you can stop the alarm playback. To stop the alarm or playback, press ■STOP.

### Selecting the Display Mode

You can select the display mode for the stop, recording and playback modes. Each time you press DISPLAY/MENU, the display mode will change as shown below:

• **On the current time display**  
If the unit is left unoperated for more than 3 seconds in the stop mode, the display will show the current time, regardless of the display mode setting.

Counter: Elapsed playback/recording time in one message

Remaining time (REMAIN): In the playback mode: The remaining time of one message indication. In the stop and recording mode: The remaining recording time indication.

Recorded date (REC DATE)\*: The date the current message was recorded.

Recorded time (REC DATE)\*\*: The time the current message was recorded.

\* If the clock has not been set, "--Y--M--D" will be displayed.  
\*\* If the clock has not been set, "--:--" will be displayed.

## Turning off the Beep Sound

**BEEP ON:** A beep will sound to indicate that operation has been accepted.  
**BEEP OFF:** No beep sound will be heard except for the alarm and timer.

1 Press DISPLAY/MENU for more than 1 second until "MODE" appears in the display window.

2 Press -◀ or ▶+ to display "BEEP ON (or OFF)" and press ■PLAY/STOP. "ON (or OFF)" will flash.

3 Press -◀ or ▶+ to select "ON" or "OFF" and press ■PLAY/STOP. The setting is completed.

4 Press ■STOP to exit the menu mode.

## Changing the Recording Mode

HQ: You can record with the high quality sound (monoaural sound).

SP: You can record with better sound (monoaural sound).

LP: You can record for longer time (monoaural sound).

1 Press DISPLAY/MENU for more than 1 second until "MODE" appears in the display window.

2 Make sure that "MODE" is displayed and press ■PLAY/STOP. "HQ (or SP, LP)" will flash.

3 Press -◀ or ▶+ to select "HQ", "SP" or "LP" and press ■PLAY/STOP. Now the setting is completed.

4 Press ■STOP to exit the menu mode. The setting becomes effective and the normal screen will be displayed. If the unit is left unoperated for more than 3 seconds, the display will show the current time and the selected recording mode will be displayed.

• Earphone jack (minijack) for 8 - 300 ohms ear receiver/headphones  
• Microphone jack (minijack, monoaural)  
• Plug in power  
• Minimum input level 0.6 mV

Power requirements  
Two LR03 (size AAA) alkaline batteries: 3 V DC  
Dimensions (w/h/d) (not incl. projecting parts and controls)  
34.6 × 109.5 × 18.0 mm (1 3/8 × 4 3/8 × 23/32 in.)  
Mass (incl. batteries)  
65 g (2.3 oz)

Supplied accessories  
Operating instructions (1)  
LR03 (size AAA) alkaline batteries (2) (for the U.S.A., Canada and Tourist model only)  
Headphone (1) (excluding the U.S.A., Canada, Europe and Tourist model)  
Carrying pouch (1) (excluding the U.S.A., Canada, Europe and Tourist model)

Optional accessories  
Electret Condenser Microphone ECM-DM5P, ECM-Z60, ECM-TL1 (for telephone recording)  
Audio connecting cable RK-G64HG / RK-G69HG (excluding Europe)  
Active speaker SRS-T88, SRS-T80

Your dealer may not handle some of the above listed optional accessories. Please ask the dealer for detailed information.

Design and specifications are subject to change without notice.

1 Press DISPLAY/MENU for more than 1 second until "MODE" appears in the display window.

2 Press -◀ or ▶+ to display "CONT" and press ■PLAY/STOP. "OFF (or ON)" will flash.

3 Press -◀ or ▶+ to select "ON" or "OFF" and press ■PLAY/STOP. Now the setting is completed.

4 Press ■STOP to exit the menu mode.

## Precautions

**On power**  
• Operate the unit only on 3 V DC. Use two LR03 (size AAA) alkaline batteries.

**On safety**  
• Do not operate the unit while driving, cycling or operating any motorized vehicle.

**On handling**  
• Do not place the unit in a location near heat sources, or in a place subject to direct sunlight, excessive dust or mechanical shock.  
• Remove any solid object or liquid fall into the unit. Should the batteries and have the unit checked by qualified personnel before operating it any further.

**On noise**  
• Noise may be heard when the unit is placed near an AC power source, a fluorescent lamp or a mobile phone during recording or playback.  
• Noise may be recorded when an object, such as your finger, etc., rubs or scratches the unit during recording.

**On maintenance**  
• To clean the exterior, use a soft cloth slightly moistened in water. Do not use alcohol, benzine or thinner.

If you have any questions or problems concerning your unit, please consult your nearest Sony dealer.

**Backup recommendations**  
To avoid potential risk of data loss caused by accidental operation or malfunction of the IC recorder, we recommend that you save a backup copy of your recorded messages on a tape recorder, etc.

## Specifications

Recording media  
Built-in flash memory 64 MB, Monoaural recording

Recording time  
HQ: 7 hours 30 minutes  
SP: 20 hours 5 minutes  
LP: 37 hours 5 minutes

Frequency range  
HQ: 260 Hz - 6,800 Hz  
SP: 220 Hz - 3,400 Hz  
LP: 220 Hz - 3,100 Hz

Speaker  
approx. 2.8 cm (1 1/8 in.) dia.

Power output  
250 mW

Input/Output  
• Earphone jack (minijack) for 8 - 300 ohms ear receiver/headphones  
• Microphone jack (minijack, monoaural)  
• Plug in power  
• Minimum input level 0.6 mV

Power requirements  
Two LR03 (size AAA) alkaline batteries: 3 V DC  
Dimensions (w/h/d) (not incl. projecting parts and controls)  
34.6 × 109.5 × 18.0 mm (1 3/8 × 4 3/8 × 23/32 in.)  
Mass (incl. batteries)  
65 g (2.3 oz)

Supplied accessories  
Operating instructions (1)  
LR03 (size AAA) alkaline batteries (2) (for the U.S.A., Canada and Tourist model only)  
Headphone (1) (excluding the U.S.A., Canada, Europe and Tourist model)  
Carrying pouch (1) (excluding the U.S.A., Canada, Europe and Tourist model)

Optional accessories  
Electret Condenser Microphone ECM-DM5P, ECM-Z60, ECM-TL1 (for telephone recording)  
Audio connecting cable RK-G64HG / RK-G69HG (excluding Europe)  
Active speaker SRS-T88, SRS-T80

Your dealer may not handle some of the above listed optional accessories. Please ask the dealer for detailed information.

Design and specifications are subject to change without notice.