

Quick Start Guide 快速入门指南



NWZ-B152/B153/B152F/B153F



* 4 1 8 5 0 4 7 5 1 * (2)

©2010 Sony Corporation Printed in China
2010/4

English

About the Manual

- **Quick Start Guide:** Explains set up, enabling you to import songs to a computer, and to transfer them to the player.
- **Operation Guide (PDF file):** Explains advanced features of the player and offers troubleshooting information. The Operation Guide (PDF file) is stored in the memory of the player. To view the Operation Guide (PDF file), see "Supplied Items."

Supplied Items

- Headphones (1)
- Quick Start Guide (this manual) (1)

Items stored in the memory of the player

The following items are stored in the [Storage Media] folder of the memory of the player.

1. Remove the USB cap of the player and connect the player directly to a USB connector on your computer.
2. Double-click [My Computer] or [Computer] - [WALKMAN] - [Storage Media]*1. The following folders are displayed.
3. Copy all data or the necessary data in the following folders to your computer.

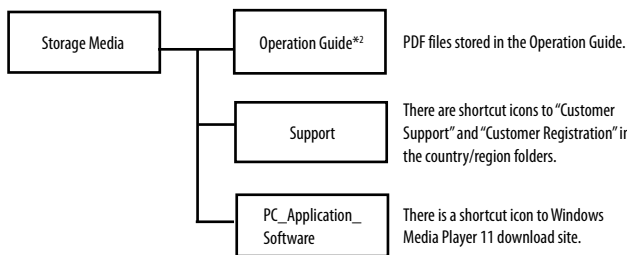

*1 Data hierarchy may differ, depending on your computer environment.

*2 PDF files named [xxx_NWZB150.pdf] in this folder are the Operation Guide. The language name is displayed in the place of "xxx." Choose the manual of your language. To view the Operation Guide (PDF file), you need Adobe Reader or Acrobat Reader 5.0 in your computer. Adobe Reader can be downloaded from the Internet for free.

Hint

- To use the free space in the [Storage Media] folder more effectively, back up all necessary data in the above three folders to your computer, and then delete the folders. To format the built-in flash memory of the player, see "To initialize (format) the player."

Before Connecting the Player to Your Computer

Make sure that the OS is Windows 7, Windows XP (Service Pack 2 or later) or Windows Vista (Service Pack 1 or later), and the installed Windows Media Player version on your computer is 11 or 12.

Charging the Battery

The player's battery is recharged while the player is connected to a running computer.

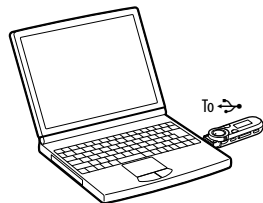

About 70 minutes
Charging → Fully charged

Note

- When you use the player for the first time, or if you have not used the player for a long time, recharge it fully. When charging a depleted battery, the power illuminator blinks clockwise and nothing appears in the display. If the player's display remains blank for more than 5 minutes, press the RESET button to reset the player.
- If you turn on the computer, restart the computer, shut down the computer, or wake up from Sleep or Hibernate status while the player is connected to the computer, the player may malfunction. In this case, press the RESET button of the player to reset it. Disconnect the player from the computer before performing these operations.

Parts and Controls

Front

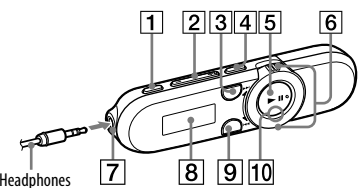

- 1 REC/STOP button**
Starts/stops recording. You can record sound using the player's built-in microphone. You can also record the currently received FM program (NWZ-B152F/B153F only).
- 2 VOL +/- button**
- 3 ZAP button**
Changes between normal playback and ZAPPIN playback. ZAPPIN playback sequentially plays back song clips at a preset duration.
- 4 BASS/PLAY MODE button**
Emphasizes the low sound range (Bass function), or changes the play mode.
- 5 ►|| button**
Starts/pauses song playback, or pauses/restarts recording.
- 6 Shuttle switch**
Rotate to find the beginning of a song, or fast-rewinds/forwards. When a menu appears on the display, rotate to select a menu item.

Rear

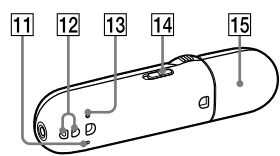

- 7 (Headphone) jack**
- 8 Display**
- 9 BACK/HOME button**
See "How to Use the Player."
- 10 Power illuminator**
Illuminated by LED.
- 11 MIC (Microphone)**
For recording sound by the player.
- 12 Strap hole**
- 13 RESET button**
Use a small pin, etc.
- 14 HOLD switch**
Disables the operation buttons to avoid accidental operation while carrying the player.
- 15 USB cap**
When connecting with USB, remove the USB cap.

Turning the Player On and Off

To turn on	Press the ► button.
To turn off	Press and hold the ► button.

Hint

- If song playback is paused and there is no operation for a certain period of time, the player turns off automatically.

How to Use the Player

The Home menu is the starting point of each application.

To display the Home menu	Press and hold the BACK/HOME button.
To select an item	Rotate the shuttle switch to ◀▶ to select an item, and then press the ► button to confirm.
To return to the previous screen	Press the BACK/HOME button.



The icons appear in the Home menu and the color of the selected icon is inverted.

[Voice]	Plays back/deletes sound files recorded with the player's built-in microphone.
[Music Library]	Plays back transferred songs on the player.
[FM]*1	Plays FM radio, or plays back/deletes FM radio programs recorded with the player.
[Settings]	Sets the function for music, FM*, voice recording, or player settings.

*1 [FM] and items related to the [FM] function appear on NWZ-B152F/B153F only.

Importing and Transferring Music

You can transfer songs to the player using Windows Media Player 11 or 12 on your computer. If you use Windows Media Player 10 or less on your computer, download Windows Media Player 11 from a shortcut icon in the memory of the player.

1 Import songs from CDs, etc., to Windows Media Player 11 or 12 on the computer.

For details on how to import songs from CDs, etc., refer to the Help of Windows Media Player 11 or 12. You do not need to re-import songs that have previously been imported to Windows Media Player 11 or 12.

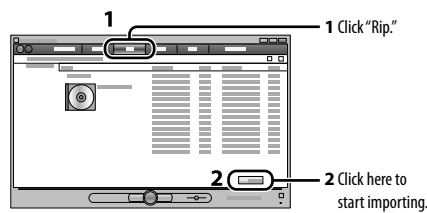

2 Connect the USB connector of the player to your computer.

Insert the USB connector fully.

3 Transfer songs from Windows Media Player 11 or 12 to the player.

[DATA ACCESS] appears in the display while transferring songs to the player.

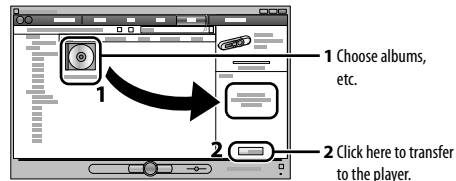

Note

- Do not disconnect the player while files are being transferred. If you do, the file being transferred will be damaged.
- You cannot transfer contents with copyright protection since the player does not support them.

Hint

- You can also transfer data to the player by dragging and dropping in Windows Explorer on your computer.

To delete songs transferred to the player

Connect the player to your computer, and then delete any unnecessary audio files using Windows Media Player 11, 12 or Windows Explorer.

Troubleshooting

If the player does not function as expected, try the following steps to resolve the issue.

1 Find the symptoms of the issue in "Troubleshooting" in the Operation Guide (PDF file), and try any corrective actions listed.

On connecting with the computer, see the following "System Requirements (for the player)" and tables.

2 Connect the player to your computer to charge the battery.

You may be able to resolve some issues by charging the battery.

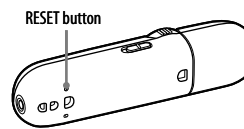

3 Press the RESET button with a small pin, etc.

If you press the RESET button while operating the player, stored data and settings on the player may be deleted. After resetting the player, press the ►|| button to turn on the player.

4 Check information on the issue in the Help of each software.

5 Look up information on the issue on one of the customer support Web sites.

About the customer support web sites, see "For the latest information."

6 If the approaches listed above fail to resolve the issue, consult your nearest Sony dealer.

System Requirements (for the player)

- Computer
IBM PC/AT or compatible computer preinstalled with the following Windows operating systems*1:
Windows XP Home Edition (Service Pack 2 or later) / Windows XP Professional (Service Pack 2 or later) / Windows Vista Home Basic (Service Pack 1 or later) / Windows Vista Home Premium (Service Pack 1 or later) / Windows Vista Business (Service Pack 1 or later) / Windows Vista Ultimate (Service Pack 1 or later) / Windows 7 Home Basic / Windows 7 Home Premium / Windows 7 Professional / Windows 7 Ultimate
Supported 64 bit version OS for Windows Vista & Windows 7.
Not supported by OSs other than above.

- *1 Excluding OS Versions not supported by Microsoft.
- CPU: 300 MHz or more (For Windows Vista, 800 MHz or more. For Windows 7, 1 GHz or more)
- RAM: 128 MB or more (For Windows Vista, 512 MB or more. For Windows 7, 1 GB (32 bit) / 2GB (64 bit) or more)
- USB connector (Hi-Speed USB is recommended)
- Internet Explorer 6.0 or later, Windows Media Player 11 or 12 need to be installed.
- Broadband Internet connection is required to use Electronic Music Distribution (EMD) or to visit the web site.

We do not guarantee operation for all computers even if they meet the above System Requirements.

- Not supported by the following environments:
- Personally constructed computers or operating systems
 - An environment that is an upgrade of the original manufacturer-installed operating system
 - Multi-boot environment
 - Multi-monitor environment
 - Macintosh

Design and specifications are subject to change without notice.

Symptom	Cause/Remedy
---------	--------------

The player cannot charge the battery.	<ul style="list-style-type: none"> • The player is not connected to a USB connector on your computer properly. → Disconnect the player, and then reconnect it. • The battery is charged in an ambient temperature out of the range of 5 °C (41 °F) to 35 °C (95 °F). → You cannot charge the battery when [] icon appears. Charge the battery in an ambient temperature of 5 °C (41 °F) to 35 °C (95 °F). • Your computer is not on. → Turn on the computer. • Your computer is in Sleep or Hibernate status. → Disconnect the player from the computer, and then release the computer from Sleep or Hibernate status. Reconnect the player to the computer.
---------------------------------------	---

[CONNECTED USB] does not appear when the player is connected to the computer.	<ul style="list-style-type: none"> • The player's USB connector is not connected to a USB connector on your computer properly. → Disconnect the player, and then reconnect it. • A USB hub is being used. → Connect the player directly to a USB connector, as connection via a USB hub may not work. However, a USB hub that supplies power can be used. • Another application is running on the computer. → Disconnect the player, wait a few minutes, and reconnect it. If the problem persists, disconnect the player, restart the computer, and then reconnect the player. • The USB connector on your computer may have a problem. Connect the player's USB connector to another USB connector on your computer. • The remaining battery power is insufficient. → Charge the battery by connecting the player to a running computer for at least 5 minutes. When charging a depleted battery, the power illuminator blinks clockwise and nothing appears in the display.
---	---

The player becomes unstable while it is connected to the computer.	<ul style="list-style-type: none"> • A USB hub is being used. → Connect the player directly to a USB connector, as connection via a USB hub may not work. However, a USB hub that supplies power can be used.
--	--

To initialize (format) the player

You can format the memory of the player. If the memory is formatted, all shortcut icons and files including the Operation Guide (PDF file) will be erased and all setting values returned to their defaults. Be sure to verify the files stored in memory prior to formatting and export any necessary files to the hard disk of your computer or other device beforehand.

1 Press and hold the BACK/HOME button until the Home menu appears.

2 Select [Settings] - [Initialize] - [Format] - [OK], in this order.
Rotate the shuttle switch to select the item, and then press the ►|| button to confirm.

After selecting [OK] and confirming, [FORMATTING...] appears and formatting starts. When formatting is complete, [COMPLETE] appears.

Note

- Do not format the memory of the player in Windows Explorer. If you format the player in Windows Explorer accidentally, do it again on the player.
- If you format the memory of the player by accident, download the Operation Guide (PDF file) from the web site mentioned in "For the latest information."

Precautions

About the headphones

- Avoid playing the unit at so loud a volume that extended play might affect your hearing.
- At a high volume outside sounds may become inaudible. Avoid listening to the unit in situations where hearing must not be impaired, for example, while driving or cycling.
- As the supplied headphones are of open-air design, sounds go out through the headphones. Remember not to disturb those close to you.

Notice for customers: the following information is only applicable to equipment sold in countries applying EU directives

The manufacturer of this product is Sony Corporation, 1-7-1 Konan Minato-ku Tokyo, 108-0075 Japan. The Authorized Representative for EMC and product safety is Sony Deutschland GmbH, Hedelfinger Strasse 61, 70327 Stuttgart, Germany. For any service or guarantee matters, please refer to the addresses given in separate service or guarantee documents.

Program ©2010 Sony Corporation
Documentation ©2010 Sony Corporation

For the latest information

If you have any questions or issues with a Sony product, or would like information on compatible items with a Sony product, visit the following Web sites.

- For customers in the USA: <http://www.sony.com/walkmansupport>
- For customers in Canada: <http://www.sony.ca/ElectronicsSupport/>
- For customers in Europe: <http://support.sony-europe.com/DNA>
- For customers in Latin America: <http://www.sony-latin.com/index.crp>
- For customers in other countries/regions: <http://www.sony-asia.com/support>
- For customers who purchased the overseas models: <http://www.sony.co.jp/overseas/support/>

简体中文

中国大陆地区的用户

使用产品前请仔细阅读本产品使用说明书，并请妥善保管

数码音频播放器（内置收音功能）

关于本手册

- 快速入门指南：**说明如何设定，使您可将歌曲导入电脑，并将它们传送到播放器。
- 使用手册（PDF 文件）：**说明播放器的高级功能并提供故障排除信息。使用手册（PDF 文件）储存在播放器的内存中。若要查看使用手册（PDF 文件），请参阅“附件”。

附件

- 耳机（1）
- 快速入门指南（本手册）（1）

播放器的内存中储存的项目

以下项目存储在播放器内存的 [Storage Media] 文件夹中。

- 取下播放器的 USB 盖并将播放器直接连接到您电脑上的 USB 连接器。
- 双击 [我的电脑] 或 [计算机] - [WALKMAN] - [Storage Media]^{*1}。显示以下文件夹。
- 将以下文件夹中的所有数据或必要数据复制到您的电脑。

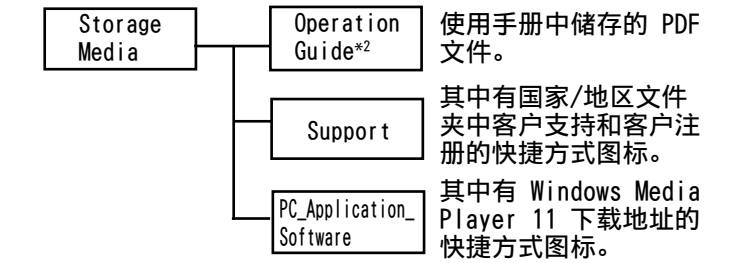

^{*1}根据电脑环境而定，数据的层次结构可能会不同。

^{*2}此文件夹中文件名为 [xxx_NWZB150.pdf] 的 PDF 文件是使用手册。语言名称显示在“xxx”位置。选择您语言的手册。若要查看使用手册（PDF 文件），您需要在电脑中安装 Adobe Reader 或 Acrobat Reader 5.0。Adobe Reader 可以从因特网上免费下载。

提示

- 若要更加有效使用 [Storage Media] 文件夹中的可用空间，请将以上三个文件夹中的所有必要数据备份到您的电脑，然后删除文件夹。若要格式化播放器的内置闪存，请参阅“初始化（格式化）播放器”。

将播放器连接到电脑之前

请确认操作系统为 Windows 7、Windows XP（Service Pack 2 或更高版本）或 Windows Vista（Service Pack 1 或更高版本），以及电脑上安装的 Windows Media Player 版本为 11 或 12。

电池充电

当播放器与正在运行的电脑连接时，播放器电池便进行充电。也可以连接适用本型号的 Sony USB 充电交流电源适配器（另购）对电池进行充电。

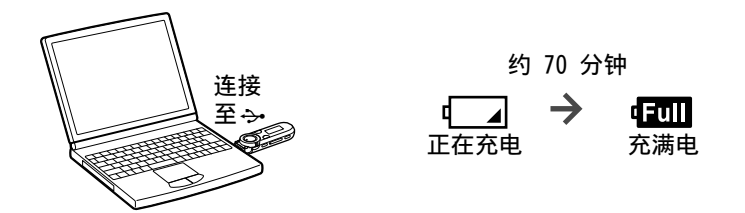

说明

- 当首次使用播放器或很长时间未使用播放器时，请将它充足电。对耗尽的电池进行充电时，电源照明器以顺时针方向闪烁，而显示屏中无内容。如果播放器的显示屏保持空白超过 5 分钟，请按 RESET 钮将播放器复位。
- 当播放器与电脑处于连接状态时，如果打开电脑、重新启动电脑、关闭电脑，或从睡眠、休眠状态恢复，则播放器可能会发生故障。在此情况下，请按播放器的 RESET 按钮复位播放器。进行这些操作之前，请断开播放器与电脑的连接。

各部分及控制按钮

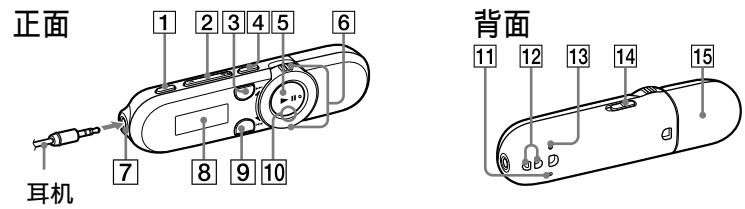

- | | |
|---|---|
| 1 REC/STOP 钮
开始/停止录音。您可使用播放器内置麦克风录制声音。您还可录制当前收听的 FM 节目（仅限 NWZ-B152F/B153F）。 | 7 耳机插孔 |
| 2 VOL +/- 钮 | 8 显示屏 |
| 3 ZAP 钮
在正常播放和 ZAPPIN 播放之间切换。ZAPPIN 播放功能将按顺序播放预设时间歌曲片段。 | 9 BACK/HOME 钮
请参阅“使用播放器的方法”。 |
| 4 BASS/PLAY MODE 钮
增强低音范围（低音功能）或改变播放模式。 | 10 电源照明器
采用 LED 照明。 |
| 5 播放/暂停按钮
开始/暂停歌曲播放或暂停/重新开始录音。 | 11 MIC（麦克风）
用于使用播放器录制声音。 |
| 6 飞梭开关
转动此开关寻找歌曲的开头，或快退/快进。当屏幕上出现菜单时，转动此开关选择菜单项目。 | 12 挂绳孔 |
| | 13 RESET 钮
用细针等。 |
| | 14 HOLD 开关
携带播放器时禁用操作钮以防止出现意外操作。 |
| | 15 USB 端口盖
当进行 USB 连接时，请取下 USB 端口盖。 |

打开和关闭播放器

打开	按 播放/暂停 钮。
关闭	按住 播放/暂停 钮。

提示

- 如果暂停歌曲播放且一段时间内无任何操作，播放器将自动关闭。

使用播放器的方法

每项应用程序都要从主菜单开始。

显示主菜单	按住 BACK/HOME 钮。
选择项目	将飞梭开关转动至 左/右 选择一个项目，然后按 播放/暂停 按钮进行确认。
返回上一个画面	按 BACK/HOME 钮。

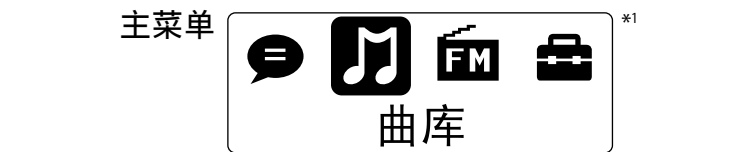

主菜单中出现的图标和所选图标的颜色会反转。

语音 [声音]	播放/删除用播放器的内置麦克风录制的声音文件。
曲库 [曲库]	播放已传送到播放器中的歌曲。
FM 调频收音 [FM 调频收音]	播放 FM 广播，或播放/删除播放器录制的 FM 广播节目。
设定 [设定]	设定音乐、FM 调频收音 ^{*1} 、录音或播放器设定的功能。

^{*1}仅 NWZ-B152F/B153F 上出现 **FM** 和与 [FM 调频收音] 相关的功能。

导入和传送音乐

您可在电脑上使用 Windows Media Player 11 或 12 将歌曲传送到播放器。如果您电脑中使用的是 Windows Media Player 10 或更低的版本，请从播放器内存中的快捷图标下载 Windows Media Player 11。

1 在电脑上将歌曲从 CD 等导入 Windows Media Player 11 或 12。

有关如何将歌曲从 CD 等导入的详细说明，请参阅 Windows Media Player 11 或 12 的帮助。您无需再次导入以前已经导入 Windows Media Player 11 或 12 的歌曲。

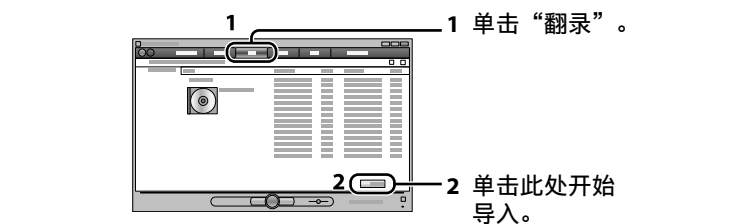

2 将播放器的 USB 接口连接到电脑。

将 USB 接口完全插入。

3 将歌曲从 Windows Media Player 11 或 12 传送到播放器。

当歌曲传送到播放器时，显示屏中出现 [数据访问]。

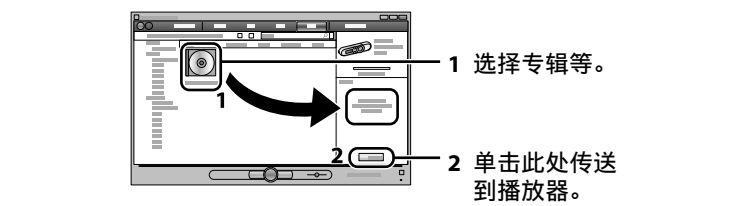

说明

- 正在传送文件时，请勿断开播放器连接。否则，正在传送的文件会被损坏。
- 由于播放器不支持，因此无法传送有版权保护的内容。

提示

- 您也可以在电脑上的 Windows Explorer 中通过拖放方式将数据传送到播放器。

删除已传送到播放器的歌曲

将播放器连接至电脑，然后使用 Windows Media Player 11、12 或 Windows Explorer 删除任何不需要的音频文件。

故障排除

如果播放器工作异常，请尝试采取以下步骤解决问题。

- 请参照使用手册（PDF 文件）的“故障排除”中的问题症状，尝试列出的解决办法。关于与电脑的连接，请参阅以下“系统要求（对于播放器）”和表格。
- 将播放器连接至电脑对电池进行充电。对电池充电可能会解决某些问题。
- 用细针等物体按 RESET 钮。如果在操作播放器时按 RESET 钮，保存在播放器中的数据 and 设定可能会被删除。重置播放器后，按 **播放/暂停** 钮开启播放器。
- 在各软件的帮助中查看问题相关信息。
- 在其中一个客户支持网站查找问题相关信息。关于客户支持网站，请参阅“有关最新信息”。
- 如果以上方法不能解决问题，请就近咨询 Sony 经销商。

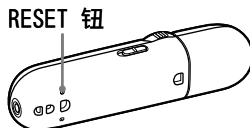

系统要求（对于播放器）

- 电脑
 - 预装了以下 Windows 操作系统^{*1}：Windows XP Home Edition（Service Pack 2 或更高版本）/ Windows XP Professional（Service Pack 2 或更高版本）/ Windows Vista Home Basic（Service Pack 1 或更高版本）/ Windows Vista Home Premium（Service Pack 1 或更高版本）/ Windows Vista Ultimate（Service Pack 1 或更高版本）/ Windows 7 Home Basic/Windows 7 Home Premium/Windows 7 Professional/Windows 7 Ultimate 不支持上述以外的操作系统。^{*1}不包括 Microsoft 不支持的操作系统版本。
 - RAM：128 MB 或以上（对于 Windows Vista，512 MB 或以上。对于 Windows 7，1 GB（32 位）/ 2 GB（64 位）或以上）
 - USB 接口（建议使用高速 USB）
 - 需要安装 Internet Explorer 6.0 或更高版本，Windows Media Player 11 或 12。
 - 使用 Electronic Music Distribution (EMD) 或访问网站需要宽带互联网连接。即使满足上述所有系统要求，也不能保证所有电脑都能正常操作。不支持下列环境：
 - 自己组装的电脑或操作系统
 - 在制造商预装操作系统基础上升级的环境
 - 支持 Windows Vista & Windows 7 64 位版本操作系统
 - 多显示器环境
 - Macintosh
- 设计和规格若有变更，恕不另行通知。

症状	原因/解决办法
播放器无法给电池充电。	<ul style="list-style-type: none">播放器未正确连接至电脑的 USB 接口。<ul style="list-style-type: none">→ 断开播放器连接，然后再重新连接。电池是在 5℃ 至 35℃ 范围以外的环境温度下充电的。<ul style="list-style-type: none">→ 出现 电池 图标时，无法对电池充电。请在 5℃ 至 35℃ 的环境温度下对电池充电。电脑未打开。<ul style="list-style-type: none">→ 打开电脑。您的电脑处于睡眠或休眠状态。<ul style="list-style-type: none">→ 断开播放器与电脑的连接，然后解除电脑的睡眠或休眠状态。将播放器重新与电脑连接。
当将播放器连接到电脑时未出现 [已连接 USB]。	<ul style="list-style-type: none">播放器的 USB 接口未正确连接至电脑的 USB 接口。<ul style="list-style-type: none">→ 断开播放器的连接，然后再重新连接。正在使用 USB 集线器。<ul style="list-style-type: none">→ 请将播放器直接连接至 USB 接口，因为通过 USB 集线器连接可能无法操作。但是，可以使用供电的 USB 集线器。电脑上正在运行其他应用程序。<ul style="list-style-type: none">→ 断开播放器的连接，等待数分钟后重新连接。如果问题仍然存在，请断开播放器的连接，重新启动电脑，然后再重新连接播放器。电脑上的 USB 接口可能有问题。将播放器的 USB 接口连接至电脑其他的 USB 接口。剩余电池电量不足。<ul style="list-style-type: none">→ 将播放器连接至正在运行的电脑至少 5 分钟来对电池充电。对耗尽的电池进行充电时，电源照明器以顺时针方向闪烁，而显示屏中无内容。
当播放器与电脑连接时，播放器变得不稳定。	<ul style="list-style-type: none">正在使用 USB 集线器。<ul style="list-style-type: none">→ 请将播放器直接连接至 USB 接口，因为通过 USB 集线器连接可能无法操作。但是，可以使用供电的 USB 集线器。

初始化（格式化）播放器

您可格式化播放器的内存。如果格式化存储器，则所有快捷方式图标和包括使用手册（PDF 文件）在内的文件将被清除，且所有设定值将返回其默认设定。在进行格式化之前必须先检查内存中存储的文件，并将需要的文件导出至电脑硬盘或其他设备。

1 按住 BACK/HOME 钮直到出现主菜单。

2 按顺序选择 **设定** - [初始化] - [格式化] - [确定]。

转动飞梭开关选择项目，然后按 **播放/暂停** 按钮进行确认。选择 [确定] 并确认之后，出现 [正在格式化...] 并开始格式化。格式化完成时，出现 [完成]。

说明

- 请勿在 Windows 资源管理器中格式化播放器的内存。如果意外在 Windows 资源管理器中格式化播放器，请重新在播放器上进行格式化。
- 如果您意外格式化了播放器的内存，请从“有关最新信息”中所述网站下载使用手册（PDF 文件）。

注意事项

关于耳机

- 请勿将音量调得太大，以免影响听力。
- 音量过大时就会听不到外面的声音。避免在听力不应受到干扰时（如驾驶或骑车）使用本机。
- 由于附带的耳机是设计成可在户外使用的，声音会透过耳机传到外面来。请注意不要打扰周围的人。

注意

为减少火灾或触电的危险，请不要让本装置淋雨或受潮。请勿将电池（安装的电池组或多个电池）长时间暴露在直射阳光、火焰或类似的过热热源附近。额定电流 500mA 锂电池用户不可自行更换，如电池损坏需要更换，请联系专业人员。

程序版权所有 ©2010 Sony Corporation
文档版权所有 ©2010 Sony Corporation

有关最新信息

如果您对 Sony 产品有疑问或问题，或需要 Sony 产品兼容项目的信息，请访问以下网站。
对于在美国的用户：<http://www.sony.com/walkmansupport>
对于在加拿大的用户：<http://www.sony.ca/ElectronicsSupport/>
对于在欧洲的用户：<http://support.sony-europe.com/DNA>
对于在拉丁美洲的用户：<http://www.sony-latin.com/index.crp>
对于在中国的用户：<http://service.sony.com.cn/KB/>
对于在其他国家/地区的用户：<http://www.sony-asia.com/support>
对于购买海外机型的用户：<http://www.sony.co.jp/overseas/support/>

制造商：索尼公司
总经销商：索尼（中国）有限公司
地址：北京市朝阳区东三环北路霞光里 18 号佳程大厦 A 座 25 层
原产地：中国