

HOME AUDIO SYSTEM

Operating Instructions

Getting Started

Disc/USB Playback

USB Transfer

Tuner

Bluetooth

Sound Adjustment

Other Operations

Additional Information

WARNING

To reduce the risk of fire or electric shock, do not expose this apparatus to rain or moisture.

To reduce the risk of fire, do not cover the ventilation opening of the appliance with newspapers, tablecloths, curtains, etc.

Do not expose the appliance to naked flame sources (for example, lighted candles).

To reduce the risk of fire or electric shock, do not expose this appliance to dripping or splashing, and do not place objects filled with liquids, such as vases, on the appliance.

As the main plug is used to disconnect the unit from the mains, connect the unit to an easily accessible AC outlet. Should you notice an abnormality in the unit, disconnect the main plug from the AC outlet immediately.

Do not install the appliance in a confined space, such as a bookcase or built-in cabinet. Do not expose batteries or appliances with battery-installed to excessive heat, such as sunshine and fire.

The unit is not disconnected from the mains as long as it is connected to the AC outlet, even if the unit itself has been turned off.

CAUTION

The use of optical instruments with this product will increase eye hazard.



This appliance is classified as a CLASS 1 LASER product. This marking is located on the rear exterior.

For customers in Australia



Disposal of Old Electrical & Electronic Equipment (Applicable in the European Union and other European countries with separate collection systems)

License and Trademark Notice

- “WALKMAN” and “WALKMAN” logo are registered trademarks of Sony Corporation.
- MPEG Layer-3 audio coding technology and patents licensed from Fraunhofer IIS and Thomson.
- Windows Media is either a registered trademark or trademark of Microsoft Corporation in the United States and/or other countries.
- This product is protected by certain intellectual property rights of Microsoft Corporation. Use or distribution of such technology outside of this product is prohibited without a license from Microsoft or an authorized Microsoft subsidiary.
- The *Bluetooth*[®] word mark and logos are registered trademarks owned by Bluetooth SIG, Inc. and any use of such marks by Sony Corporation is under license. Other trademarks and trade names are those of their respective owners.
- The N Mark is a trademark or registered trademark of NFC Forum, Inc. in the United States and in other countries.
- Android[™] is a trademark of Google Inc.
- Google Play[™] is a trademark of Google Inc.

- iPhone and iPod touch are trademarks of Apple Inc., registered in the U.S. and other countries. App Store is a service mark of Apple Inc.
- “Made for iPod” and “Made for iPhone” mean that an electronic accessory has been designed to connect specifically to iPod or iPhone, respectively, and has been certified by the developer to meet Apple performance standards. Apple is not responsible for the operation of this device or its compliance with safety and regulatory standards. Please note that the use of this accessory with iPod or iPhone may affect wireless performance.
- All other trademarks and registered trademarks are of their respective holders. In this manual, TM and © marks are not specified.

Table of Contents

Guide to parts and controls..... 5

Getting Started

Hooking up the system
securely..... 8
Setting the clock 9
Changing the display mode 9

Disc/USB Playback

Playing a disc..... 10
Before using a USB
device with this system..... 10
Playing a USB device..... 11
Using play mode..... 11

USB Transfer

Transferring music..... 13

Tuner

Listening to the radio..... 15

Bluetooth

About the *Bluetooth* wireless
technology 16
Setting the *Bluetooth*
audio codecs 16
Connecting a smartphone
with one touch (NFC)..... 17
Listening to music wirelessly
on a *Bluetooth* device 18
Setting the *Bluetooth* standby
mode 19
Setting the *Bluetooth* signal..... 20
Using “SongPal” via
Bluetooth 20

Sound Adjustment

Adjusting the sound 21
Creating your own sound
effect 21
Creating a party atmosphere
(DJ EFFECT)..... 21

Other Operations

Viewing information in the
display panel 22
Setting the illumination 22
Using the timers..... 23
Using optional equipment..... 23
Deactivating the buttons on the
unit (Child Lock) 24
Setting the automatic standby
function 24

Additional Information

Playable discs 25
Websites for compatible
devices 25
Troubleshooting..... 26
Messages..... 30
Precautions..... 30
Specifications..... 32

Guide to parts and controls

This manual mainly explains operations using the remote control, but the same operations can also be performed using the buttons on the unit having the same or similar names.

Unit

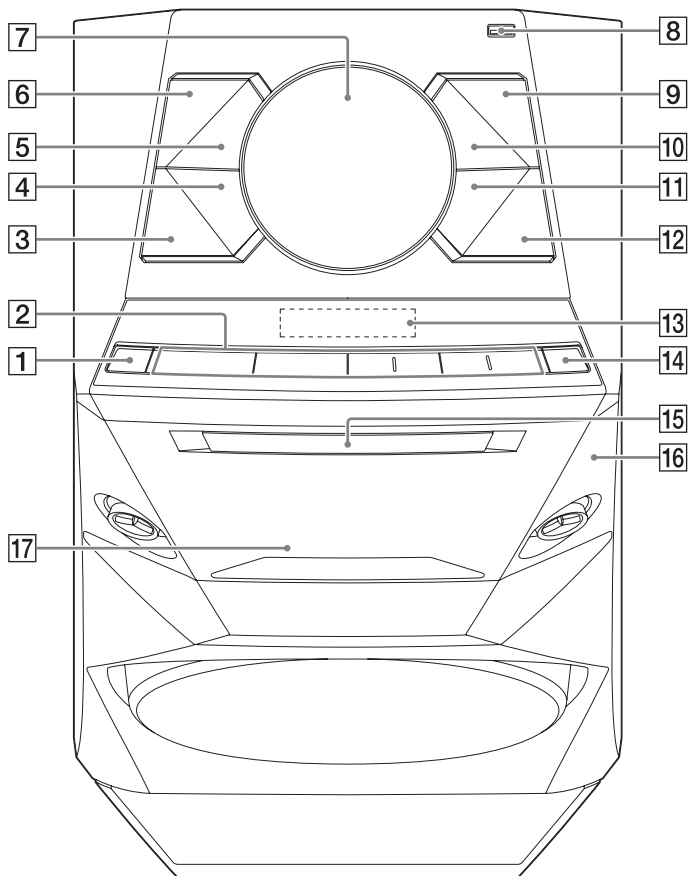

Note

When pressing the buttons on the unit, press on the printings of the buttons.

Remote control RM-SCU37B

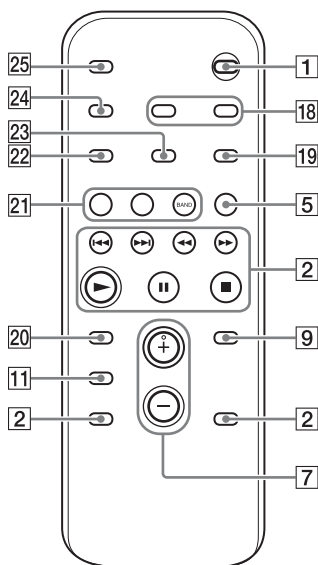

1 I/O (on/standby)

Turn on the system, or set it to standby mode.

2 Unit: ▶|| (play/pause)

Remote control: ▶ (play), || (pause)

Start or pause playback.

To resume playback, press ▶|| or ▶.

■ (stop)

Stop playback.

Press twice to cancel resume playback of the USB device. Stop the music transfer.

◀◀/▶▶ (rewind/fast forward)

Hold down to find a point in a track or file during playback.

Unit: ◀◀/▶▶ (go back/go forward)

Remote control: ◀◀/▶▶ (go back/go forward)

Select a track or file.

Unit: TUNING +/-

Remote control: +/- (tuning)

Tune to the station you want during TUNER function.

Unit: +/- (select folder)

Select a folder on an MP3 disc or a USB device.

Unit: ▲/▼/◀/▶

Select the menu items.

3 OPTIONS

Enter or exit options menu.

4 DJ EFFECT (page 21)

Select the DJ EFFECT type.

5 FUNCTION

Select a function.

6 BLUETOOTH (page 16, 18, 19)

Press to select *Bluetooth* function.

Hold down to activate *Bluetooth* pairing during *Bluetooth* function.

7 Unit: VOLUME/DJ CONTROL

Adjust the volume.

Adjust the DJ EFFECT level (page 21).

You cannot use this knob to adjust the volume when the DJ EFFECT is activated.

Remote control: VOLUME +/-*

Adjust the volume.

* The VOLUME + button has a tactile dot. Use the tactile dot as a reference when operating the system.

8 USB (REC/PLAY) port

Connect a USB device.

9 ENTER

Enter the settings.

10 REC TO USB

Transfer music from a disc to the connected USB device.

11 EQ (page 21)

Select the preset sound effect.

12 BASS BAZUCA (page 21)

Press to reinforce the bass sound (BASS BAZUCA effect).
Hold down to reduce the bass sound (BASS CUT effect).

13 Display panel

14 ▲ (open/close)

Open or close the disc tray.

15 Disc tray

16  (N-Mark) (page 17)

Near Field Communication (NFC) touchpoint indication.

17 Remote control sensor

18 CLOCK/TIMER SELECT

(page 23)

CLOCK/TIMER SET (page 9, 23)

Set the clock and the Play Timer.

19 REPEAT/FM MODE

Listen to a disc, a USB device, a single track or file repeatedly (page 12).
Select the FM reception mode (monaural or stereo) (page 15).

20 CLEAR

Delete the last step from the program list.

21 USB

Select the USB function.

CD

Select the CD function.

TUNER/BAND

Select the TUNER function.

22 TUNER MEMORY (page 15)

Preset the radio station.

23 PLAY MODE/TUNING MODE

Select the play mode of an AUDIO CD, MP3 disc or a USB device (page 11).
Select the tuning mode (page 15).

24 DISPLAY

Change the information on the display panel.

25 SLEEP (page 23)

Set the Sleep Timer.

Hooking up the system securely

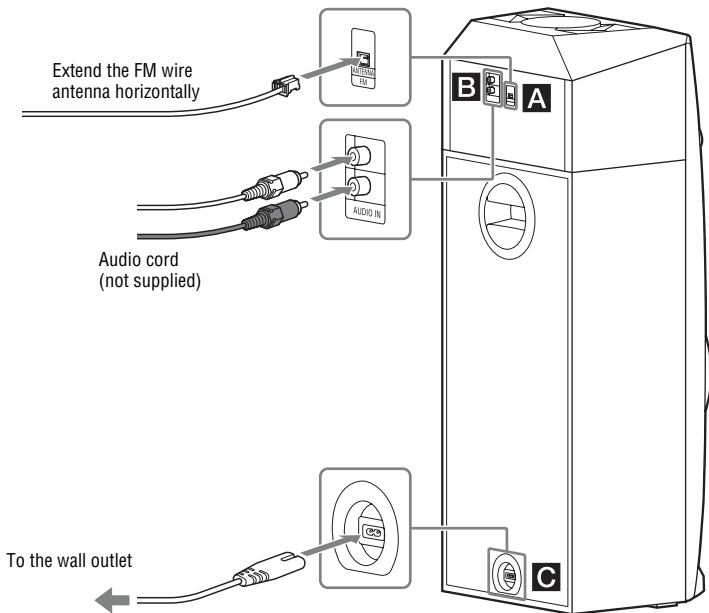

A FM ANTENNA jack

Find a location and an orientation that provide good reception when you set up the antennas.

Keep the antennas away from the AC power cord and the USB cable to avoid picking up noise.

B AUDIO IN L/R jacks

Use an audio cord (not supplied) to connect to the audio output jacks of an optional equipment (such as TV or an audio/video equipment). The sound is output through this system.

C Power

Connect the AC power cord (supplied) to the system, then plug it into a wall socket. The demonstration appears in the display panel. Press **I/⏻** to turn on the system and the demonstration automatically ends. If the supplied adaptor on the plug does not fit your wall outlet, detach it from the plug (only for models equipped with an adaptor).

Inserting batteries

Insert the two supplied R6 (size AA) batteries, matching the polarities as shown below.

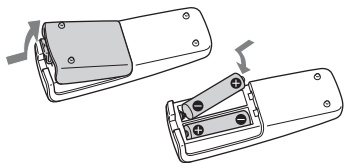

Notes

- Do not mix an old battery with a new one or mix different types of batteries.
- If you do not use the remote control for a long period of time, remove the batteries to avoid damage from battery leakage and corrosion.

Setting the clock

You cannot set the clock in Power Saving Mode.

1 Press **I/⏻** to turn on the system.

2 Press **CLOCK/TIMER SET**.

If “PLAY SET” appears in the display panel, press **◀◀/▶▶** repeatedly to select “CLOCK”, then press **ENTER**.

3 Press **◀◀/▶▶** repeatedly to set the hour, then press **ENTER**.

4 Press **◀◀/▶▶** repeatedly to set the minutes, then press **ENTER**.

Changing the display mode

The demonstration appears in the display panel once you plug the AC power cord into a wall socket.

Press DISPLAY repeatedly while the system is turned off.

Demonstration

The display changes even when the system is turned off.

No display (Power Saving Mode)

The display is turned off to conserve power. The timer and clock continue to work internally.

Clock

The clock display automatically turns to Power Saving Mode after a few seconds.

Playing a disc

- 1 Press **CD**.
- 2 Press **▲** on the unit.
- 3 Load a disc with the label side facing up on the disc tray.

When you play back an 8 cm disc such as a CD single, place it on the inner circle of the tray

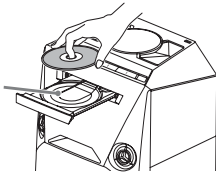

- 4 Press **▲** on the unit to close the disc tray.

Do not forcibly push the disc tray to close it as this may cause a malfunction.

- 5 Press **▶** to start playback.

Notes on disc

- (For AUDIO CD) This system can recognize up to 99 tracks.
- (For MP3 discs) This system can recognize up to
 - 999 folders (including root and empty folders).
 - 999 MP3 files.
 - 250 MP3 files in a folder.
 - 8 folders levels (tree structure of files).
- CD-TEXT information is not supported.

Before using a USB device with this system

Check the information on the website about compatible USB devices (page 25).

To select the playback source or transfer destination (USB Memory Select)

If the USB device has more than one memory (for example, an internal memory and a memory card), you can select which memory to use as a playback source or transfer destination.

Note

You cannot select a memory during playback or transfer. Make sure to select a memory before starting playback or transfer.

Use the buttons on the unit to perform this operation.

- 1 Press **FUNCTION** repeatedly to select USB function.
- 2 Connect a USB device to the ψ port.
- 3 Press **OPTIONS** when playback is stopped.
- 4 Press **▲/▼** repeatedly to select “MEM SEL”, then press **ENTER**.
- 5 Press **▲/▼** repeatedly to select the memory you want, then press **ENTER**.

To exit the options menu, press **OPTIONS**.

Playing a USB device

The audio formats that can be played back by this system are as follows:

- MP3: file extension “.mp3”
- WMA: file extension “.wma”
- AAC: file extension “.m4a”, “.mp4” or “.3gp”

If the audio files have the above file extension but are not the respective formats, the system may produce noise or may malfunction.

1 Press **USB**.

2 Connect a USB device to the port.

Note

You can use your iPhone/iPod with this system via *Bluetooth* connection only.

3 Press to start playback.

The audio files are played back in different orders depending on the play mode (page 11).

Note on the USB device

- This system can recognize up to
- 1,000 folders in a USB device (including root and empty folders).
 - 3,000 audio files in a USB device.
 - 250 audio files in a folder.

Using play mode

Playing in original order (Normal Play)

Press **PLAY MODE** repeatedly when playback is stopped.

- (blank): play a disc or a USB device
- **FLDR***: play all audio files in the specified folder on the disc or the USB device

* When playing an AUDIO CD, “FLDR” performs the same operation as Normal Play mode.

Playing in random order (Shuffle Play)

Press **PLAY MODE** repeatedly when playback is stopped.

- **SHUF**: shuffle all audio files on a disc or a USB device
- **FLDR SHUF***: shuffle all audio files in the specified folder on the disc or the USB device

* When playing an AUDIO CD, “FLDR SHUF” performs the same operation as “SHUF” play mode.

Note

When you turn off the system, the selected Shuffle Play is cleared and the play mode returns to Normal Play.

Creating your own program (Program Play)

You can make a program of up to 25 steps in the order you want them to be played back.

1 For CD function:

Press CD.

For USB function:

Press USB.

2 When playback is stopped, press PLAY MODE repeatedly until "PGM" lights up in the display panel.

3 (Audio files only)

Press  +/- repeatedly to select a folder.

If you want to program all files in the folder, press ENTER.

4 Press repeatedly to select the track or audio file you want, then press ENTER.

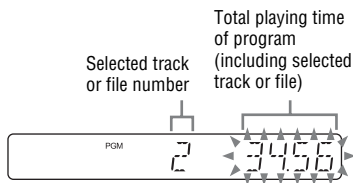

"--:--" appears when the total playing time exceeds 100 minutes for an AUDIO CD or when you program an audio file.

5 Repeat steps 3 to 4 to program additional tracks or audio files.

6 Press to start Program Play.

To delete the last step from the program list

Press CLEAR when playback is stopped.

To cancel Program Play



When playback is stopped, press PLAY MODE repeatedly until "PGM" disappears from the display panel.

Notes

- (CD function only) The program list is cleared when you open the disc tray.
- (USB function only) The program list is cleared when you:
 - perform the erase operation.
 - remove the USB device.
 - change the selected USB memory.

Playing repeatedly (Repeat Play)

Press REPEAT repeatedly.

-  : repeat all tracks or audio files on a folder/disc/USB device/program
-  1 : repeat a track or audio file

Note on the USB device

The playback order for the system may differ from the playback order of the connected digital music player.

Transferring music

You can transfer music from a disc (AUDIO CD or MP3 disc only) to a USB device.

The audio format of files transferred by this system is MP3.

Notes

- Do not remove the USB device during transfer or erase operations. Doing so may corrupt the data on the USB device or damage the USB device itself.
- MP3 files are transferred with the same bit rate as the original files.
- USB transfer and erase operations are disabled while the disc tray is open.

Note on copyright-protected content

The transferred music is limited to private use only. Use of the music beyond this limit requires permission of the copyright holders.

To select the playback source or transfer destination (USB Memory Select)

See page 10.

To select the bit rate

You can select a higher bit rate when you want to transfer music from an AUDIO CD.

Use the buttons on the unit to perform this operation.

- 1 Press **OPTIONS**.
- 2 Press **▲/◆** repeatedly to select "BIT RATE", then press **ENTER**.
- 3 Press **▲/◆** repeatedly to select the bit rate you want, then press **ENTER**.

- 128 KBPS: encoded MP3 files have smaller file size and lower audio quality.
- 256 KBPS: encoded MP3 files have bigger file size but higher audio quality.

To exit the options menu, press **OPTIONS**.

Transferring music from a disc

You can easily transfer all the music on a disc to USB device (Synchronized Transfer). You can also transfer a single track or audio file during playback (REC1 Transfer).

- 1 **Connect a USB device to the USB port.**
- 2 **Press CD, then load the disc.**
- 3 **For Synchronized Transfer:**

When playback is stopped, press **PLAY MODE** repeatedly to select the play mode you want.

Notes

- If you start transferring in Shuffle Play ("FLDR SHUF"), the selected play mode changes to "FLDR" automatically.
- If you start transferring in Shuffle Play (except "FLDR SHUF"), Repeat Play or Program Play with no steps, the selected play mode changes to Normal Play automatically.

For REC1 Transfer:

Select the track or audio file you want to transfer, then start playback.

- 4 **Press REC TO USB on the unit.**
"PUSH ENTER" appears in the display panel.
- 5 **Press ENTER.**

The transfer starts when "DO NOT REMOVE" appears in the display panel.

For Synchronized Transfer:

When the transfer is completed, the disc and the USB device stop automatically.

For REC1 Transfer:

When the transfer is completed, the disc continues to play.

To stop transfer

Press ■.

Erasing audio files or folders from a USB device

- 1 Press USB when playback is stopped.**
- 2 Press \lll / \ggg or \square +/- repeatedly to select the audio file or folder.**
- 3 Press OPTIONS on the unit.**
- 4 Press \uparrow / \downarrow on the unit repeatedly to select "ERASE", then press ENTER.**
"FOLDER ERASE" or "TRACK ERASE" appears in the display panel.
- 5 Press ENTER.**
"COMPLETE" appears in the display panel.
To exit the options menu, press OPTIONS on the unit.

Note

You cannot erase audio files or folders when Shuffle Play or Program Play has been selected. Set the play mode to Normal Play before erasing.

Folder and file generation rules

When transferring to a USB device, a "MUSIC" folder is created directly below "ROOT". Folders and files are generated within this "MUSIC" folder according to the transfer method and source as follows:

Synchronized Transfer

Source	Folder name	File name
Audio files	Same as the source	
AUDIO CD	"CDDA0001"*	"TRACK001"*

REC1 Transfer

Source	Folder name	File name
Audio files	"REC1-MP3"	Same as the source
AUDIO CD	"REC1-CD"	"TRACK001"*

* Folder and file numbers are assigned serially thereafter.

Notes on transfer

- While transferring, no sound is output.
- CD-TEXT information is not transferred to the created MP3 files.
- The transfer stops automatically if:
 - the USB device runs out of space during transfer.
 - the number of audio files or folders on the USB device reaches the limit that the system can recognize (page 11).
- If a folder or file that you are trying to transfer already exists on the USB device with the same name, a sequential number is added after the name without overwriting the original folder or file.
- You cannot perform the following operations during transfer:
 - Eject the disc.
 - Select another track or file.
 - Pause playback or find a point in the track or file.
 - Change the function.
- When transferring music to a Walkman® using "Media Manager for WALKMAN", be sure to transfer in MP3 format.
- When connecting a Walkman® to the system, be sure to connect after the display "Creating Library" or "Creating Database" on the Walkman® has disappeared.

Listening to the radio

1 Press **TUNER/BAND** to select **FM band**.

2 For automatic scanning:

Press **TUNING MODE** repeatedly to select **"AUTO"**. Then, press **+/-**. Scanning stops automatically when a station is tuned in. **"ST"** (for FM stereo programs only) lights up in the display panel.

If scanning does not stop, press **■** to stop scanning. Then, perform manual tuning (below).

For manual tuning:

Press **TUNING MODE** repeatedly to select **"MANUAL"**. Then, press **+/-** repeatedly to tune to the station you want.

Note

When you tune to an FM station that provides RDS services, information such as the service name or station name is provided by broadcasts. You can check the RDS information by pressing **DISPLAY** repeatedly.

Tip

To reduce static noise on a weak FM stereo station, press **FM MODE** repeatedly to select **"MONO"**.

Presetting radio stations

You can store up to 20 FM stations as your favorite stations.

1 Tune to the station you want.

2 Press **TUNER MEMORY**.

Preset number



3 Press **+/-** repeatedly to select the preset number you want, then press **ENTER**.

"COMPLETE" appears in the display panel. The station is stored.

To tune to a preset station

Press **TUNING MODE** repeatedly to select **"PRESET"**. Then, press **+/-** repeatedly to select the preset number you want.

About the *Bluetooth* wireless technology

Bluetooth wireless technology is a short-range wireless technology that enables wireless data communication between digital devices. *Bluetooth* wireless technology operates within a range of about 10 meters.

Supported *Bluetooth* version, profiles and codecs

Supported *Bluetooth* version:

- *Bluetooth* Standard version 3.1

Supported *Bluetooth* profiles:

- A2DP (Advanced Audio Distribution Profile)
- AVRCP 1.3 (Audio Video Remote Control Profile)
- SPP (Serial Port Profile)

Supported *Bluetooth* codecs:

- SBC (Sub Band Codec)
- AAC (Advanced Audio Coding)

About the BLUETOOTH indicator

The BLUETOOTH indicator lights up or flashes in blue to show the *Bluetooth* status.

System status	Indicator status
<i>Bluetooth</i> standby	Flashes slowly
<i>Bluetooth</i> pairing	Flashes quickly
<i>Bluetooth</i> connection is established	Lights up

Setting the *Bluetooth* audio codecs

You can receive data in AAC codec format from a *Bluetooth* device. Use the buttons on the unit to perform this operation.

1 Press **BLUETOOTH** to select *Bluetooth* function.

“BT AUDIO” appears in the display panel.

2 Press **OPTIONS**.

3 Press **▲/▼** repeatedly to select “BT AAC”, then press **ENTER**.

4 Press **▲/▼** repeatedly to select “ON” or “OFF”, then press **ENTER**.

- ON: Enable reception in AAC codec format.
- OFF: Receive in SBC codec format.

To exit the options menu, press **OPTIONS**.

Notes

- You can enjoy high quality sound if the AAC is selected. In case you cannot listen to AAC sound from your device, select “OFF”.
- If you change this setting while the system is connected to a *Bluetooth* device, the *Bluetooth* device will be disconnected. To connect to the *Bluetooth* device, perform the *Bluetooth* connection again.
- If the sound is interrupted in AAC codec format, select “OFF” to cancel the setting. In this case, the system receives SBC codec.

Connecting a smartphone with one touch (NFC)

What is “NFC”?

NFC (Near Field Communication) is a technology enabling short-range wireless communication between various devices, such as smartphones and IC tags. Thanks to the NFC function, data communication can be achieved easily just by touching the designated touchpoint on the NFC-compatible devices.

When you touch the system with an NFC-compatible smartphone, the system automatically:

- turns on in *Bluetooth* function.
- completes pairing.
- completes the *Bluetooth* connection.

1 Download and install the “NFC Easy Connect” app.

Download the free Android app from Google Play by searching for “NFC Easy Connect” or access it by using the two-dimensional code below. Data communication fees may be charged.

Two-dimensional code* for direct access

* Use a two-dimensional code reader app.



Notes

- The app may not be available in some countries/regions.

- Depending on your smartphone, you can use the NFC function without installing the app. In this case, the operations and specifications may differ. For details, refer to the operating instructions of your smartphone.

Compatible smartphones

Smartphones with a built-in NFC function (OS: Android 2.3.3 or later, excluding Android 3.x)

2 Start the “NFC Easy Connect” app on the smartphone.

Make sure that the app screen is displayed.

3 Touch the smartphone to the N-Mark on the system until the smartphone vibrates.

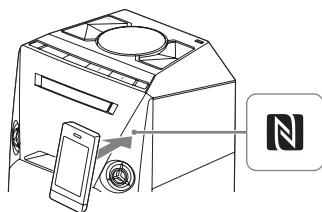

Complete the connection by following the instructions displayed on the smartphone.

When the *Bluetooth* connection is established, the BLUETOOTH indicator stops flashing and remains light up. *Bluetooth* device name appears in the display panel.

You can switch the sound source from the smartphone to another NFC-compatible *Bluetooth* device.

For details, refer to the operating instructions of your *Bluetooth* device.

Tip

If pairing and the *Bluetooth* connection fail, do the following.

- Relaunch “NFC Easy Connect” and move the smartphone slowly over the N-Mark.
- Remove the case from the smartphone if using a commercially available smartphone case.

To play music from the smartphone

Start playing of an audio source on the smartphone. For details on playback, refer to the operating instructions of your smartphone.

To disconnect the smartphone

Touch the smartphone to the N-Mark on the system again.

Listening to music wirelessly on a *Bluetooth* device

You can listen to music from your *Bluetooth* device over a wireless connection.

Check the information on the website about compatible *Bluetooth* devices (page 25).

Pairing this system with a *Bluetooth* device

Pairing is an operation where *Bluetooth* devices register with each other beforehand. Once a pairing operation is performed, it does not need to be performed again. If your device is an NFC-compatible smartphone, the manual pairing procedure is not necessary.

1 Place the *Bluetooth* device within 1 meter from the system.

2 Press **BLUETOOTH on the unit to select *Bluetooth* function.**

“BT AUDIO” appears in the display panel.

Note

If the system is connected to a *Bluetooth* device, press **BLUETOOTH** to disconnect the *Bluetooth* device.

3 Hold down **BLUETOOTH on the unit for 2 seconds or more.**

“PAIRING” flashes in the display panel.

4 Perform the pairing procedure on the *Bluetooth* device.

For details, refer to the operating instructions of your *Bluetooth* device.

5 Select “SONY:MHC-V3” on the display of the *Bluetooth* device.

If passkey is required on the *Bluetooth* device, enter “0000”.

6 Perform the *Bluetooth* connection on the *Bluetooth* device.

When pairing is completed and the *Bluetooth* connection is established, *Bluetooth* device name appears in the display panel.

Depending on the *Bluetooth* device, connection may start automatically after pairing is completed.

You can check the *Bluetooth* device address by pressing **DISPLAY** repeatedly.

Notes

- You can pair up to 9 *Bluetooth* devices. If the 10th *Bluetooth* device is paired, the oldest paired device will be deleted.
- “Passkey” may be called “Passcode”, “PIN code”, “PIN number” or “Password”, etc., depending on the device.
- The pairing standby status of the system is canceled after about 5 minutes. If pairing is not successful, repeat from step 1.
- If you want to pair with another *Bluetooth* device, repeat steps 1 to 6.

To cancel the pairing operation

Hold down **BLUETOOTH** on the unit for 2 seconds or more until “BT AUDIO” appears in the display panel.

Playing music from a Bluetooth device

You can operate a *Bluetooth* device by connecting the system and the *Bluetooth* device using AVRCP.

Check the following before playing music:

- The *Bluetooth* function of the *Bluetooth* device is turned on.
- Pairing has been completed.

1 Press **BLUETOOTH** on the unit to select *Bluetooth* function.

“BT AUDIO” appears in the display panel.

2 Establish connection with the *Bluetooth* device.

Press **BLUETOOTH** on the unit to connect to the last connected *Bluetooth* device.

Perform the *Bluetooth* connection from the *Bluetooth* device if the device is not connected.

Once the connection is established, the *Bluetooth* device name appears in the display panel.

3 Press **▶** to start playback.

Depending on the *Bluetooth* device,
– you may need to press **▶** twice.
– you may need to start playing an audio source on the *Bluetooth* device.

Notes

- When the system is not connected to any *Bluetooth* device, the system will connect to the last connected *Bluetooth* device automatically when you press **▶**.
- If you try to connect another *Bluetooth* device to the system, the current connected *Bluetooth* device will be disconnected.

To disconnect the *Bluetooth* device

Press **BLUETOOTH** on the unit.

“BT AUDIO” appears in the display panel.

Depending on the *Bluetooth* device, the *Bluetooth* connection may be canceled automatically when you stop playback.

Erasing all the pairing registration information

Use the buttons on the unit to perform this operation.

1 Press **BLUETOOTH** to select *Bluetooth* function.

“BT AUDIO” appears in the display panel.

If the system is connected to a *Bluetooth* device, the *Bluetooth* device name appears in the display panel.

Press **BLUETOOTH** to disconnect the *Bluetooth* device.

2 Hold down **■** and **DJ EFFECT** for about 3 seconds.

“BT HIST CLEAR” appears in the display panel and all the pairing information is erased.

Setting the *Bluetooth* standby mode

The *Bluetooth* standby mode enables the system to turn on automatically when you establish the *Bluetooth* connection from a *Bluetooth* device.

Use the buttons on the unit to perform this operation.

1 Press **OPTIONS**.

2 Press **↑/↓** repeatedly to select “BT STBY”, then press **ENTER**.

3 Press \uparrow/\downarrow repeatedly to select “ON” or “OFF”, then press ENTER.

4 Press I/⏻ to turn off the system.

When the *Bluetooth* standby mode is set to on, the system waits for a *Bluetooth* connection even when the system has been turned off. When a *Bluetooth* connection is established, the system turns on automatically.

Setting the *Bluetooth* signal

You can connect to the system from a paired *Bluetooth* device in all functions when *Bluetooth* signal is set to on. The *Bluetooth* signal is turned on by default. Use the buttons on the unit to perform this operation.

Hold down ■ and □ + for about 3 seconds.

“BT ON” or “BT OFF” appears in the display panel.

Notes

- You cannot perform the following operations when *Bluetooth* signal is set to off:
 - Pairing with *Bluetooth* device
 - Erasing the pairing information
 - Using “SongPal” via *Bluetooth*
- When the *Bluetooth* signal is set to off, this system cannot be detected and connection cannot be established from *Bluetooth* device.
- If you touch the system with an NFC-compatible smartphone or set the *Bluetooth* standby mode to on, the *Bluetooth* signals will set to on automatically.

Using “SongPal” via *Bluetooth*

About App

A dedicated app for this model is available on both Google Play and App Store. Search for “SongPal” and download the free app to find out more about the convenient features.

Bluetooth technology works with iPhone 5s, iPhone 5c, iPhone 5, iPhone 4s, iPhone 4, iPhone 3GS, iPod touch (5th generation), iPod touch (4th generation).

Sound Adjustment

Adjusting the sound

To	Do this
Reinforce the bass and create a more powerful sound	Press BASS BAZUCA on the unit.
Reduce the bass sound (BASS CUT)	Hold down BASS BAZUCA on the unit for 2 seconds or more. To cancel the BASS CUT effect, press BASS BAZUCA again.
	Notes <ul style="list-style-type: none">• When BASS CUT effect is turned on, “BASS CUT” appears in the display panel every 10 seconds.• The BASS CUT effect is turned off automatically when you turn off the system.
Select a preset sound effect	Press EQ repeatedly. To cancel preset sound effect, press EQ repeatedly to select “FLAT”.

Creating your own sound effect

You can raise or lower the levels of specific frequency bands, then store the setting in the memory as “CUSTOM EQ”. Use the buttons on the unit to perform this operation.

- 1 Press **OPTIONS**.
- 2 Press **↑/↓** repeatedly to select “EQ EDIT”, then press **ENTER**.

- 3 Press **↑/↓** repeatedly to adjust the equalizer level, then press **ENTER**.

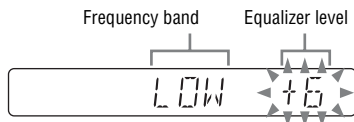

- 4 Repeat step 3 to adjust the level of other frequency bands and surround effect.

To exit the options menu, press **OPTIONS**.

To select the custom equalizer setting

Press **EQ** repeatedly to select “CUSTOM EQ”.

Creating a party atmosphere

(DJ EFFECT)

Use the buttons on the unit to perform this operation.

- 1 Press **DJ EFFECT** repeatedly to select the effect type.

- **ISOLATOR**: Isolate a specific frequency band by adjusting the other frequency bands. For example, when you want to focus on vocals.
- **FLANGER**: Create a deep flanging effect that is similar to the roar of a jet plane.
- **WAH**: Create a special effect of “Wah-wah” sound by moving the frequency of a filter up and down automatically.

- 2 Turn **DJ CONTROL** to adjust the effect level.

To turn off the effect

Press DJ EFFECT repeatedly to select “DJ OFF”.

Notes

- The DJ EFFECT is automatically turned off when you turn off the system or change the function.
- If you activate the DJ EFFECT during transfer, the sound effect will not be transferred to the USB device.
- You cannot use VOLUME/DJ CONTROL on the unit to adjust the volume when the DJ EFFECT is activated. Press VOLUME +/- on the remote control to adjust the volume.

Other Operations

Viewing information in the display panel

Press DISPLAY repeatedly when the system is turned on.

You can view the information as follows:

- For AUDIO CD:
 - The elapsed playing time and remaining playing time during playback.
 - The total playing time when playback is stopped.
- For audio files:
 - The elapsed playing time, file name and folder name.
 - The title, artist and album information.

Note

The elapsed playing time of an audio file encoded using a VBR (variable bit rate) is not displayed correctly.

Setting the illumination

Use the buttons on the unit to perform this operation.

- 1** Press **OPTIONS**.
- 2** Press **▲/▼** repeatedly to select “LED SPK”, then press **ENTER**.
- 3** Press **▲/▼** repeatedly to select “ON” or “OFF”, then press **ENTER**.

To exit the options menu, press **OPTIONS**.

Note

If the illumination is glaring, switch on the room lights or turn off the illumination.

Using the timers

The system offers two timer functions. If you use both timers, the Sleep Timer has priority.

Sleep Timer

You can fall asleep while listening to music. The system turns off after the preset time.

Press SLEEP repeatedly.

To cancel Sleep Timer, press SLEEP repeatedly to select "OFF".

Tip

To check the remaining time before the system turns off, press SLEEP.

Play Timer

Make sure you have set the clock. You can wake up to disc, tuner or USB device at a preset time.

1 Prepare the sound source, then press VOLUME +/- to adjust the volume.

To start from a specific track or file, create your own program (page 12).

2 Press CLOCK/TIMER SET.

3 Press ◀▶ repeatedly to select "PLAY SET", then press ENTER.

4 Set the time to start playback.

Press ◀▶ repeatedly to set the hour/minute, then press ENTER.

5 Use the same procedure as in step 4 to set the time to stop playback.

6 Press ◀▶ repeatedly to select the sound source you want, then press ENTER.

7 Press I/⏻ to turn off the system.

Note

If the system remains on, the timers will not take effect.

To check the timer setting or activate the timer again

Press CLOCK/TIMER SELECT, press ◀▶ repeatedly to select "PLAY SEL", then press ENTER.

To cancel the timer

Press CLOCK/TIMER SELECT, press ◀▶ repeatedly to select "OFF", then press ENTER.

Notes

- The system turns on before the preset time. If the system is turned on at the preset time or if "STANDBY" flashes in the display panel, the Play Timer will not play.
- Do not operate the system from the time the system turns on until the playback starts.

Using optional equipment

1 Press VOLUME – repeatedly until "VOL MIN" appears in the display panel.

2 Connect an optional equipment to AUDIO IN L/R jacks.

3 Press FUNCTION repeatedly to select the AUDIO IN function.

4 Start playing the connected equipment.

5 Press VOLUME + repeatedly to adjust the volume.

Note

The system may enter standby mode automatically if the volume level of the connected equipment is too low. Adjust the volume level of the equipment. To turn off automatic standby function, see “Setting the automatic standby function” (page 24).

Deactivating the buttons on the unit

(Child Lock)

You can deactivate the buttons on the unit (except I/⏻) to prevent misoperation, such as child mischief.

Hold down ■ on the unit for more than 5 seconds.

“CHILD LOCK ON” appears in the display panel.

You can only operate the system using the buttons on the remote control.

To cancel, hold down ■ on the unit for more than 5 seconds until “CHILD LOCK OFF” appears in the display panel.

Note

Child Lock function will be canceled when you disconnect the AC power cord.

Setting the automatic standby function

This system is equipped with an automatic standby function. With this function, the system enters standby mode automatically in about 15 minutes when there is no operation or audio signal output.

By default, the automatic standby function is turned on.

Use the buttons on the unit to perform this operation.

1 Press **OPTIONS**.

2 Press **▲/▼** repeatedly to select “AutoSTBY”, then press **ENTER**.

3 Press **▲/▼** repeatedly to select “ON” or “OFF”, then press **ENTER**.

To exit the options menu, press **OPTIONS**.

Notes

- The message “AutoSTBY” flashes in the display about 2 minutes before entering standby mode.
- The automatic standby function does not work during tuner function.
- The system may not enter standby mode automatically in the following cases:
 - when an audio signal is detected.
 - during playback of audio files.
 - while the preset Play Timer or Sleep Timer is in process.

Playable discs

- AUDIO CD
- CD-R/CD-RW
 - audio data
 - MP3 files that conform to ISO9660 Level 1/Level 2, or Joliet (expansion format).

Notes

- MP3 (MPEG 1 Audio Layer-3) is a standard format defined by ISO (International Organization for Standardization) which compresses audio data. MP3 files must be in MPEG 1 Audio Layer-3 format.
- The system can only play back MP3 files that have a file extension of “.mp3”.

Discs that cannot be played back

- CD-ROM
- CD-R/CD-RW which has the following conditions:
 - Recorded in MP3 PRO format
 - Recorded in multisession that was not ended by “closing the session”
 - Recorded with an incompatible recording device
 - Poor recording quality
 - Scratched or dirty
 - Finalized incorrectly
- Discs of non-standard shape (e.g., heart, square, star, etc.)
- Discs that have adhesive tape, paper, or sticker attached to them
- Rental or used discs with attached seals where the glue extends beyond the seal
- Discs that have labels printed using ink that feels tacky when touched

Note on DualDiscs

A DualDiscs is a two sided disc product which mates DVD recorded material on one side with digital audio material on the other side. However, since the audio material side does not conform to the Compact Disc (CD) standard, playback on this product is not guaranteed.

Music discs encoded with copyright protection technologies

This product is designed to play back discs that conform to the Compact Disc (CD) standard. Recently, various music discs encoded with copyright protection technologies are marketed by some record companies. Please be aware that among those discs, there are some that do not conform to the CD standard and may not be playable by this product.

Notes on playing multisession discs

- This system can play back multisession discs when an MP3 file is contained in the first session. Any subsequent MP3 files recorded in later sessions can also be played back (If later sessions contain AUDIO CD format, the system cannot play back these multisession discs).
- If the first session is recorded in AUDIO CD format, only the first session will be played back.

Websites for compatible devices

Check the websites below for the latest information about compatible USB devices and *Bluetooth* devices.

For customers in Latin America:

<<http://esupport.sony.com/LA>>

For customers in other countries/regions:

<<http://www.sony-asia.com/support>>

Troubleshooting

Should you encounter a problem with your system, find your problem in the troubleshooting checklist below and take the corrective action.

If the problem persists, consult your nearest Sony dealer.

Note that if the service personnel changes some parts during repair, these parts may be retained.

If “PROTECTX” (X is a number) appears in the display panel

Immediately unplug the AC power cord, and check the following items.

- Is the USB port short-circuited?
- Is anything blocking the ventilation holes of the unit?

After checking the above items and fixing any problems, plug in the AC power cord again and turn on the system. If the issue persists, consult your nearest Sony dealer.

General

The system has entered standby mode.

- This is not a malfunction. The system enters standby mode automatically in about 15 minutes when there is no operation or audio signal output (page 24).

The clock or timer setting is canceled.

- The AC power cord is disconnected or a power failure occurred. Set the clock (page 9) and timer (page 23) again.

There is no sound.

- Adjust the volume.
- Check the connection of the optional equipment, if any (page 8).
- Turn on the connected equipment.

- Unplug the AC power cord, then plug in the AC power cord again and turn on the system.

There is severe hum or noise.

- Move the system away from sources of noise.
- Connect the system to a different wall outlet.
- Install a noise filter (commercially available) to the AC power cord.
- Turn off surrounding electrical equipment.

The timer does not function.

- Check the timer setting and set the correct time (page 23).
- Cancel the Sleep Timer function (page 23).

The remote control does not function.

- Remove the obstacles between the remote control and the unit.
- Move the remote control closer to the unit.
- Point the remote control at the unit's sensor.
- Replace the batteries (R6/size AA).
- Move the unit away from the fluorescent light.

There is acoustic feedback.

- Reduce the volume.

“CHILD LOCK” appears when you press any button on the unit.

- Set the Child Lock function to off (page 24).

Disc player

The disc tray does not open and “LOCKED” appears in the display panel.

- Consult your nearest Sony dealer or local authorized Sony service facility.

The disc tray does not close.

- Load the disc correctly.

The disc does not eject.

- You cannot eject the disc during CD-USB Synchronized Transfer or REC1 Transfer. Press ■ to cancel the transfer, then press ▲ on the unit to eject the disc.
- Consult your nearest Sony dealer.

Playback does not start.

- Wipe the disc clean (page 30).
- Reload the disc.
- Load a disc that this system can play back (page 25).
- Remove the disc and wipe away the moisture on the disc, then leave the system turned on for a few hours until the moisture evaporates.

The sound skips.

- Wipe the disc clean (page 30).
- Reload the disc.
- Move the unit to a place with no vibration (e.g., on top of a stable stand).

Playback does not start from the first track.

- Set the play mode to Normal Play (page 11).

The folder name, track name, file name and ID3 tag characters do not appear properly.

- The ID3 tag is not Version 1(1.0/1.1) or Version 2(2.2/2.3).
- The character codes that can be displayed by this system are numbers and alphabets only. Other characters that cannot be displayed appear as “_”.

USB device

Transferring results in an error.

- You are using an unsupported USB device. Check the information on the website about compatible USB devices (page 25).
- The USB device is not formatted correctly. Refer to the operating instructions of the USB device on how to format.

- Turn off the system and remove the USB device. If the USB device has a power switch, turn the USB device off and on again after removing it from the system. Then, perform the transfer again.
- If the transfer and erase operations are repeated multiple times, the file structure within the USB device becomes fragmented. Refer to the operating instructions supplied with the USB device on how to deal with this problem.
- The USB device was disconnected or the power was turned off during transfer. Delete the partially-transferred file, and perform the transfer again. If this does not fix the problem, the USB device may be broken. Refer to the operating instructions of the USB device on how to deal with this problem.

Audio files or folders on the USB device cannot be erased.

- Check if the USB device is write-protected.
- The USB device was disconnected or the power was turned off during the erase operation. Delete the partially-erased file. If this does not fix the problem, the USB device may be broken. Refer to the operating instructions of the USB device on how to deal with this problem.

There is no sound.

- The USB device is not connected correctly. Turn off the system and reconnect the USB device, then turn on the system.

There is noise, skipping, or distorted sound.

- You are using an unsupported USB device. Check the information on the website about compatible USB devices (page 25).
- Turn off the system and reconnect the USB device, then turn on the system.

- The music data itself contains noise, or the sound is distorted. Noise may have entered during the transfer process. Delete the file, and try transfer again.
- The bit rate used when encoding audio files was low. Send audio files with higher bit rate to the USB device.

“READING” is displayed for an extended time, or it takes a long time before playback starts.

- The reading process can take a long time in the following cases.
 - There are many folders or files on the USB device (page 11).
 - The file structure is extremely complex.
 - The memory capacity is excessive.
 - The internal memory is fragmented.

“OVER CURRENT” appears.

- A problem has been detected with the level of electrical current from the ψ port. Turn off the system and remove the USB device from the port. Make sure there is no problem with the USB device. If this display pattern persists, contact your nearest Sony dealer.

Erroneous display.

- The data stored in the USB device may have been corrupted, perform the transfer again.
- The character codes that can be displayed by this system are numbers and alphabets only. Other characters that cannot be displayed appear as “_”.

The USB device is not recognized.

- Turn off the system and reconnect the USB device, then turn on the system.
- Check the information on the website about compatible USB devices (page 25).
- The USB device does not work properly. Refer to the operating instructions of the USB device on how to deal with this problem.

Playback does not start.

- Turn off the system and reconnect the USB device, then turn on the system.
- Check the information on the website about compatible USB devices (page 25).

Playback does not start from the first file.

- Set the play mode to Normal Play (page 11).

Audio file cannot be played back.

- USB devices formatted with file systems other than FAT16 or FAT32 are unsupported.*
- A WMA audio file that is created in the WMA DRM, WMA Lossless, or WMA PRO format cannot be played back.
- An AAC audio file that is created in the AAC DRM or AAC Lossless format cannot be played back.
- AAC audio files encoded at 96 kHz cannot be played back.
- If multiple partitions exist on a USB device that is being used, files may not be played back.
- The system can play back to a depth of 8 folders only.
- Files that are encrypted or protected by passwords cannot be played back.
- Files with DRM (Digital Rights Management) copyright protection cannot be played back by this system.
- The MP3 PRO audio file can be played back as MP3 audio file.

* This system supports FAT16 and FAT32, but some USB devices may not support all of these FAT. For details, refer to the operating instructions of each USB device or contact the manufacturer.

Tuner

There is severe hum or noise, or stations cannot be received. (“ST” flashes in the display panel.)

- Connect the antenna properly.
- Change the antenna location and its orientation to obtain good reception.
- Connect a commercially available external antenna.
- Turn off surrounding electrical equipment.

Bluetooth device

Pairing cannot be performed.

- Move the *Bluetooth* device closer to the system.
- Pairing may not be possible if other *Bluetooth* devices are present around the system. In this case, turn off the other *Bluetooth* devices.
- Make sure the correct passkey was entered at the *Bluetooth* device.

The *Bluetooth* device cannot detect this unit, or “BT OFF” appears in the display panel.

- Set the *Bluetooth* signal to “BT ON” (page 20).

Connection is not possible.

- The *Bluetooth* device you attempted to connect does not support the A2DP profile, and cannot be connected with the system.
- Enable the *Bluetooth* function of the *Bluetooth* device.
- Establish a connection from the *Bluetooth* device.
- The pairing registration information has been erased. Perform the pairing operation again.
- Erase the pairing registration information of the *Bluetooth* device (page 19) and perform the pairing operation again (page 18).

The sound skips or fluctuates, or the connection is lost.

- The system and the *Bluetooth* device are too far apart.
- If there are obstacles between the system and your *Bluetooth* device, remove or avoid the obstacles.
- If there is equipment that generates electromagnetic radiation, such as a wireless LAN, other *Bluetooth* device, or a microwave oven nearby, move them away.

The sound of your *Bluetooth* device cannot be heard on this system.

- Increase the volume on your *Bluetooth* device first, then adjust the volume using VOLUME +/-.

There is severe hum, noise or distorted sound.

- If there are obstacles between the system and your *Bluetooth* device, remove or avoid the obstacles.
- If there is equipment that generates electromagnetic radiation, such as a wireless LAN, other *Bluetooth* device, or a microwave oven nearby, move them away.
- Turn down the volume of the connected *Bluetooth* device.

To reset the system

If the system still does not operate properly, reset the system to factory default settings. Use the buttons on the unit to perform this operation.

- 1 Unplug and plug the AC power cord back in.
- 2 Press **I/⏻** to turn on the system.
- 3 Hold down **■** and ENTER for about 3 seconds. “RESET” appears in the display panel. All user-configured settings, such as preset radio stations, timers, and the clock are reset to factory default setting.

Messages

One of the following messages may appear or flash in the display panel during operation.

CANNOT PLAY

A disc that cannot be played back was inserted.

DEVICE ERROR

The USB device could not be recognized or an unknown device is connected.

DEVICE FULL

The memory of the USB device is full.

FATAL ERROR

The USB device was removed during transfer or erase operation, and may have been damaged.

FOLDER FULL

You cannot transfer onto the USB device because the number of folder has reached its maximum.

FULL

You tried to program more than 25 steps.

NO DISC

There is no disc on the disc tray.

NO STEP

All of the programmed steps have been erased.

NO SUPPORT

An unsupported USB device is connected, or the USB device is connected through a USB hub.

NO TRACK

No playable file is loaded in the system.

NoDEVICE

No USB device is connected.

NoMEMORY

The memory selected for playback or transfer has no memory media inserted in the USB device.

NOT USE

You tried to perform a specific operation under conditions where that operation is prohibited.

PROTECT

The USB device is write-protected.

PUSH STOP

You tried to perform an operation that can be performed only when the playback is stopped.

READING

The system is reading information of the disc or USB device. Some operations are not available.

REC ERROR

The transfer did not start, stopped partway, or otherwise could not be performed.

TIME NG

The on time and off time of Play Timer are the same.

TRACK FULL

You cannot transfer onto the USB device because the number of file has reached its maximum.

Precautions

When carrying the unit

Perform the following procedure to protect the disc mechanism. Use the buttons on the unit to perform this operation.

1 Press **I/⏻** to turn on the system.

2 Press **CD**.

3 Remove the disc.

Press **▲** to open and close the disc tray. Wait until “NO DISC” appears in the display panel.

4 Unplug the AC power cord.

Notes on discs

- Before playing, wipe the disc with a cleaning cloth from the center outward to the edge.

- Do not clean discs with solvents, such as benzene, thinner, or commercially available cleaners or anti-static spray intended for vinyl LPs.
- Do not expose discs to direct sunlight or heat sources such as hot air ducts, nor leave it in a car parked in direct sunlight.

On safety

- Completely disconnect the AC power cord (mains lead) from the wall outlet (mains) if it is not going to be used for an extended period of time. When unplugging the unit, always grip the plug. Never pull the cord itself.
- Should any solid object or liquid get into the system, unplug the system, and have it checked by qualified personnel before operating it again.
- AC power cord must be changed only at the qualified service shop.

On placement

- Do not place the system in an inclined position or in locations that are extremely hot, cold, dusty, dirty, or humid or lacking adequate ventilation, or subject to vibration, direct sunlight or a bright light.
- Be careful when placing the system on surfaces that have been specially treated (for example, wax, oil, polish) as staining or discoloration of the surface may result.
- If the system is brought directly from a cold to a warm location or is placed in a very damp room, moisture may condense on the lens inside the unit, and cause the system to malfunction. In this situation, remove the disc, and leave the system turned on for about an hour until the moisture evaporates.

On heat buildup

- Heat buildup on the unit during operation is normal and is not a cause for alarm.
- Do not touch the cabinet if it has been used continuously at a high volume because the cabinet may have become hot.
- Do not obstruct the ventilation holes.

On the speaker system

The built-in speaker system is not magnetically shielded, and the picture on nearby TV sets may become magnetically distorted. In this situation, turn off the TV, wait 15 to 30 minutes, and turn it back on. If there is no improvement, move the system far away from the TV.

Cleaning the cabinet

Clean this system with a soft cloth slightly moistened with a mild detergent solution. Do not use any type of abrasive pad, scouring powder, or solvent, such as thinner, benzene, or alcohol.

On Bluetooth Communication

- *Bluetooth* devices should be used within approximately 10 meters (unobstructed distance) of each other. The effective communication range may become shorter under the following conditions.
 - When a person, metal object, wall or other obstruction is between the devices with a *Bluetooth* connection
 - Locations where a wireless LAN is installed
 - Around microwave ovens that are in use
 - Locations where other electromagnetic waves occur
- *Bluetooth* devices and wireless LAN (IEEE 802.11b/g) use the same frequency band (2.4 GHz). When using your *Bluetooth* device near a device with wireless LAN capability, electromagnetic interference may occur. This could result in lower data transfer rates, noise, or inability to connect. If this happens, try the following remedies:
 - Try connecting this system and *Bluetooth* device when you are at least 10 meters away from the wireless LAN equipment.
 - Turn off the power to the wireless LAN equipment when using your *Bluetooth* device within 10 meters.
- The radio waves broadcast by this system may interfere with the operation of some medical devices. Since this interference may result in malfunction, always turn off the power on this system and *Bluetooth* device in the following locations:
 - In hospitals, on trains, in airplanes, at gas stations, and any place where flammable gases may be present
 - Near automatic doors or fire alarms
- This system supports security functions that comply with the *Bluetooth* specification as a means of ensuring security during communication using *Bluetooth* technology. However, this security may be insufficient depending on the setting contents and other factors, so always be careful when performing communication using *Bluetooth* technology.
- Sony cannot be held liable in any way for damages or other loss resulting from information leaks during communication using *Bluetooth* technology.

- *Bluetooth* communication is not necessarily guaranteed with all *Bluetooth* devices that have the same profile as this system.
- *Bluetooth* devices connected with this system must comply with the *Bluetooth* specification prescribed by the Bluetooth SIG, Inc., and must be certified to comply. However, even when a device complies with the *Bluetooth* specification, there may be cases where the characteristics or specifications of the *Bluetooth* device make it impossible to connect, or may result in different control methods, display or operation.
- Noise may occur or the audio may cut off depending on the *Bluetooth* device connected with this system, the communications environment, or surrounding conditions.

Specifications

Amplifier section

The following are measured at

Chilean and Bolivian models:

AC 220 V – 240 V, 50 Hz

Other models:

AC 120 V – 240 V, 50/60 Hz

Power output (rated)

Left/Right Channel: 120 W + 120 W
(at 2 ohms, 1 kHz, 1% THD)

RMS output power (reference)

Left/Right Channel: 180 W + 180 W
(per channel at 2 ohms, 1 kHz)

Subwoofer: 360 W (at 4 ohms, 100 Hz)

Inputs

AUDIO IN L/R

Voltage 2 V, impedance 47 kilohms

ψ (USB) port

Type A

USB section

Supported bit rate

WMA:

48 kbps – 192 kbps, VBR, CBR

AAC:

48 kbps – 320 kbps, VBR, CBR

Sampling frequencies

WMA: 44.1 kHz

AAC: 44.1 kHz

Supported USB device

Mass Storage Class

Maximum current

500 mA

Disc/USB section

Supported bit rate

MPEG1 Layer-3:

32 kbps – 320 kbps, VBR

MPEG2 Layer-3:

8 kbps – 160 kbps, VBR

MPEG1 Layer-2:

32 kbps – 384 kbps, VBR

Sampling frequencies

MPEG1 Layer-3:

32 kHz/44.1 kHz/48 kHz

MPEG2 Layer-3:

16 kHz/22.05 kHz/24 kHz

MPEG1 Layer-2:

32 kHz/44.1 kHz/48 kHz

Disc player section

System

Compact disc and digital audio system

Laser Diode Properties

Emission Duration: Continuous

Laser Output*: Less than 44.6 μW

* This output is the value measurement at a distance of 200 mm from the objective lens surface on the Optical Pick-up Block with 7 mm aperture.

Frequency response

20 Hz – 20 kHz

Signal-to-noise ratio

More than 90 dB

Dynamic range

More than 88 dB

FM tuner section

System

PLL quartz-locked digital synthesizer

Tuning range

87.5 MHz – 108.0 MHz (50 kHz step)

Antenna

FM wire antenna

Bluetooth section

Communication system

Bluetooth Standard version 3.1

Output

Bluetooth Standard Power Class 2

Maximum communication range

Line of sight approx. 10 m¹⁾

Frequency band

2.4 GHz band (2.4000 GHz –
2.4835 GHz)

Modulation method

FHSS (Freq Hopping Spread
Spectrum)

Compatible *Bluetooth* profiles²⁾

A2DP (Advanced Audio Distribution
Profile)

AVRCP 1.3 (Audio Video Remote
Control Profile)

SPP (Serial Port Profile)

Supported codecs

SBC (Sub Band Codec)

AAC (Advanced Audio Coding)

¹⁾The actual range will vary depending on factors such as obstacles between devices, magnetic fields around a microwave oven, static electricity, reception sensitivity, antenna's performance, operating system, software application, etc.

²⁾*Bluetooth* standard profiles indicate the purpose of *Bluetooth* communication between devices.

Speaker section

Speaker system

3-way, Sound Pressure Horn

Speaker unit

Tweeter L/R: 40 mm, cone type

Mid L/R: 80 mm, cone type

Woofers: 200 mm, cone type

Rated impedance

Tweeter L/R: 2 ohms

Mid L/R: 2 ohms

Woofers: 4 ohms

General

Power requirements

Chilean and Bolivian models:

AC 220 V – 240 V, 50 Hz

Other models:

AC 120 V – 240 V, 50/60 Hz

Power consumption

120 W

Dimensions (w/h/d) (Approx.)

280 mm × 786 mm ×

280 mm

Mass (Approx.)

13.0 kg

Supplied accessories

Remote control (1)

R6 (Size AA) batteries (2)

FM wire antenna (1)

AC power cord (1)

Design and specifications are subject to change without notice.

<http://www.sony.net/>



©2014 Sony Corporation Printed in Malaysia

* 4 5 3 4 7 1 7 1 2 * (2)