

Noise Canceling headphones

Operating Instructions

MDR-NC50

© 2004 Sony Corporation Printed in Korea

English

WARNING

To prevent fire or shock hazard, do not expose the unit to rain or moisture.

To avoid electrical shock, do not open the cabinet. Refer servicing to qualified personnel only.

You are cautioned that any changes or modifications not expressly approved in this manual could void your authority to operate this equipment.

Owner's Record

The model number is located on the left inner side of the headband. The serial number is located on the right inner side of the headband.

Record these numbers in the spaces provided below. Refer to them whenever you call upon your Sony dealer regarding this product.

Model No. MDR-NC50

Serial No. _____

Features

- Noise-canceling headphones reduce ambient noise, providing a quieter environment for enhanced listening enjoyment.
The noise-canceling circuit achieves this with a phase-cancellation process, providing a noise reduction of over 14 dB at 300 Hz.
- Slim, folding design for easy portability.
- Neodymium magnets for powerful sound.
- Passive operation when noise-canceling circuit is not activated.
- Built-in monitor function to hear surrounding sound without taking off the headphones.
- Supplied plug adaptor for easy connectivity to stereo or dual jack of in-flight music services.

Precautions

The headphones contain a noise canceling circuit.

What is noise canceling?

The noise canceling circuit actually senses outside noise with built-in microphones and sends an equal-but-opposite canceling signal to the headphones.

- The noise canceling effect may not be pronounced in a very quiet environment, or some noise may be heard. In such a case, turn the POWER switch off.
- The noise canceling effect may vary depending on how you wear the headphones.
- When you turn the POWER switch on, the operation sound of the noise canceling may be noticeable. This is not a malfunction.
- The noise canceling function is only effective for noise in the low frequency band. Although noise is reduced, it is not canceled completely.
- When you use the headphones in a train or a car, noise may occur depending on street conditions. In such a case, turn the POWER switch off.
- You can use the headphones without turning on the power. In this case, the noise canceling function is not active, and the headphones operate as passive headphones.
- Howling may occur if you do not wear the headphones correctly.
- Mobile phones may cause noise. Keep the headphones away from mobile phones.

Notes on usage

- Clean the headphones with a soft dry cloth.
- Do not leave the plug dirty otherwise the sound may be distorted.
- Be sure to consult a Sony dealer when the earpads become dirty or damaged, or when the headphones require repair work.
- Do not leave the stereo headphones in a location subject to direct sunlight, heat or moisture.

Notes on headphones

Preventing hearing damage

Avoid using headphones at high volume. Hearing experts advise against continuous, loud and extended play. If you experience a ringing in your ears, reduce the volume or discontinue use.

Do not listen with the headphones while driving or cycling

As your headphones reduce outside sounds, it may cause traffic accident. Also avoid using them where hearing must not be impaired, for example, at a railroad crossing, a site of construction, etc.

Troubleshooting

No sound

- Check the connection of the headphones and the AV equipment.
- Check that the connected AV equipment is turned on.
- Turn up the volume of the connected AV equipment.

Muffled sound

- Turn down the volume of the connected AV equipment.
- Replace the battery.

Power does not turn on

- Check if the battery has expired (the POWER indicator dims).
- Replace the battery with a new one.

Howling

- Make sure you are wearing the headphones correctly.

Specifications

General

Type	Dynamic, closed
Driver units	40 mm, dome type
Power handling capacity	100 mW
Impedance	40 Ω at 1 kHz (when the power is on) 100 Ω at 1 kHz (when the power is off)
Sensitivity	102 dB/mW (when the power is on) 100 dB/mW (when the power is off)
Frequency response	14 – 22,000 Hz
Frequency range of active noise attenuation	40 – 1,500 Hz, more than 14 dB at 300 Hz
Power source	DC 1.5 V, 1 × R03 (size AAA) battery
Mass	Approx. 290 g (11 oz) including battery

Supplied accessories

Connecting cord (0.5 m, gold-plated stereo mini plug (1) and 1.5 m, gold plated L type stereo mini plug (1)), R03 (size AAA) dry battery (1), Carrying case (1), Plug adaptor for in-flight use* (single/dual)(1), Gold-plated unimatch plug adaptor (stereo phone plug ↔ stereo mini jack)(1), Operating Instructions (1)

* May not be compatible with some in-flight music services.

Design and specifications are subject to change without notice.

Installing a battery

- 1 Open the right housing, as illustrated.

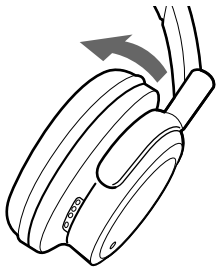

- 2 Open the lid of the battery box of the headphone to insert one size AAA battery.

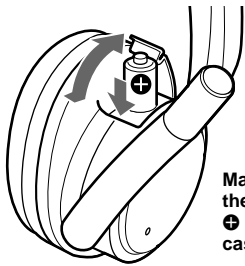

Match the **+** on the battery to the **+** in the battery case.

- 3 Close the lid.

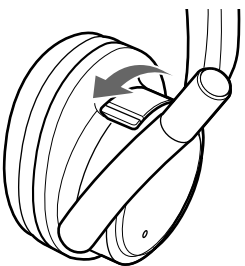

Battery life

Battery	Approx. hours*1
Sony alkaline LR03/AM-4 (N) (size AAA) battery	30 hours*2
Sony manganese R03/UM-4 (NU) (size AAA) battery	15 hours*2

*1 1 kHz, 1 mW + 1 mW input

*2 Time stated above may vary, depending on the temperature or conditions of use.

When to replace the battery

Replace the battery with a new one when the POWER indicator dims. The noise canceling feature may not work correctly if battery power is low.

Listening to music

- 1 Connect the headphones to the AV equipment.

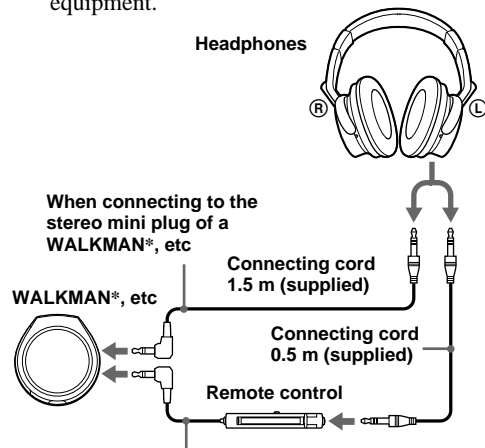

When connecting to the stereo mini jack of the remote control's jack supplied with a WALKMAN*, etc

* "WALKMAN" is a registered trademark of Sony Corporation to represent Headphone Stereo products.

- 2 Turn on the power on the right side of the headphones.

The POWER indicator lights in red. When the power is turned on, ambient noise is reduced, and you can listen to music more clearly at a lower volume.

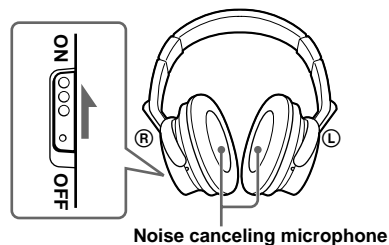

- 3 Put on the headphones so that the ear pads cover your ears.



- 4 Turn on the power of the AV equipment.

Hearing environmental sound for safety.

Playback is muted while the MONITOR switch is pushed so you can hear the surrounding environment.

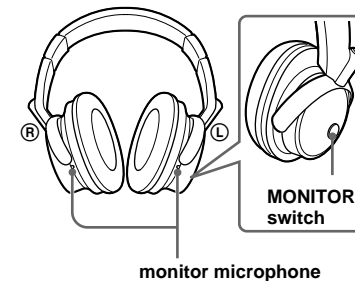

Note

The environmental sound might not be heard if the microphone is covered with your fingers.

Notes on using on the airplane

- The supplied plug adaptor can be connected to dual and stereo mini jacks.

for dual jacks

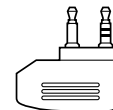

for stereo mini jacks

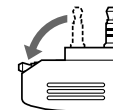

- Do not use the headphones when use of electronic equipment is prohibited or when use of personal headphones for in-flight music services is prohibited.

If you have any questions or problems concerning the system that are not covered in this manual, please consult the nearest Sony dealer.

After listening to music

Turn off the power of the headphones.

Folding the headphones

Folding

The housings rotate to make them flat for easy storage in the carrying case (supplied), or in a seat pocket. Restore to their usual position before using.

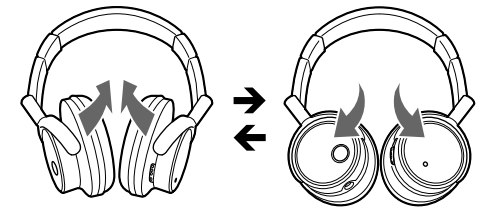

Putting the headphones in the carrying case

Fold the headphones before putting them in the carrying case.

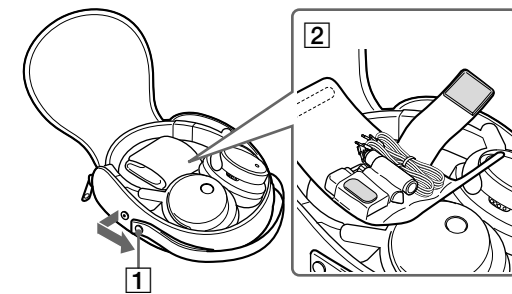

- 1 You can carry the carrying case by hand by undoing the button and pulling out the attached belt.
- 2 The supplied cord, unmatch plugs or reserve batteries can also be stored.